

CERTIFIED LAND CORNER RESTORATION

U.S. Public Land Survey Monument Record

State of Wisconsin

County of Oneida

ss.

I William Innich, do hereby certify that on the 15 day of July, 1982, I found evidence of the Northwest corner of Section 24 Township 36 North, Range 8 East, Fourth Principal Meridian, as described hereon; and that from this evidence I established a new monument and accessories as described hereon to perpetuate the original location of this corner.

Description of original monument and accessories and subsequent restorations:

1863 William E. Daugherty Government Surveyor Set Post at 80.00 to Sections 23-24-13-14 Bts. Spruce 7 N 59 W 15lk. Aspen 10 S 54 E 12 lk.

1901 Vaughan found corner in center of road

1906 Dorr found corner Bts. Y. Pine S 7 1/2 W 61 1/2 lk. Spruce 10 N 36 E 65lk.

1950 Wincentzen measured from N.W. corner of N 1/4 corner 2646.93

1957 Highway Dept shows corner 60' from centerline S.T.H. 17

No monument was found, set corner from highway map and then checked ditances to adjacent corners .

(see reverse side)



Description of monument and accessories I established to perpetuate the location of this corner:

Set Oneida County Monument stamped as shown Made new witness

J. Pine 6 N 60 40' W 27.15' dist. to P.K. in blaze Power pole # 3608-14R 12 N 69 W 30.23 dist. to P.K. in North side Centerline State Trunk Highway 17 East 60.80'

This is a copy, original is apparently lost or misplaced mqr 6/6/88

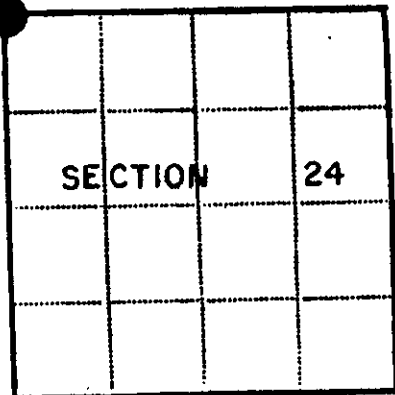

● - Corner monument restored  
□ -

Resident witnesses \_\_\_\_\_

Dated at Rhinelander Wisconsin, this 15 day of December, 1982

Signature *William Innich* Title Registered Land Surveyor  
(County Surveyor, Registered Land Surveyor, or other duly authorized official)

Surveyors Registration No. 1383

Office of \_\_\_\_\_ County of \_\_\_\_\_

I hereby certify that the within instrument was filed in this office for record on the \_\_\_\_\_ day of \_\_\_\_\_, 19\_\_\_\_, and was filed in Book, No. \_\_\_\_\_ Page No. \_\_\_\_\_ of County Records.

Signature \_\_\_\_\_ Title \_\_\_\_\_

Township 36 North, Range 8 East, Section 24, Index No. \_\_\_\_\_, Page No. \_\_\_\_\_

3608/40000

2121

Stock No. 26273

1/4 COR

1323.16

FOUND 1/16 CORNER 2.78' NORTH

2651.88

1328.72

60.80' ±

STATE 60' ±

1/4 COR.

2650.15

2646.93' F.R.W.

5278.42

S.W. COR.

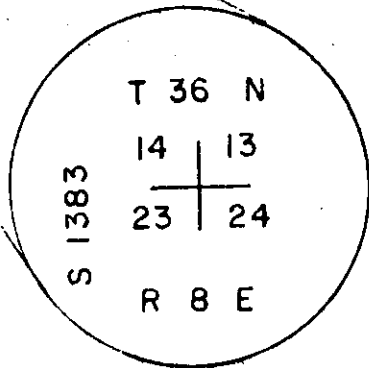

REGISTER OF DEEDS OFFICE  
ONEIDA COUNTY, WIS.

**FILED**  
JUN 8 1990

At 8:40 O'Clock  
DORIS VERAGE KUEHN  
REGISTER OF DEEDS