

# U. S. PUBLIC LAND SURVEY MONUMENT RECORD

**INSTRUCTIONS:** This record shall show the location of the corner and shall include all of the following nine elements (a through i).

- (a) Identify the corner by reference to the U.S. public land survey system.  
 ○ = Corner monument restored.

**MEANDER CORNER BETWEEN SECTIONS 14 and 23, right bank of the Wisconsin River**  
 TOWNSHIP 36 NORTH, RANGE 8 EAST  
 FOURTH PRINCIPAL MERIDIAN  
 ONEIDA COUNTY, WISCONSIN

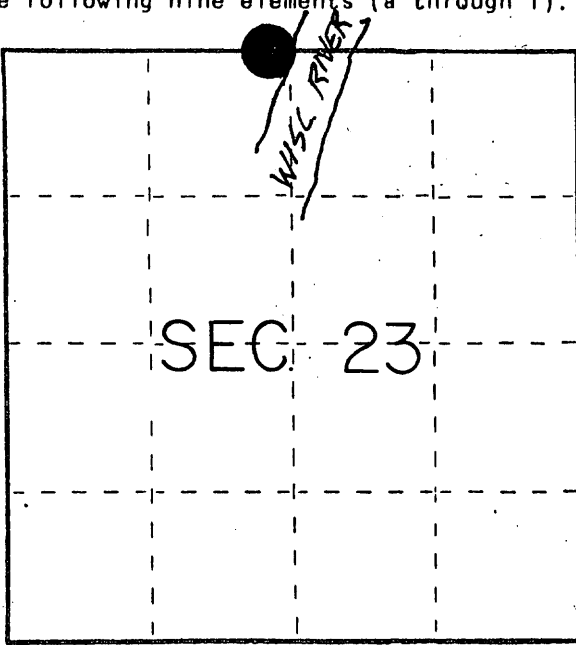

1863 Government survey W. Daugherty  
 East random bet 14 & 23,  $70^{\circ} 45'$  E var.  
 80.00 intersect N-S line 26 lk South  
 West correct 40.00 right bank Wis. R.  
 set M.C. W Pine 20 N25W 46 lk

D.H. Vaughn 1905 ran from M.C. bet 14 and 23 West in 2 feet of snow 39.31 chains. Found original bt down did not make new b.t.

only surveys of record

- (b) Describe any record evidence, monument evidence, occupational evidence, testimonial evidence or any other material evidence you considered, and whether the monument was found or placed.

Found 1" x 48" iron pipe situated on a rock line and fence line that run West from the corner.

Also found 1" x 48" iron pipe 394 feet west of corner, recorded as 400'

Iron pipe is best available evidence of corner position, replace iron pipe with  $\frac{3}{16}$  inch long Aluminum Capped Oneida County Monument stamped as shown.

- (c) In the plan view drawing below, provide reference ties to at least 4 witness monuments, or, if the location is within a municipality, to at least 2 witness monuments. (Witness monuments shall be made of concrete, natural stone, iron or other equally durable material.) Describe witness monuments.

- (d) Show a plan view drawing depicting the relevant monuments and reference ties which is sufficient in detail to enable accurate relocation of the corner monument if the corner monument is disturbed. Indicate north.

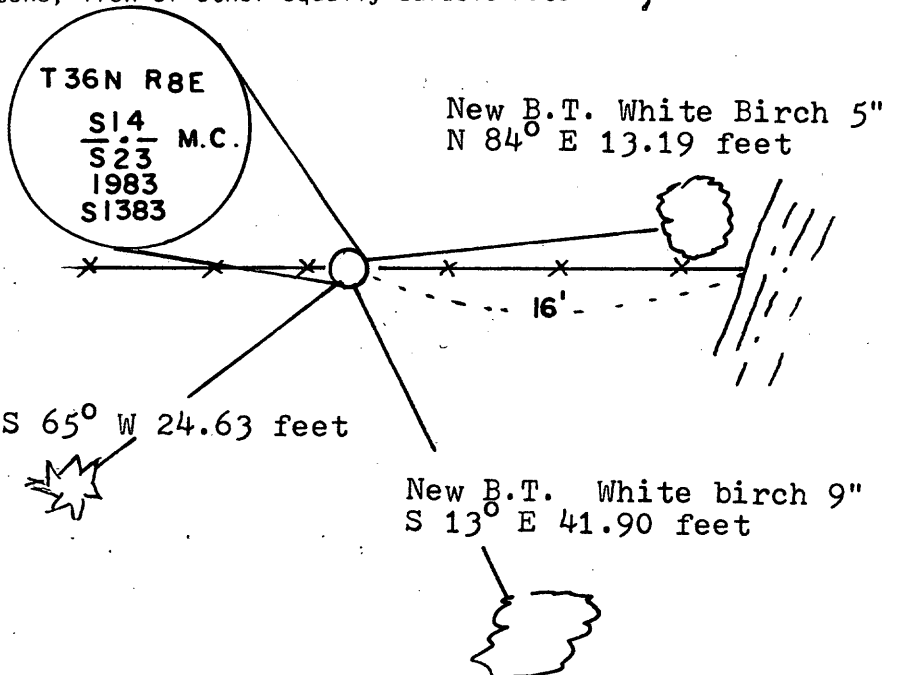

See Genisot and Associate Inc.  
 Map No. 7446

Bearings mag. New B.T. Balsam 4" S  $65^{\circ}$  W 24.63 feet  
 Distances to spike in side of tree.

Compared with all record data and accepted as correct.

Robert H. Vniak 18 JAN 84  
 Oneida County Surveyor date

MC  
 31008140021

N-19

(e) Describe any material discrepancy between the location of the corner as restored or reestablished and the location of that corner as previously restored or reestablished by distance and direction. Show the discrepancy on the plan view drawing under (d), above. Show the distances between the corner as previously restored or reestablished and (1) the corner as restored or reestablished, and (2) to at least 2 of the witness monuments shown on the drawing in (d), above.

measure 2543.89"  
s 15 s14 s14 M.C.  
s 22 s23 Vaughn 1905 39.31 ch. (2594.5') s23

(f) Was the corner restored through acceptance of (1) an obliterated evidence location, or, (2) a found perpetuated location?

A found and perpetuated location

(g&h) Was the corner reestablished through lost corner proportionate methods? If so, show the method, including the directions and distances to other public land survey corners used as evidence or used for proportioning in determining the corner location?

no

REGISTERS OFFICE }  
Oneida County, Wis. }

Received for Record the 18<sup>th</sup> day of  
January A.D. 1984 at  
10<sup>00</sup> o'clock A M. and recorded in

Vol. \_\_\_\_\_ on page \_\_\_\_\_  
Loris Verage Kuehn  
Register

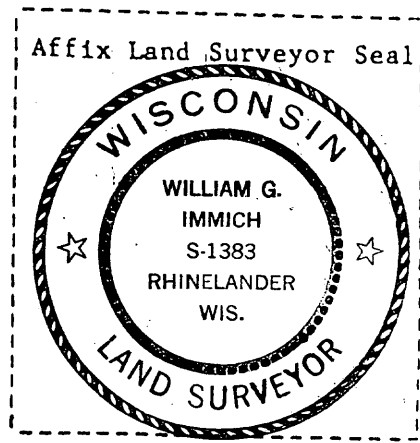

(1) William Immich  
(Type or print name) certify that the corner location shown on this record was determined by me or under my direction and control and that this U.S. Public Land Survey Monument Record is correct and complete to the best of my knowledge and belief.

William Immich  
Signature

Oct 18, 1983  
Date