

# U.S. PUBLIC LAND SURVEY MONUMENT RECORD

**Note:** This form is intended and designed to fulfill all requirements of Wisconsin Administrative Code, Chapter A-E 5.02, U.S. Public Land Survey Monument Record (3) (a) (b) (c) (d) (e) (f) (g) (h) (i). An additional sheet may be added if necessary to conform with said requirements.

(a) Corner location: Township 36 North  
 Range 8 ~~East~~ ~~West~~ East  
 Town/City/Village Crescent  
 County Oneida

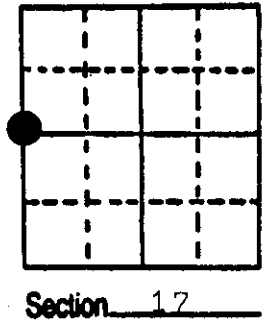

(b) (f) (g) (h) Description of monument found at this corner and if it was accepted, state all evidence (material, testimonial, occupational, plats, records, other monuments) used as a basis for accepting. If not accepted or if nothing was found, state evidence used as basis for establishing location. If reestablished through lost corner proportionate methods, indicate all monuments, distances and directions used to establish.

- 1863 Original corner by William Daugherty. North between 17 and 18 40.00 set  $\frac{1}{4}$  post BT's Hem 10 East 16 lks, Hem 10 S 49 W 5 lks.
- 1939 GLO found BT stumps. Set 6" Concrete Monument with brass cap. New BT's Poplar 8" N 62 $\frac{1}{2}$  E 15 lks., Sugar Maple 16", S 36 $\frac{1}{4}$  W 65 lks.
- 1988 I found the concrete monument and Sugar Maple BT. Made new BT's as shown below.

(c) (d) (e) Plan view of corner with ties to at least 4 witness monuments. If in disagreement with previously established corner, show the distances between the two corners and also indicate the ties to the disputed corner.

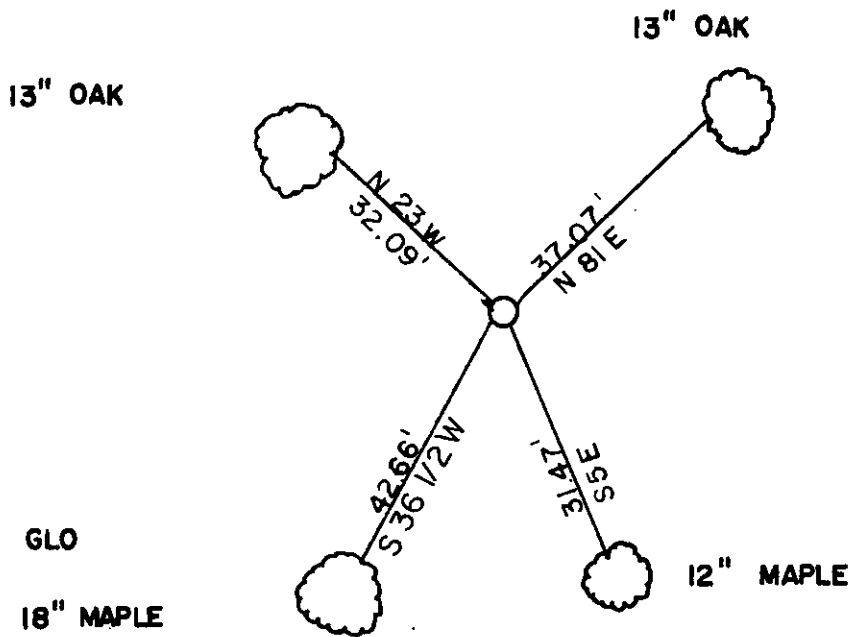

- Magnetic Bearings Taken With Handheld Compass
- Distance to 6" Nail in Side of tree
- No Scale



(i) I, William E. Bandow  
 (type or print name) certify that the corner location on this record was determined by me or under my direction and control and that this U.S. Public Land Survey Monument Record is correct and complete to the best of my knowledge and belief.

William E. Bandow                      2-2-88  
 Signature                                      Date



Index No. L-5