

# U.S. PUBLIC LAND SURVEY MONUMENT RECORD

Note: This form is intended and designed to fulfill all requirements of Wisconsin Administrative Code, Chapter A-E 7.08 U.S. Public Land Survey Monument Record (3)(a)(b)(c)(d)(e)(f)(g)(h)(i). An additional sheet may be added if necessary to conform with said requirements.

(a) Corner location: Township 36 North  
 Range 08 (East) West

Town/City/Village CRESCENT  
 County ONEIDA

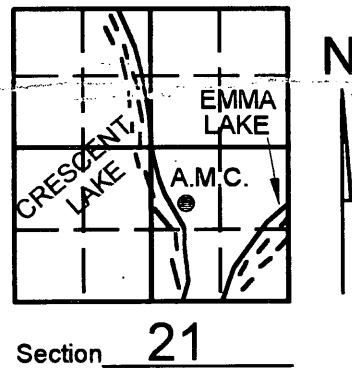

(b) (f) (g) (h) Description of monument found at this corner and if it was accepted, state all evidence (material, testimonial, occupational, plats, records, other monuments) used as a basis for accepting. If not accepted or if nothing was found, state evidence used as basis for establishing location. If reestablished through lost corner proportionate methods, indicate all monuments, distances and directions used to establish. Indicate type of monument found or set and sign post.

- 1939 - G.L.O. SET CONCRETE MONUMENT 24" LONG, 6" DIAMETER, 18" INTO THE GROUND FOR AN AUXILLARY MEANDER CORNER WITH BRASS TABLET, 3 1/2" DIAMETER, 3" STEM AND STAMPED G.L.O. MADE THE FOLLOWING B.T.s: 4" TAMARACK, S 59°E, 32 LINKS, 4" TAMARACK, N 13°E, 54 LINKS.
- 1983 - JAMES KASSON FOUND 2" BRASS, CAPPED MONUMENT SET IN CONCRETE AND SHOWS A.P. 10 BEARING N 19°46'00" E, 290.09'.
- 2000 - KEVIN BIXBY FOUND BRASS CAP FOR A.M.C. ON THE EAST SIDE OF CRESCENT LAKE AND WITNESSED AS SHOWN BELOW.

(c) (d) (e) Plan view of corner with ties to at least 4 witness monuments. If in disagreement with previously established corner, show the distances between the two corners and also indicate the ties to the disputed corner.

NOTE: BEARINGS AND DISTANCES MEASURED WITH TOTAL STATION TO 60 PENNY SPIKES SET IN BASE OF TREES. NO SCALE. SET WHITE PLASTIC POST 1.00 FOOT NORTH. A.P. 10 BEARS N 19°21'14" E, 289.74'.

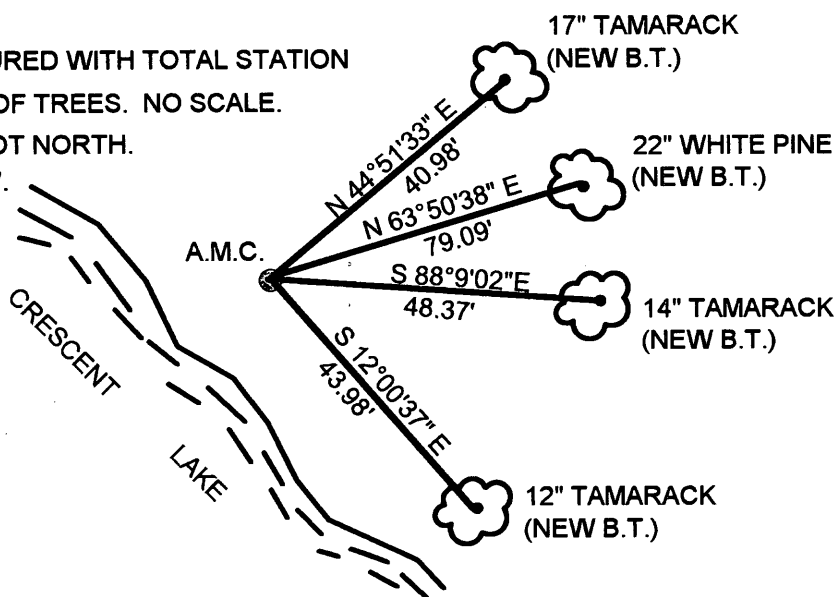

(i) I, KEVIN P. BIXBY

(type or print name) certify that the corner location on this record was determined by me or under my direction and control and that this U.S. Public Land Survey Monument Record is correct and complete to the best of my knowledge and belief.

Kevin P. Bixby Signature 02/04/00 Date



Stamp  
 3608213228

Index No. P 9 11-12

REGISTER OF DEEDS OFFICE  
ONEIDA COUNTY, WIS.

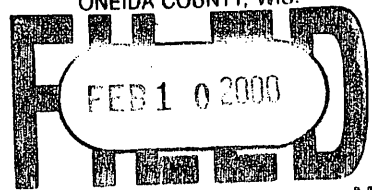

At \_\_\_\_\_ O'Clock \_\_\_\_\_ M  
THOMAS H. LEIGHTON  
REGISTER OF DEEDS