

05
Nov 84

U. S. PUBLIC LAND SURVEY MONUMENT RECORD

INSTRUCTIONS: This record shall show the location of the corner and shall include all of the following nine elements (a through i).

(a) Identify the corner by reference to the U.S. public land survey system.

○ = Corner monument restored.

W 1/4 SEC. 30, TOWNSHIP 36 NORTH, RANGE 9 EAST, ONEIDA COUNTY, WIS

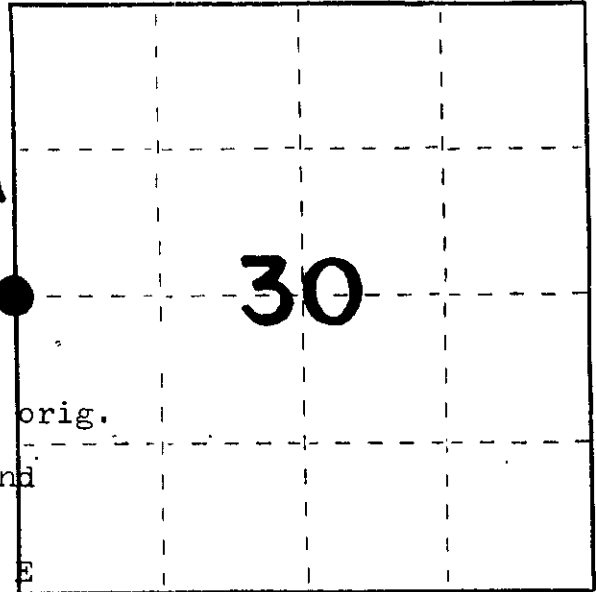

-1859 Hiram Fellows established orig. cor. B.T.s W. Pine 8 S 18 W 14 lks.; W Pine 8 N 26 E 11lks.

-1894 B.F. Dorr recovered corner

-1915 D.H. Vaughan recovered Dorr's post and orig. B.T.s. He set a 2"x30" iron pipe with 1 1/2"x36 iron pipe references 25' east and west of corner.

-N. J. Loftus recovered corner and snags of orig. B.T.s. Made new B.T.s W Pine 12 S 14 E 33lks.; W Pine 12 S 63 W 12 1/2 lks.

(b) Describe any record evidence, monument evidence, occupational evidence, testimonial evidence or any other material evidence you considered, and whether the monument was found or placed.

-At this corner I found the 2" iron pipe, the 2 reference monuments laying in the swamp at 25' east & west of corner, the remains of the orig. B.T.s and Loftus B.T.s and made the witnesses as shown below.

(c) In the plan view drawing below, provide reference ties to at least 4 witness monuments, or, if the location is within a municipality, to at least 2 witness monuments. (Witness monuments shall be made of concrete, natural stone, iron or other equally durable material.) Describe witness monuments.

(d) Show a plan view drawing depicting the relevant monuments and reference ties which is sufficient in detail to enable accurate relocation of the corner monument if the corner monument is disturbed. Indicate north.



- MAGNETIC BEARINGS WITH HAND HELD COMPASS
- MEASURED TO 6" NAIL IN APPROX. CENTER OF TREE

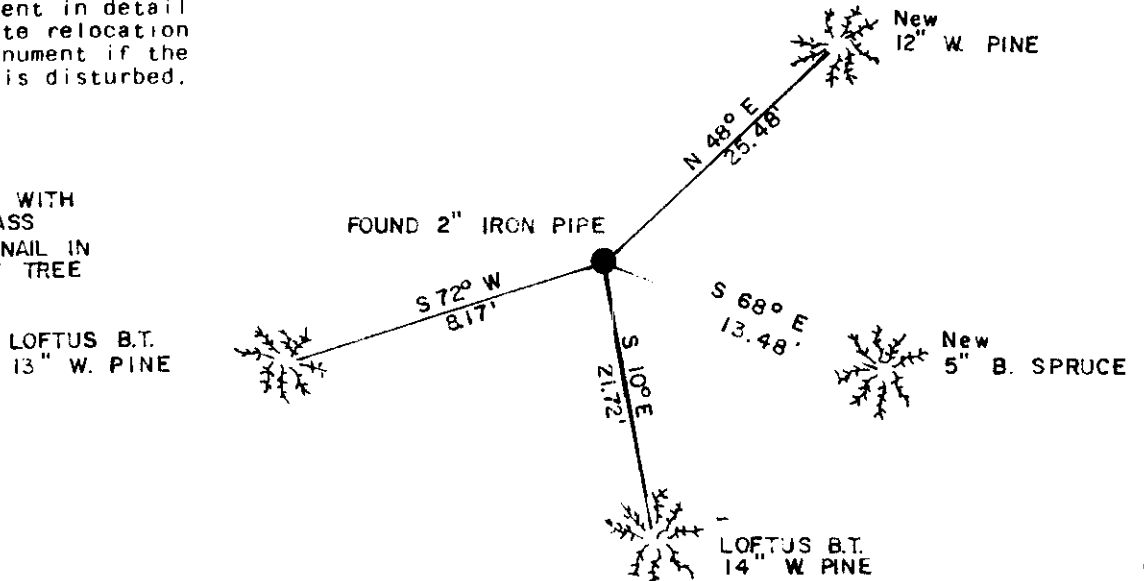

3608252000

1-1

(e) Describe any material discrepancy between the location of the corner as restored or reestablished and the location of that corner as previously restored or reestablished by distance and direction. Show the discrepancy on the plan view drawing under (d), above. Show the distances between the corner as previously restored or reestablished and (1) the corner as restored or reestablished, and (2) to at least 2 of the witness monuments shown on the drawing in (d), above.

none found

(f) Was the corner restored through acceptance of (1) an obliterated evidence location, or, (2) a found perpetuated location?

a found perpetuated location

(g&h) Was the corner reestablished through lost corner proportionate methods? If so, show the method, including the directions and distances to other public land survey corners used as evidence or used for proportioning in determining the corner location?

n/a

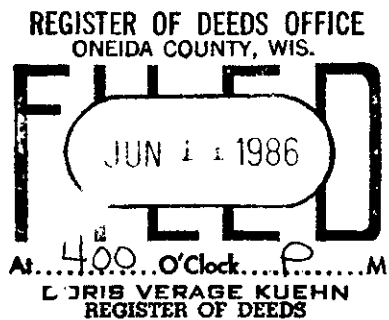

(1) I, MICHAEL J. ROMPORTL
(type or print name) certify that the corner location shown on this record was determined by me or under my direction and control and that this U.S. Public Land Survey Monument Record is correct and complete to the best of my knowledge and belief.

Michael J. Romportl October 24, 1984
Signature Date
GENISOT & ASSOCIATES, INC
1512 N. EAGLE ST.
RHINELANDER, WIS

