

# U.S. PUBLIC LAND SURVEY MONUMENT RECORD

Note: This form is intended and designed to fulfill all requirements of Wisconsin Administrative Code, Chapter A-E 7.08 U.S. Public Land Survey Monument Record (3) (a) (b) (c) (d) (e) (f) (g) (h) (i). An additional sheet may be added if necessary to conform with said requirements.

(a) Corner location: Township 36 North

Range 8 East

Town Crescent

County Oneida

REGISTER OF DEEDS OFFICE  
ONEIDA COUNTY, WIS.  
**FILED**  
JUN 11 1990  
At \_\_\_\_\_ O'Clock \_\_\_\_\_ M  
**THOMAS H. LEIGHTON**  
REGISTER OF DEEDS

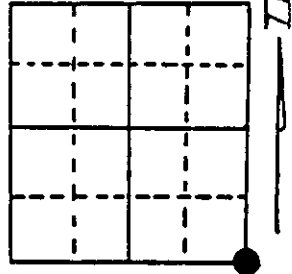

Section 27

(b) (f) (g) (h) Description of monument found at this corner and if it was accepted, state all evidence (material, testimonial, occupational, plats, records, other monuments) used as a basis for accepting. If not accepted or if nothing was found, state evidence used as basis for establishing location. If reestablished through lost corner proportionate methods, indicate all monuments, distances and directions used to establish. Indicate type of monument found or set and sign post.

July 1863, Orig. cor. estab. by William E. Daugherty North between 34 & 35.... 80.00 set post corner to Sections 26, 27, 34 & 35, B.T.s Pine 10 S 12 W 9 & Spruce 7 N 22 E 61

June 1937, V.M. Maine Sec. Cor. common to Sec's. 26, 27, 34 & 35 in ditch of road. Pointed out to me by Frank Hagen as being location of Orig. Cor. B.T.s destroyed. Set new Cedar Stk. Marked B.T.s Y.P. 7 S 75 E 1.015, Y.P. 7 N 9 W 90%. Checks with old fence North.

Dec 1989, I found a 2" iron pipe on the south shoulder of Hat Rapids Road. The 2 Pine B.T.s by Maine are still good. I set a 2" x 30" Oneida County Capped Monument for the corner & witnessed it as shown below.

(c) (d) (e) Plan view of corner with ties to at least 4 witness monuments. If in disagreement with previously established corner, show the distances between the two corners and also indicate the ties to the disputed corner.

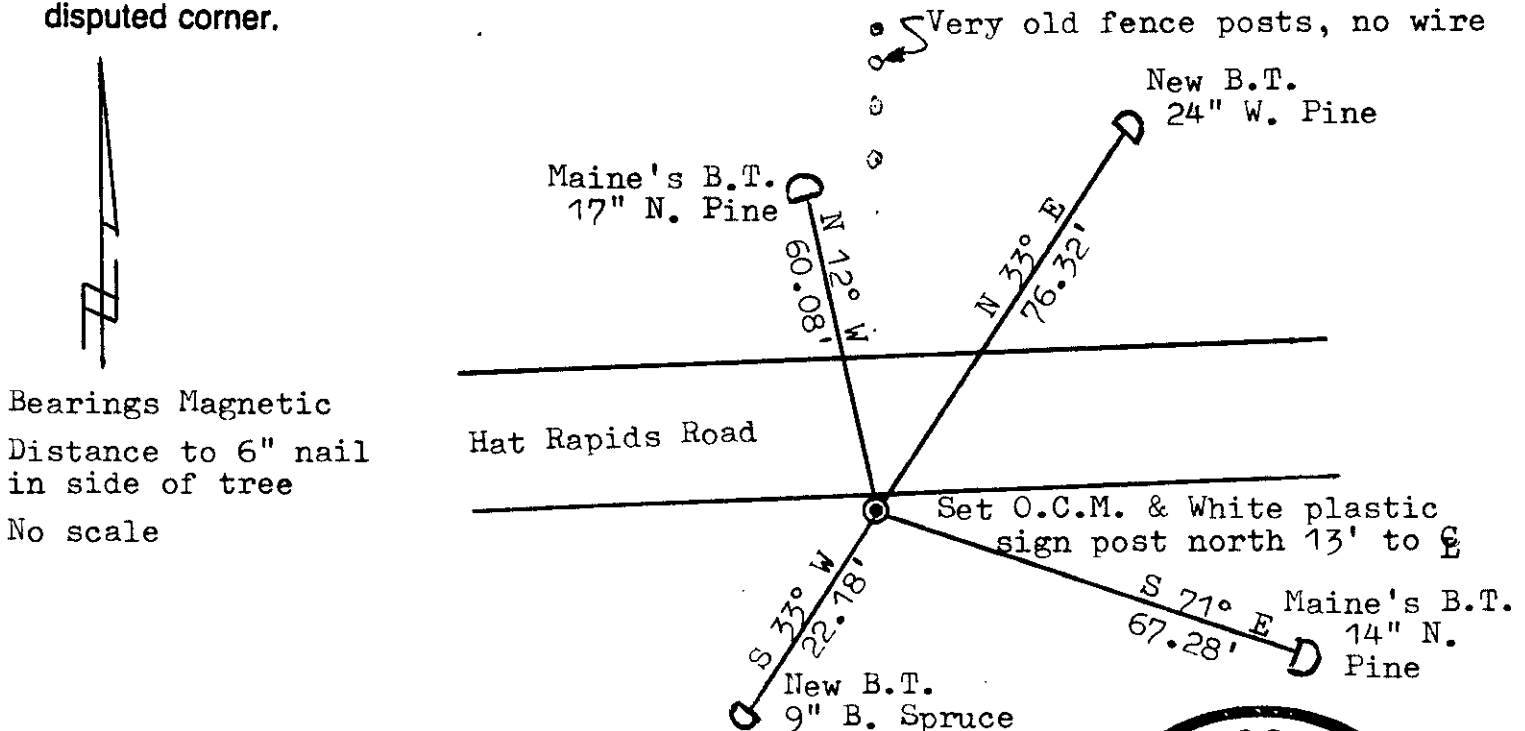

Bearings Magnetic  
Distance to 6" nail  
in side of tree  
No scale

(i) I, Lester J. Schmit R.L.S. 1192

(type or print name) certify that the corner location on this record was determined by me or under my direction and control and that this U.S. Public Land Survey Monument Record is correct and complete to the best of my knowledge and belief.

Lester J. Schmit  
Signature

9 Jun 90  
Date



Index No. V - 17

Stamp

3608270000