

# U.S. PUBLIC LAND SURVEY MONUMENT RECORD

**Note:** This form is intended and designed to fulfill all requirements of Wisconsin Administrative Code, Chapter A-E 7.08 U.S. Public Land Survey Monument Record (3) (a) (b) (c) (d) (e) (f) (g) (h) (i). An additional sheet may be added if necessary to conform with said requirements.

(a) Corner location: Township 36 North  
 Range 8 East/West  
 Town/City/Village Crescent  
 County Oneida

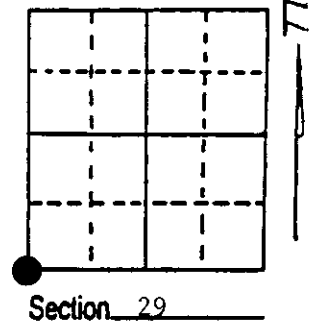

(b) (f) (g) (h) Description of monument found at this corner and if it was accepted, state all evidence (material, testimonial, occupational, plats, records, other monuments) used as a basis for accepting. If not accepted or if nothing was found, state evidence used as basis for establishing location. If reestablished through lost corner proportionate methods, indicate all monuments, distances and directions used to establish. Indicate type of monument found or set and sign post.

- 1863 - Wm. Daugherty established this corner at 80.00 chains and set wood post with two BTs.
- 1940's - County Surveyor, Wincentzen, stated he found an iron pipe in road for corner and called two BTs and two Witness Corners (iron pipes):  
 8" Cherry, S54°E, 73.3'                      24" Oak, S38½°W, 59.1'  
 Iron Pipe, East, 30.0'                      Iron Pipe, West, 30.0'
- 10/15/1992 - Milo E. Stefan found iron in blacktop road with both BTs with stumps only remaining. Both Witness Corner pipes have been moved from the 30.00' as called by Wincentzen.  
 We set PK nail from BT stumps, took new BTs and set 2" x 30" aluminum monument for new Witness Corner with plastic sign post.

(c) (d) (e) Plan view of corner with ties to at least 4 witness monuments. If in disagreement with previously established corner, show the distances between the two corners and also indicate the ties to the disputed corner.

- 1) PK nail on surface of blacktop with iron pipe below surface.
- 2) 12" Red Pine, N30°E, 61.00'.
- 3) 6" Red Maple, S41°E, 56.11'.
- 4) 8" Red Oak, N81°W, 38.67'.
- 5) 2" Iron Pipe, East, 35.71'.
- 6) 2" x 30" aluminum monument, West, 33.52'.
- 7) Plastic sign post, West, 34.9'.
- 8) Cherry Stump, S54°E, 73.3'.
- 9) Oak Stump, S38½°W, 59.1'.

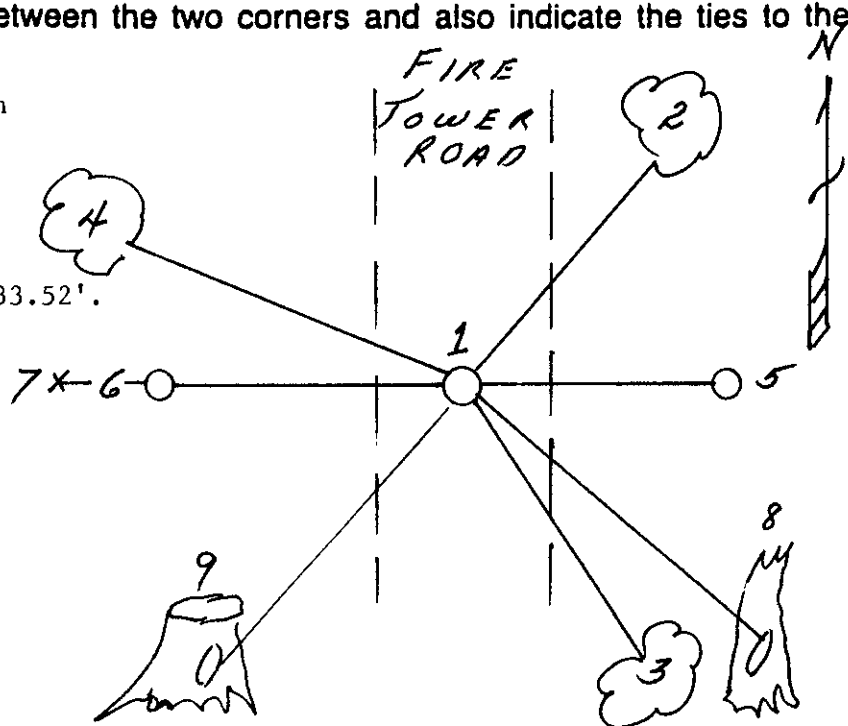

Distances to nail in side of BTs.  
 Stump blazes scribed "BT".

(i) I, Milo E. Stefan  
 (type or print name) certify that the corner location on this record was determined by me or under my direction and control and that this U.S. Public Land Survey Monument Record is correct and complete to the best of my knowledge and belief.

Milo E. Stefan                      December 10, 1992  
 Signature                                      Date



Index No. V-5

3608300000

Stamp