

State of Wisconsin

County of Oneida } ss.

I William E. Bandow, do hereby certify that on the 27th day of March, 1981, I found evidence of the East Meander corner of the north line Section 31 Township 36, North, Range 8 East, Fourth Principal Meridian, as described hereon; and that from this evidence I established a new monument and accessories as described hereon to perpetuate the original location of this corner.

Resident witnesses:

CERTIFIED LAND CORNER RESTORATION

History of original corner establishment:

Section surveyed by William Daugherty in 1865. He does not mention a lake on the north line or any MC's set.

Index No. ~~U-4,5~~

U-4,5

Description of corner evidence found:

No evidence found. Set Oneida County monument on east shore of Bowles Lake and on the north section line of Section 31.

Description of monument and accessories I established to perpetuate the original location of this corner.

Set Oneida County aluminum monument. Made new PT's.

- Oak 4" S63°-00'E 24.73'
- Maple 5" S32°-00'W 18.22'
- W. Birch 12" N75°-00'W 13.61'

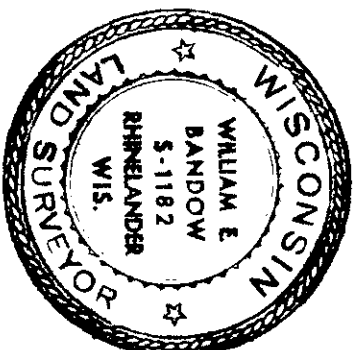

SEC. 31

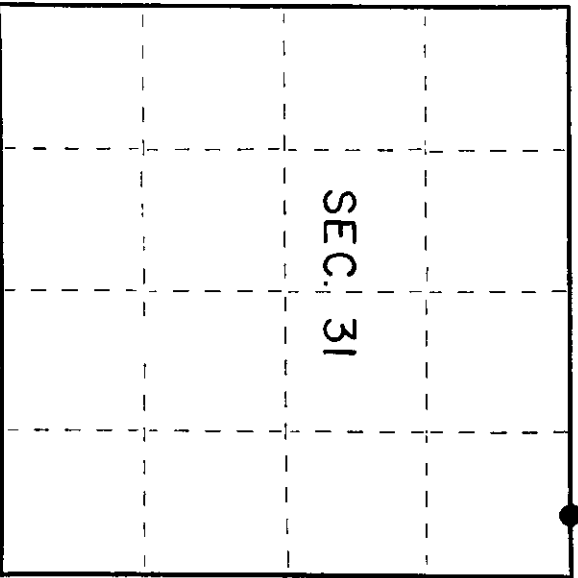

O = Corner monument restored.

Dated at Rhineland, Wis., this 30th day of March, 1981.

Signature: *William E. Bandow* Title: Registered Land Surveyor Registration No. 1182
(County Surveyor, Registered Land Surveyor, or other duly authorized official)

Office of Register of Deeds, County of Oneida, Wis. Hereby certify that the within instrument was filed in this office for record on the 11th day of June, 1981 at 2:55 o'clock P.M.

Debra Vorage Kuzman
(Register of Deeds)

By: *Supriya A. G...* Deputy

360830004