

State of Wisconsin

County of Oneida } ss.

I, William E. Bandow, do hereby certify that on the 27th day of March, 1981, I found evidence of the West meander corner of the north line of Section 31, Township 36, North, Range 8 East, Fourth Principal Meridian, as described hereon; and that from this evidence I established a new monument and accessories as described hereon to perpetuate the original location of this corner.

Resident witnesses:

CERTIFIED LAND CORNER RESTORATION

History of original corner establishment:

Section surveyed by William Daugherty in 1865. He does not mention a lake on the north line or any MC's set.

Index No. ~~31~~ V-3,4

Description of corner evidence found:

No evidence found. Set Oneida County monument on west shore of Howles Lake and on the north section line of Section 31.

Description of monument and accessories I established to perpetuate the original location of this corner.

Set Oneida County aluminum monument. Made new BT's.

- Maple 5" North 6.28'
- Maple 3" S67 -00'W 24.31'
- Maple 3" S23 -00'W 10.41'

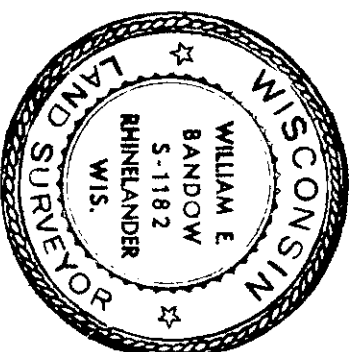

Dated at Rhineland, Wis., this 30th day of March, 1981.

Signature: William E. Bandow, Title Registered Land Surveyor (County Surveyor, Registered Land Surveyor, or other duly authorized official) Registration No. 1182.

Office of Register of Deeds, County of Oneida. I hereby certify that the within instrument was filed in this office for record on the 20th day of June, 1981 at 2:06 o'clock P.M.

By: Dain Varas Register of Deeds, Deputy. Signature: D. Pitts

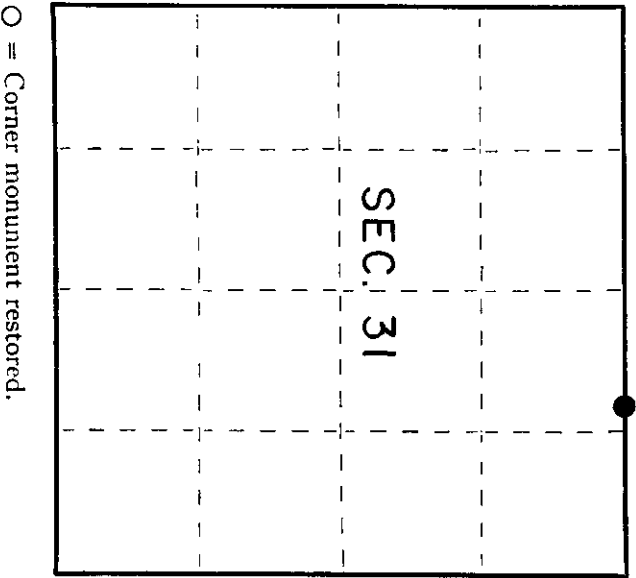

○ = Corner monument restored.

3608300011