

This form is intended to fulfill the requirements of Chapter A-E 7.08 (3)(a) thru (i) U.S. Public Land Survey Monument Location Record, Wisconsin Administrative Code. Use the reverse side of form for continuation.

U.S. PUBLIC LAND SURVEY MONUMENT LOCATION

Recorders Data

USPLS CORNER: NORTH WIT MC SECTION: 1 TOWNSHIP: 36 NORTH RANGE: 09 EAST

NAME OF WATERWAY FOR M.C. CORNER : THOMPSON LAKE SECTION LINE: WEST

~~(CITY)(VILLAGE)(TOWN)~~ OF: PELICAN COUNTY OF: ONEIDA

Description of monument found or placed and all other evidence used as the basis for monument location; including monuments and related measurements required if the corner location was reestablished by lost corner proportionate methods. Also indicate name of original surveyor, original survey date and the corner monument, bearing trees, witness or other reference monuments established; including measured bearing and distance ties, from available records.

Found and accepted an old 3/4" dia. iron pipe monument with uncapped top flush to grade at this corner location and I drove a standard 2" dia. by 30" long aluminum pipe monument with stamped Oneida County cap over the found iron pipe to grade in wooded resort lawn area. At owners request, I did not set a standard white poly "T" marker post at or near the corner.

In July 1863, William E. Daugherty/GLO had set a wood post as the original MC corner and marked OBTs: An 8" Bw N17°E 29 links and a 10" Bw N70°W 16 links; all of which are now obliterated.

In April 1966, James Griffin/RLS 755 of Northwoods Surveyors, Inc. Minocqua, Wisconsin, indicates an iron pipe at this corner and a new BT as nail in 6" Pr N78°W 10.5', now a 13" Pr tipped 10°+ NE at N70°W 10.5' to blaze overgrowth cavity at grade root crown in left face, at which a strong magnetic locator reading indicated that old nail/spike existed within; see Plat of Survey filed as A-382 in Oneida County survey records.

This recovery completed July 7, 2000; there were no direct witnesses to referencing work at this corner, however owner Ms Elaine Gerrish witnessed my entry upon land for such purpose as I had stopped at resort office to advise accordingly.

Plan view map of monument location with bearing and distance ties to a minimum of four(4) described witness or reference monuments of concrete, natural stone, iron, live bearing trees or equivalent material. If applicable, also show a minimum of two(2) bearing and distance ties to any other monument found and not accepted; including the bearing and distance from the accepted monument.

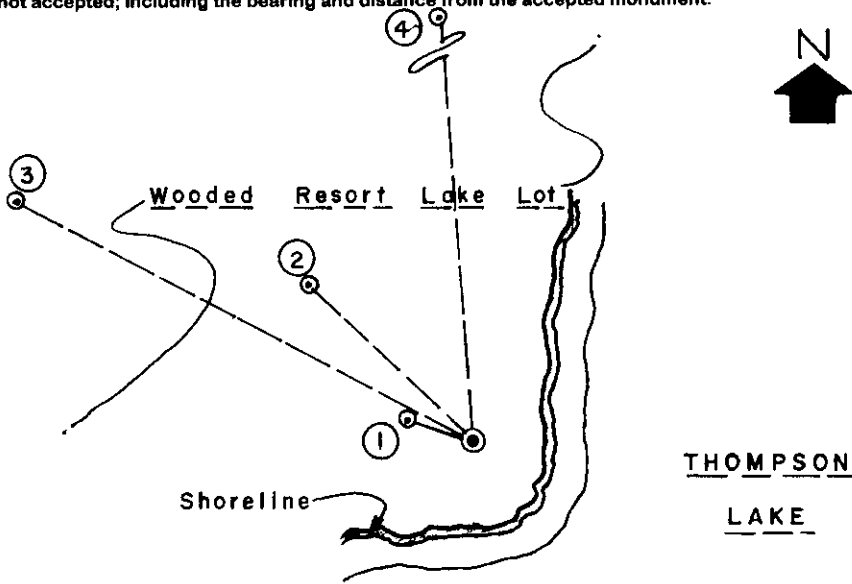

WITNESS MONUMENT TIES:

- ① Old BT 13" Pr N70°W 10.76' to PK nail and washer in left face.
- ② New BT 17" Pw N62°W 80.25' to PK nail and washer in left face.
- ③ New BT 12" Pr N46°W 35.01'.
- ④ New BT 8" Sb N04°W 92.35'.

Corner falls 11 feet West and 13 feet North of stone rip-rapped shoreline of Thompson Lake.

SCALE: 1" = 30'

Unless otherwise indicated, all bearing tree ties are to a .25" dia. by 2.6" long PK nail with a 1.25" dia. steel washer driven into unblazed right face and a .25" dia. by 2.5" long PK nail with a 2" dia. steel washer stamped BT is also driven into unblazed face of bearing tree at DBH; the basis for measured bearings is by compass to nearest degree and all tie distances are measured horizontal by steel tape corrected to nearest 1/100th feet at standard temperature of 68° F.

RLS SEAL:

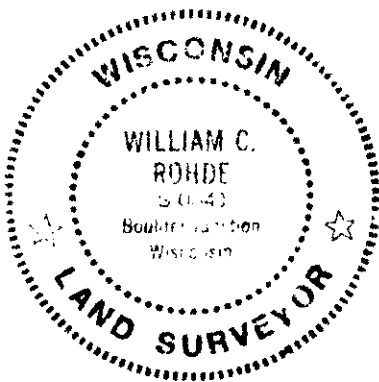

LAND SURVEYOR CERTIFICATE:

I, William C. Rohde, hereby certify that I am duly licensed as a Professional Land Surveyor in the State of Wisconsin; that this USPLS monument location was determined by me and/or under my direct supervision and control; and that this U.S. Public Land Survey Monument Location Record is true and correct to the best of my knowledge and belief.

Signed William C. Rohde
William C. Rohde RLS 841

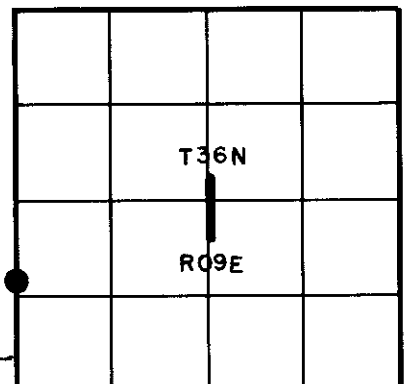

SECTION LOCATION MAP

INDEX NO. _____

360902 1400

C-D 21