

# U.S. PUBLIC LAND SURVEY MONUMENT RECORD

**Note:** This form is intended and designed to fulfill all requirements of Wisconsin Administrative Code, Chapter A-E 5.02, U.S. Public Land Survey Monument Record (3) (a) (b) (c) (d) (e) (f) (g) (h) (i). An additional sheet may be added if necessary to conform with said requirements.

(a) Corner location: Township 36 North  
 Range 9 East/West  
 Town/City/Village Pelican  
 County Oneida

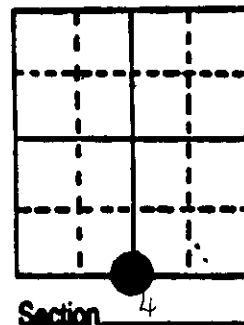

(b) (f) (g) (h) Description of monument found at this corner and if it was accepted, state all evidence (material, testimonial, occupational, plats, records, other monuments) used as a basis for accepting. If not accepted or if nothing was found, state evidence used as basis for establishing location. If reestablished through lost corner proportionate methods, indicate all monuments, distances and directions used to establish.

- 1863 W.E. Daughterty established original corner. . . . West corrected 40.31 set  $\frac{1}{4}$  Post B.T.s Aspen 12 S 16 E 10; Aspen 10 N 44 W 26.
- 1902 D.H. Vaughan states S  $\frac{1}{4}$  Sec. 4 ok Rock with X on top set by Dorr found rotten stumps of original trees.
- 1973 Sy Poskie found rock with X on top.
- 1973 J. Kirby found corner and set a pipe 30.0' North.
- 1987 I found the rock with the cross on it marking the corner. I set an Oneida County Capped Monument over the rock and witnessed it as shown below.

(c) (d) (e) Plan view of corner with ties to at least 4 witness monuments. If in disagreement with previously established corner, show the distances between the two corners and also indicate the ties to the disputed corner.

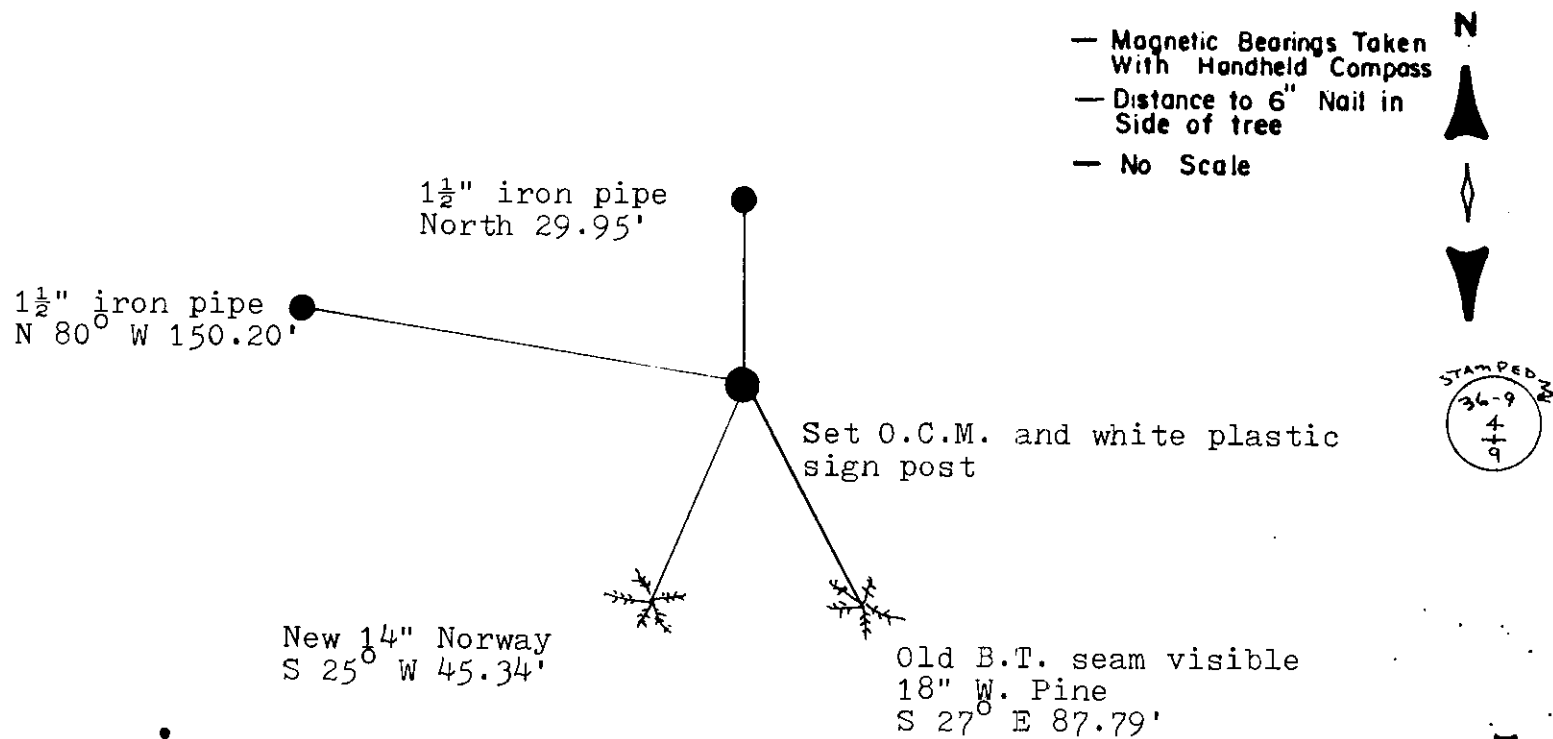

(i) Michael J. Romportl  
 (type or print name) certify that the corner location on this record was determined by me or under my direction and control and that this U.S. Public Land Survey Monument Record is correct and complete to the best of my knowledge and belief.

Michael J. Romportl 4-14-87  
 Signature Date

GENISOT & ASSOCIATES INC.  
 1512 EAGLE ST., RHINELANDER, WIS.

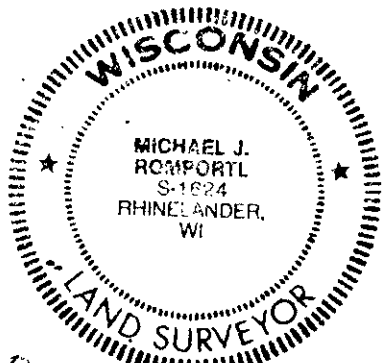

Index No. E-11

3609040020