

U.S. PUBLIC LAND SURVEY MONUMENT RECORD

Note: This form is intended and designed to fulfill all requirements of Wisconsin Administrative Code, Chapter A-E 5.02, U.S. Public Land Survey Monument Record (3) (a) (b) (c) (d) (e) (f) (g) (h) (i). An additional sheet may be added if necessary to conform with said requirements.

(a) Corner location: Township 36 North
 Range 9 East/West
 Town/City/Village Pelican
 County Oneida

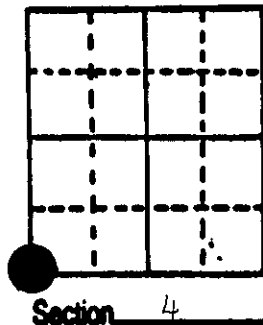

(b) (f) (g) (h) Description of monument found at this corner and if it was accepted, state all evidence (material, testimonial, occupational, plats, records, other monuments) used as a basis for accepting. If not accepted or if nothing was found, state evidence used as basis for establishing location. If reestablished through lost corner proportionate methods, indicate all monuments, distances and directions used to establish.

- 1863 W.E. Daughterty established original corner at 80.00 ch. B.T.s Cedar 10 S 27 W 18; Tamarack 10 N 68 E 16.
- 1889 B.F. Dorr at S.E. corner Sec. 5 measures west 42.52 ch.
- 1931 H.C. Hall at S.W. corner Sec. 4 found old stake against stump of cedar, drove a stake N 27 E 18 lks. From stump agrees with road center line East and North.
- 1956 F.R. Wincentzen indicates an iron pipe at the corner B.T.s Tamarack 6 S 11 E 12.2'; Tamarack 4 S 77 W 10.3.
- 1973 J. Kirby indicates iron pipe at corner.
- 1987 I found a 1" iron pipe marking the corner in line with center line of roads East and North. I also found F.R.W.'s B.T.s. I set an Oneida County Split Base Monument over the 1" pipe and witnessed it as shown below.

(c) (d) (e) Plan view of corner with ties to at least 4 witness monuments. If in disagreement with previously established corner, show the distances between the two corners and also indicate the ties to the disputed corner.

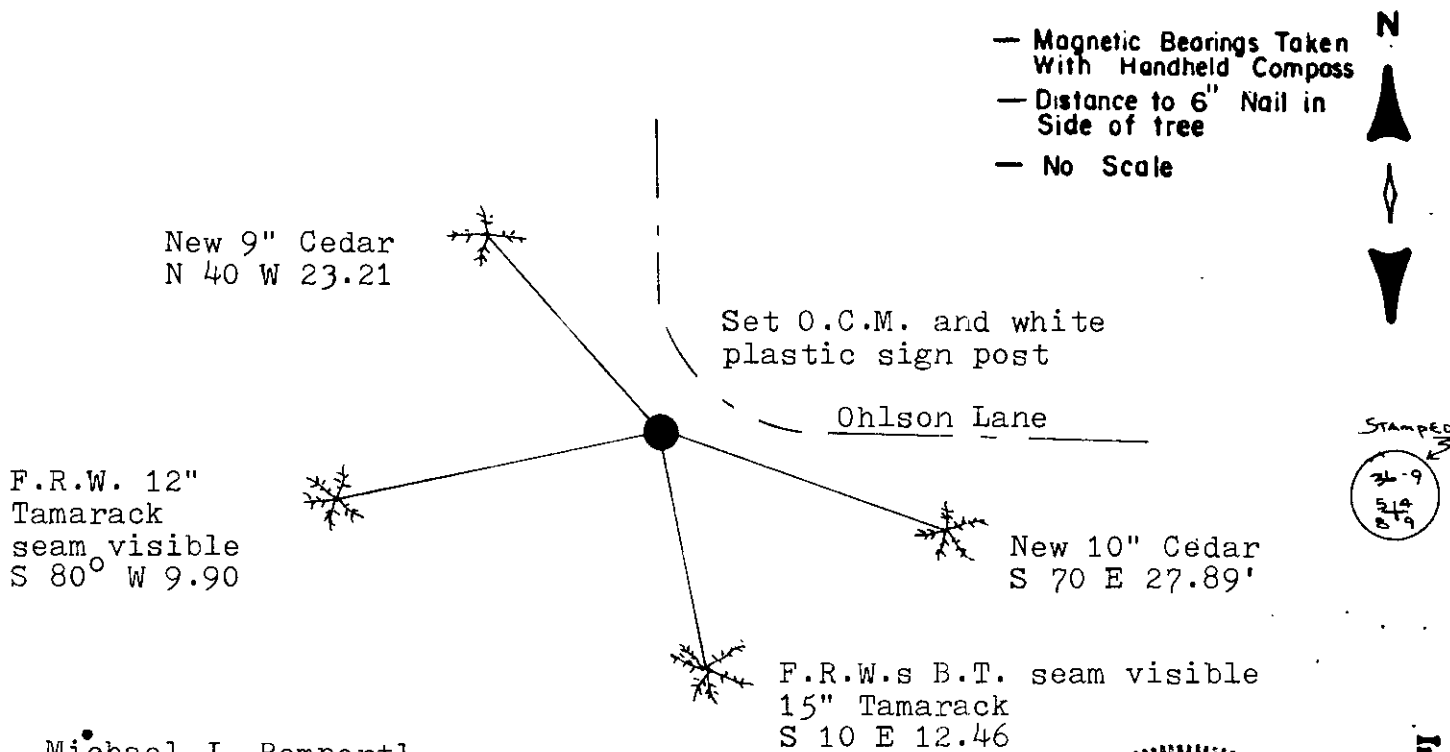

(i) I, Michael J. Romportl
 (type or print name) certify that the corner location on this record was determined by me or under my direction and control and that this U.S. Public Land Survey Monument Record is correct and complete to the best of my knowledge and belief.

Michael J. Romportl 4-14-87
 Signature Date
 GENISOT & ASSOCIATES INC.
 1512 EAGLE ST., RHINELANDER, WIS.

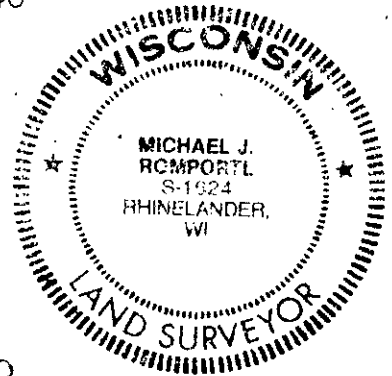

Index No. E-9

3609050000