

CERTIFIED LAND CORNER RESTORATION

State of Wisconsin }
County of Oneida } ss.

I Dennis L. Stella, do hereby certify that on the 25th day of April, 1979, I found evidence of the NW corner of Sec. 19 Township 36N Range 10E, Fourth Principal Meridian, as described hereon; and that from this evidence I established a new monument and accessories as described hereon to perpetuate the original location of this corner:

Description of original monument and accessories and subsequent restorations:

- Set post to Sec. 13, 18, 19, 24
- B.T. Aspen 9" S30°W, 24 Lks Birch 9" N64°E, 46 Lks
- B.T. Tamarack 10" N66°W, 36 Lks Aspen 9" S81°E, 37 Lks

Description of corner evidence found:

Four steel R/W Posts referenced by the State Highway Commission of Wisconsin on 8/31/73.

Description of monument and accessories I established to perpetuate the location of this corner:

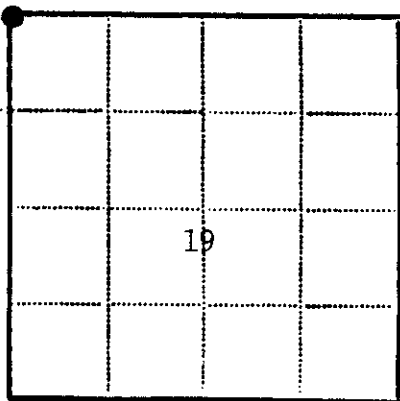
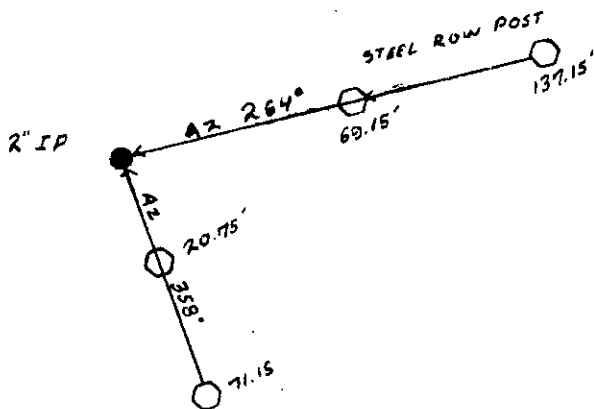
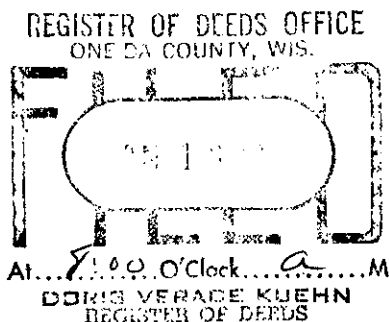

● - Corner monument restored
□ -

Resident witnesses.....

Dated at Rhinelander Wisconsin, this 25th day of April 1979.

Signature Dennis L. Stella Title RLS 1352
(County Surveyor, Registered Land Surveyor, or other duly authorized official)

Surveyors Registration No. 1352

Office of..... County of.....

I hereby certify that the within instrument was filed in this office for record on the..... day of..... 19....., and was filed in Book No..... Page No..... of County Records.

Signature..... Title.....

Township 36N, Range 10E, Section 19, Index No., Page No.

U.S. PUBLIC LAND SURVEY MONUMENT RECORD

Note: This form is intended and designed to fulfill all requirements of Wisconsin Administrative Code, Chapter A-E 7.08 U.S. Public Land Survey Monument Record (3) (a) (b) (c) (d) (e) (f) (g) (h) (i). An additional sheet may be added if necessary to conform with said requirements.

(a) Corner location: Township 36 North
 Range 9 East/West

Town/City/Village Pelican Lake

County Oneida

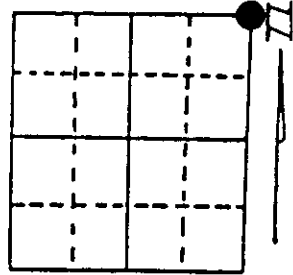

Section 24

(b) (f) (g) (h) Description of monument found at this corner and if it was accepted, state all evidence (material, testimonial, occupational, plats, records, other monuments) used as a basis for accepting. If not accepted or if nothing was found, state evidence used as basis for establishing location. If reestablished through lost corner proportionate methods, indicate all monuments, distances and directions used to establish. Indicate type of monument found or set and sign post.

1859 - H.C. Fellows established this corner at 80.00 Chains and set wood post with BTs:
 9" Birch, N64°E, 46 Links 9" Aspen, S30°W, 24 Links
 9" Aspen, S81°E, 37 Links 10" Tamarack, N66°W, 36 Links

1909 - Vaughan found Southwest BT and made two new references:
 8" Tamarack Stump, S87°W, 65½ Links 15" Tamarack Stump, N34°E, 86 Links

1973 - D.O.T. used corner.

1979 - Certificate by Dennis Stella.

1/6/1992 - Milo E. Stefan found 2" iron pipe flush with ground.

2/12/1992 - Milo E. Stefan set 2" x 30" aluminum monument in place of iron pipe. Found another 2" iron pipe 6" below surface when digging in aluminum monument. Made new references and set sign post.

(c) (d) (e) Plan view of corner with ties to at least 4 witness monuments. If in disagreement with previously established corner, show the distances between the two corners and also indicate the ties to the disputed corner.

- 1) 2" x 30" aluminum county monument with two other iron pipes along side (buried).
- 2) D.O.T. right-of-way post, N84°E, 69.03'.
- 3) D.O.T. right-of-way post, S13°W, 22.80'.
- 4) Power Pole #3610-19W-18, S6°E, 110.56'.
- 5) Power Pole #3610-18L-1, S76°W, 128.17'.
- 6) 3/4" x 18" high iron bolt/square head, S26°E, 48.69'.
- 7) Plastic sign post along side monument.

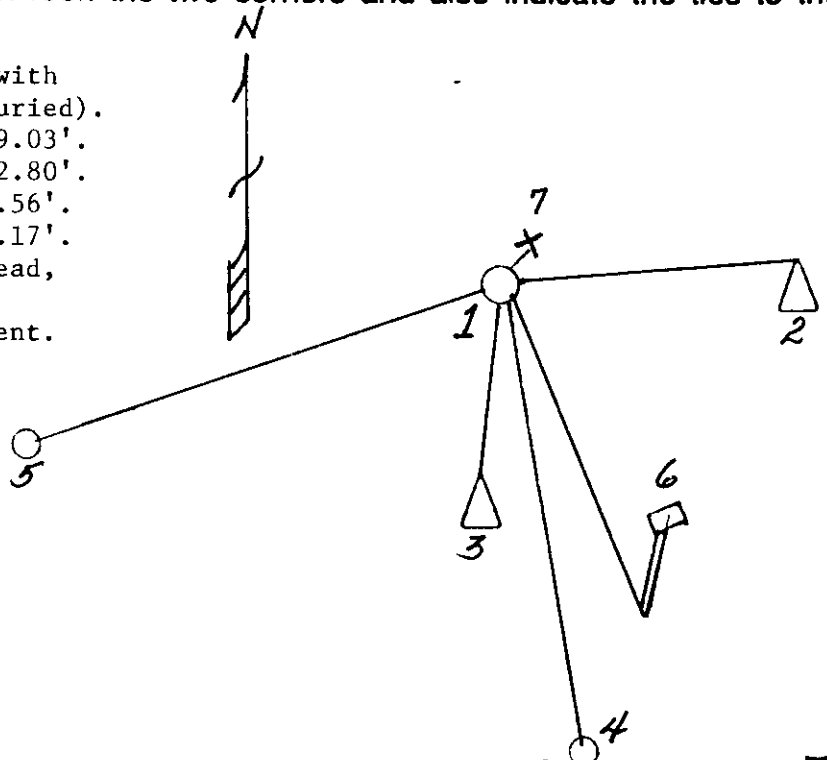

(i) I, Milo E. Stefan
 (type or print name) certify that the corner location on this record was determined by me or under my direction and control and that this U.S. Public Land Survey Monument Record is correct and complete to the best of my knowledge and belief.

Milo E. Stefan
 Signature

2/28/92
 Date



Index No. N-25

3609130000