

U.S. PUBLIC LAND SURVEY MONUMENT RECORD

Note: This form is intended and designed to fulfill all requirements of Wisconsin Administrative Code, Chapter A-E 5.02, U.S. Public Land Survey Monument Record (3) (a) (b) (c) (d) (e) (f) (g) (h) (i). An additional sheet may be added if necessary to conform with said requirements.

(a) Corner location: Township 36 North
 Range 9 East/West
 Town/City/Village PELICAN
 County ONEIDA

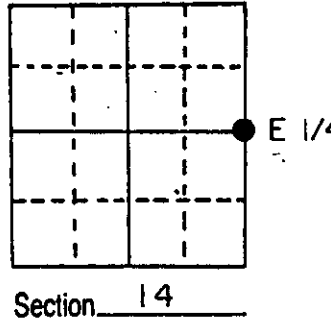

(b) (f) (g) (h) Description of monument found at this corner and if it was accepted, state all evidence (material, testimonial, occupational, plats, records, other monuments) used as a basis for accepting. If not accepted or if nothing was found, state evidence used as basis for establishing location. If reestablished through lost corner proportionate methods, indicate all monuments, distances and directions used to establish.

1863 Wm. Daugherty ran north between Sec. 13 & 14 38.40 to creek, 40.00 set $\frac{1}{4}$ post. BT's Tam 10" S54E 10 & Tam 10" N54W 5.

1912 D.H. Vaughan found Tam. 10" N54W 5 & stump of Tam 10" S54E 10. Made new BT. W. Pine stump 14" N9 $\frac{1}{2}$ W 37.

1924 Burnett found Tam 10" N54W 5 marks plain, Tam stump 10" S54E 10 & Pine stump N15W 24.5'. Made new BT's Spruce 7" N27-30W 13.2, W.Pine 4" N82-30W 24.8' & W. Pine stump 18" N57-30E 16.0'.

1986 I found a 1" iron pipe and BT's and ties as shown below.

(c) (d) (e) Plan view of corner with ties to at least 4 witness monuments. If in disagreement with previously established corner, show the distances between the two corners and also indicate the ties to the disputed corner.

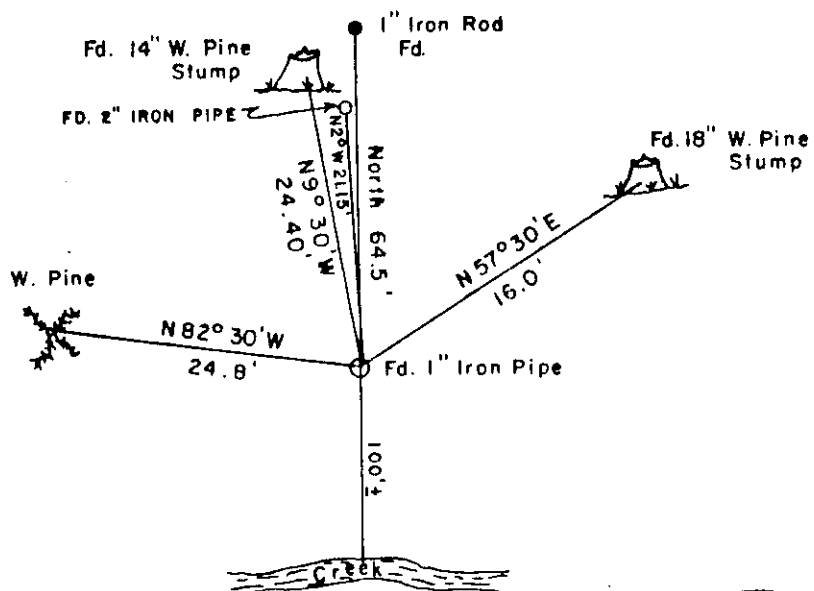
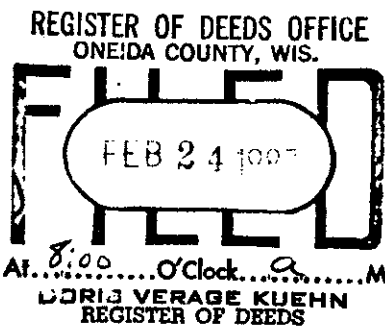

(i) I, WILLIAM E. BANDOW R.L.S. 1182
 (type or print name) certify that the corner location on this record was determined by me or under my direction and control and that this U.S. Public Land Survey Monument Record is correct and complete to the best of my knowledge and belief.

William E. Bandow 12-4-86
 Signature Date



Index No. L-21

3609142000

U.S. PUBLIC LAND SURVEY MONUMENT RECORD

Note: This form is intended and designed to fulfill all requirements of Wisconsin Administrative Code, Chapter A-E 7.08 U.S. Public Land Survey Monument Record (3) (a) (b) (c) (d) (e) (f) (g) (h) (i). An additional sheet may be added if necessary to conform with said requirements.

(a) Corner location: Township 36 North
 Range 9 East/West

Town/City/Village Pelican
 County Oneida

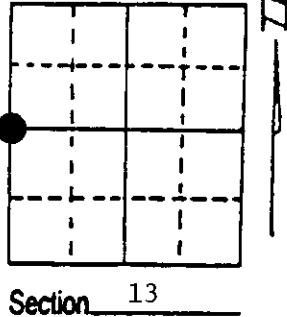

(b) (f) (g) (h) Description of monument found at this corner and if it was accepted, state all evidence (material, testimonial, occupational, plats, records, other monuments) used as a basis for accepting. If not accepted or if nothing was found, state evidence used as basis for establishing location. If reestablished through lost corner proportionate methods, indicate all monuments, distances and directions used to establish. Indicate type of monument found or set and sign post.

1863 - Wm. Daugherty established this corner at 40.00 chains, set post and BTs:
 10" Tamarack, N54°W, 5 Links (3.3') 10" Tamarack, S4°E, 10 Links (6.6')

1924 - Burnett found both original BTs and stake with a new BT:
 12" Red Pine, N12°W, 24.5'. Made three new BTs:
 7" Spruce, N27½°W, 13.2' 4" White Pine, N82½°W, 24.8'
 18" White Pine Stump, N57½°E, 16.0'

12/4/1986 - Wm. Badow found corner and restored it by placing a 1" iron pipe at true corner position.

6/3/1993 - Milo E. Stefan found Badow 1" iron pipe with remains of both original BTs:
 14" Red Pine Stump, N12°W, 24.5' and 20" White Pine Stump, N57½°E, 16.0'.
 We replaced the 1" iron pipe with a 1" x 72" capped aluminum monument, made new BTs and set a plastic sign post.

(c) (d) (e) Plan view of corner with ties to at least 4 witness monuments. If in disagreement with previously established corner, show the distances between the two corners and also indicate the ties to the disputed corner.

- 1) 1" x 72" aluminum county monument.
- 2) 12" White Pine, N33°E, 22.69'.
- 3) 10" Tamarack, N76°E, 54.17'.
- 4) 10" Tamarack, S06°E, 47.58'.
- 5) 12" White Pine, N75°W, 24.79'.
- 6) 14" Red Pine Stump, N12°W, 24.5'.
- 7) 20" White Pine Stump, N57½°E, 16.0'.
- 8) 2" iron pipe, North, 21.33'.
- 9) Plastic sign post, South, 1.0'.

Distance to nail in side of BTs.
 Stump blaze scribed "BT".

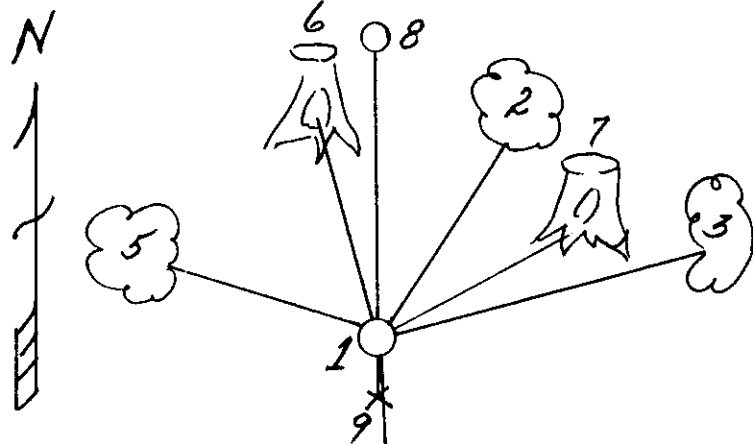

(i) I, Milo E. Stefan
 (type or print name) certify that the corner location on this record was determined by me or under my direction and control and that this U.S. Public Land Survey Monument Record is correct and complete to the best of my knowledge and belief.

Milo E. Stefan
 Signature

June 27, 1993
 Date



Index No. L-21