

U. S. PUBLIC LAND SURVEY MONUMENT RECORD

INSTRUCTIONS: This record shall show the location of the corner and shall include all of the following nine elements (a through i).

- (a) Identify the corner by reference to the U.S. public land survey system.
 ● = Corner monument restored.

The meander corner on the south shore of Lake George between Sections 14 & 15, Township 36 North, Range 9 East, Oneida County, Wisconsin.

Compared with all record evidence and accepted as correct.

Robert H. Winat
 Robert H. Winat, Oneida Co. Surveyor
 4 May 1983

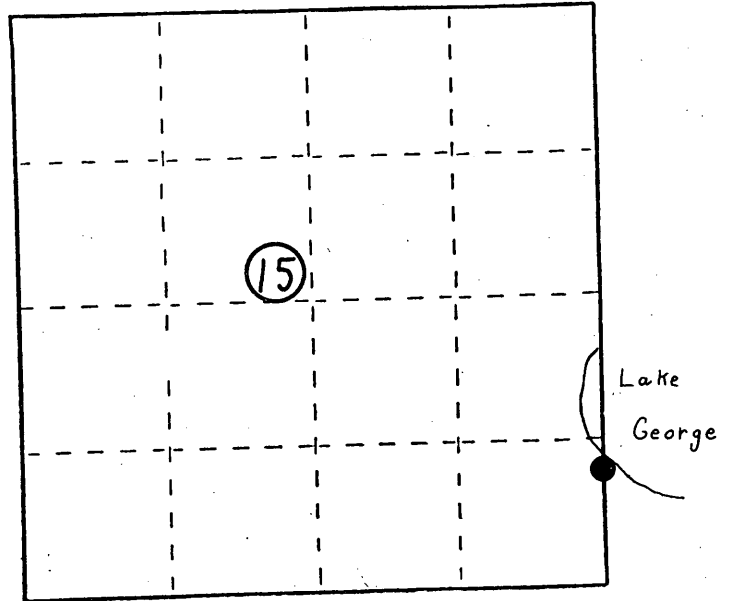

- (b) Describe any record evidence, monument evidence, occupational evidence, testimonial evidence or any other material evidence you considered, and whether the monument was found or placed.

Found a 3" id iron pipe on the south shore of Lake George.
 C.S.M. # 62 June 1971 by Herbert Moore.

- (c) In the plan view drawing below, provide reference ties to at least 4 witness monuments, or, if the location is within a municipality, to at least 2 witness monuments. (Witness monuments shall be made of concrete, natural stone, iron or other equally durable material, except wood.) Describe witness monuments.

- (d) Show a plan view drawing depicting the relevant monuments and reference ties which is sufficient in detail to enable accurate relocation of the corner monument if the corner monument is disturbed. Indicate north.

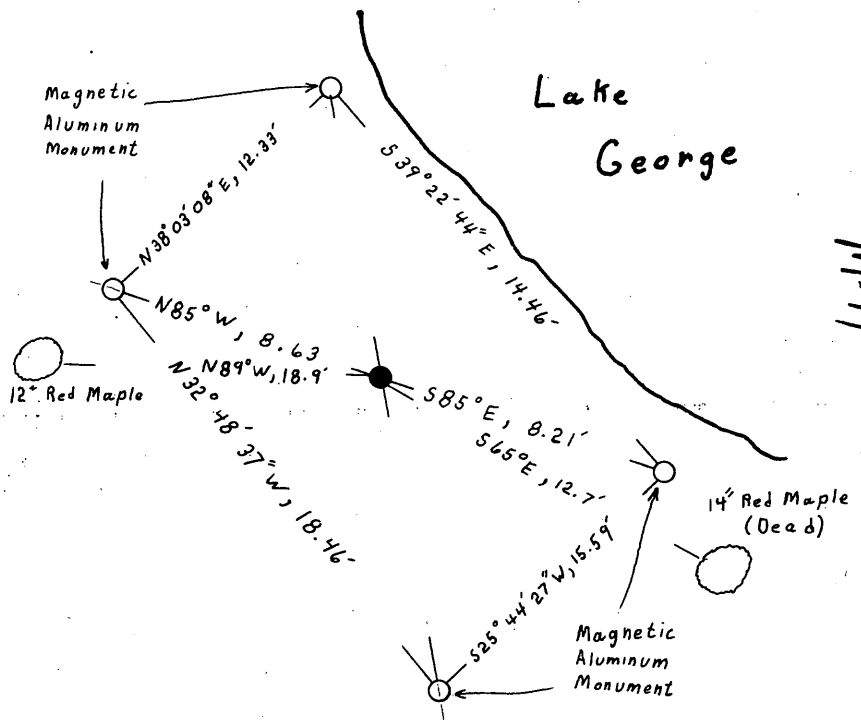

3609150400

Describe any material discrepancy between the location of the corner as restored or reestablished and the location of that corner as previously restored or reestablished by distance and direction. Show the discrepancy on the plan view drawing under (d), above. Show the distances between the corner as previously restored or reestablished and (1) the corner as restored or reestablished, and (2) to at least 2 of the witness monuments shown on the drawing in (d), above.

NA

(f) Was the corner restored through acceptance of (1) an obliterated evidence location, or, (2) a found perpetuated location?

Found perpetuated location.

(g&h) Was the corner reestablished through lost corner proportionate methods? If so, show the method, including the directions and distances to other public land survey corners used as evidence or used for proportioning in determining the corner location?

NA

REGISTER'S OFFICE }
Oneida County, Wis. }

Received for Record the 28 day of
July A.D. 1983 at
2:15 o'clock P. M. and recorded in
Vol. _____ on page _____

Doris Verage Kuehn
Register
Cynthia A. Pires
Deputy

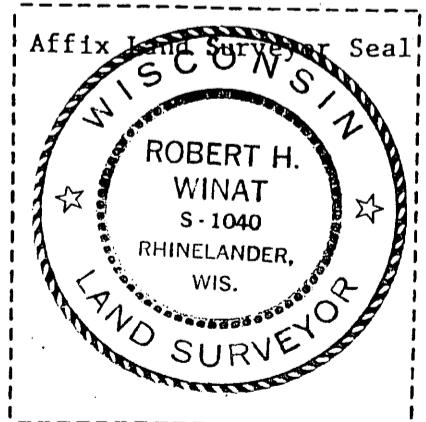

Robert H. Winat, S 1040

(i) I, _____
(type or print name) certify that the corner location shown on this record was determined by me or under my direction and control and that this U.S. Public Land Survey Monument Record is correct and complete to the best of my knowledge and belief.

Robert H. Winat
Signature

29 April 1983
Date

U.S. PUBLIC LAND SURVEY MONUMENT LOCATION RECORD

Recorders Data

USPLS CORNER: SOUTH WITNESS MC SECTION: 14 TOWNSHIP: 36 NORTH RANGE: 09 EAST

NAME OF WATERWAY FOR M.C. CORNER : GEORGE LAKE SECTION LINE: WEST

(CITY)(VILLAGE)(TOWN) OF: PELICAN COUNTY OF: ONEIDA

Description of monument found or placed and all other evidence used as the basis for monument location; including monuments and related measurements required if the corner location was reestablished by lost corner proportionate methods. Also indicate name of original surveyor, original survey date and the corner monument, bearing trees, witness or other reference monuments established; including measured bearing and distance ties, from available records.

Found and accepted an old 3.5" heavy duty iron pipe with concrete filled top 9" above grade tipped slightly but very stable. Per my query with and approval of Oneida County Surveyor Michael Romportl, I left the monument in place and chiseled cardinal notches on top edges of the pipe to aide centering for new ties. Also found a 'U' channel steel post with standard aluminum corner marker sign at top 10" South of the corner monument. The corner falls about 5' South of the shoreline of George Lake this date. I painted corner monument, marker sign post and Wis DOT witness monument caps blaze orange.

In August 1865, William E. Daugherty/GLO set a wood post as the original corner and marked OBTs: a 7" Maple S17°E 69 links and noted no others near; all now obliterated and no other older BTs observed nearby.

Inasmuch as I had also found the two(2) Berntsen witness monuments noted below and stamped by Robert Winat/RLS 1040, I queried him as to when he had recovered and referenced this corner, however he was unable to find information in his or Wisconsin D.O.T. files where he is employed at Rhinelander District Office.

In 1997, Devon Vandeneuvel/RLS 1795, found a 3" dia. iron pipe at this corner as a witness MC per Certified Survey Map No. 2010 filed in Oneida County records. No other previous maps or notes researched in Oneida County survey records were considered applicable to further authenticate this recovery.

Completed September 28, 2001 and indirectly witnessed by Ms B. Limatainen, owner of lake frontage West of the corner.

Plan view map of monument location with bearing and distance ties to a minimum of four(4) described witness or reference monuments of concrete, natural stone, iron, live bearing trees or equivalent material. If applicable, also show a minimum of two(2) bearing and distance ties to any other monument found and not accepted; including the bearing and distance from the accepted monument.

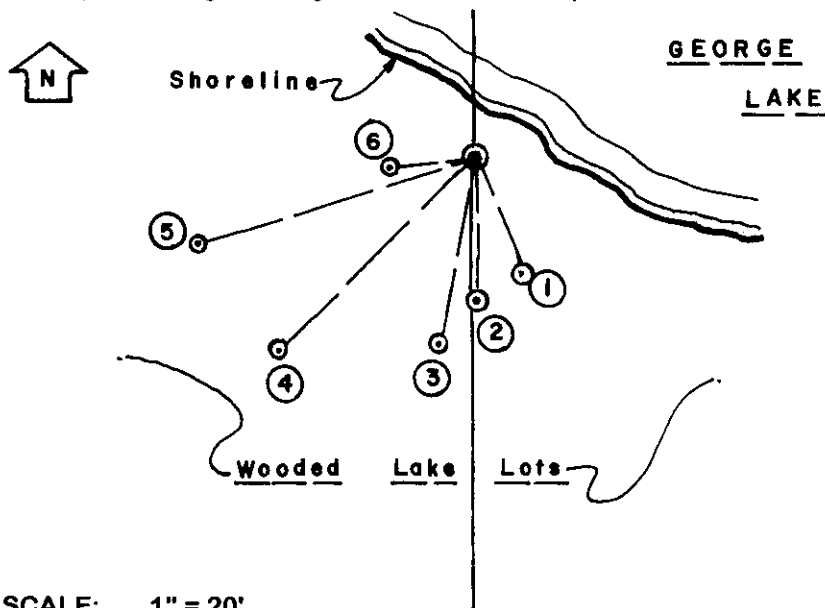

WITNESS MONUMENT TIES:

- ① New BT 8.5" Mr S22°E 12.82'.
- ② 4" dia. cast aluminum Wis DOT capped Berntsen monument found 1" above grade and stamped as a witness monument by Robert Winat, RLS 1040 on unknown date, S02°E 14.89' (S02°E 14.83' stamped on cap).
- ③ New BT 8" Oak S11°W 19.86.
- ④ New BT 10" Mr S45°W 28.88'.
- ⑤ New BT 8" Pw N72°W 30.12'.
- ⑥ same monument found as #2 above N83°W 8.63' (as stamped on cap).

SCALE: 1" = 20'

Unless otherwise indicated, all bearing tree ties are to a .25" dia. by 2.5" long PK nail with a 1.25" dia. steel washer driven into unblazed right face and a .25" dia. by 2.5" long PK nail with a 2" dia. steel washer stamped BT is also driven into unblazed face of bearing tree at DBH; the basis for measured bearings is by compass to nearest degree and all tie distances are measured horizontal by steel tape corrected to nearest 1/100th feet at standard temperature of 68° F.

RLS SEAL:



LAND SURVEYOR CERTIFICATE:

I, William C. Rohde, hereby certify that I am duly licensed as a Professional Land Surveyor in the State of Wisconsin; that this USPLS monument location was determined by me and/or under my direct supervision and control; and that this U.S. Public Land Survey Monument Location Record is true and correct to the best of my knowledge and belief.

Signed *William C. Rohde*
William C. Rohde RLS 841

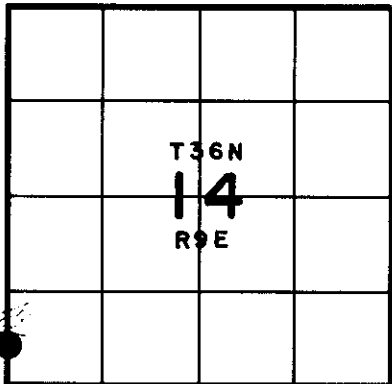

SECTION LOCATION MAP
INDEX NO. M N 11