

U.S. PUBLIC LAND SURVEY MONUMENT RECORD

Note: This form is intended and designed to fulfill all requirements of Wisconsin Administrative Code, Chapter A-E 7.08 U.S. Public Land Survey Monument Record (3)(a)(b)(c)(d)(e)(f)(g)(h)(i). An additional sheet may be added if necessary to conform with said requirements.

(a) Corner location: Township 36 North
 Range 09 (East) West

Town/City/Village PELICAN
 County ONEIDA

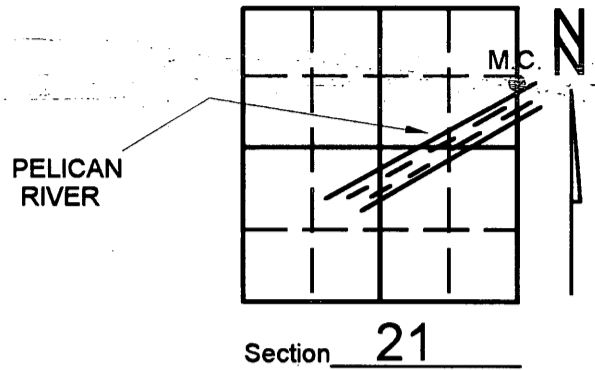

(b) (f) (g) (h) Description of monument found at this corner and if it was accepted, state all evidence (material, testimonial, occupational, plats, records, other monuments) used as a basis for accepting. If not accepted or if nothing was found, state evidence used as basis for establishing location. If reestablished through lost corner proportionate methods, indicate all monuments, distances and directions used to establish. Indicate type of monument found or set and sign post.

-1863- WILLIAM E. DAUGHTERY SET M.C. POST AND MADE THE FOLLOWING B.T.s:
 8" MAPLE, N 25° E, 17 LINKS, 10" MAPLE, N 50° W, 23 LINKS.

- 1999 - KEVIN BIXBY SET ONEIDA COUNTY MONUMENT ESTABLISHING NEW MEANDER CORNER AND WITNESS AS SHOWN BELOW. WHILE DIGGING THE MONUMENT IN, WE DID RECOVER SOME REMAINS OF OLD BARBED-WIRE FENCING.

(c) (d) (e) Plan view of corner with ties to at least 4 witness monuments. If in disagreement with previously established corner, show the distances between the two corners and also indicate the ties to the disputed corner.

NOTE: DISTANCES MEASURED TO 60 PENNY SPIKES SET IN BASE OF TREE. NO SCALE. BEARINGS TAKEN WITH A HAND-HELD MAGNETIC COMPASS. (SEE SHEET NO. 2). WHITE PLASTIC POST SET 1.00 FOOT NORTH OF CORNER. CORNER IS STAMPED AS SHOWN BELOW.

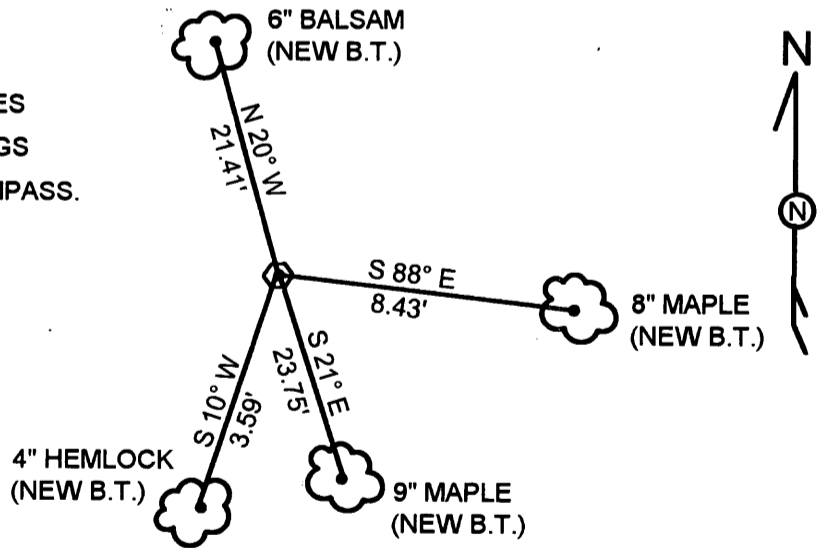

(i) I, KEVIN P. BIXBY
 (type or print name) certify that the corner location on this record was determined by me or under my direction and control and that this U.S. Public Land Survey Monument Record is correct and complete to the best of my knowledge and belief.



Index No. 21-02-13

Kevin P. Bixby
 Signature Date 02/04/00

SHEET 1 OF 2

Stamp

3609212800
3609213400

NE CORNER
SECTION 21

625.46'

M.C.

PELICAN RIVER

2705.48'

2080.02'

N 3°15'10" W

EAST 1/4
SECTION 21

BEARINGS REFERENCED TO THE EAST LINE OF
SECTION 21, T36N, R9E, ASSUMED TO BEAR
N 3°15'10" W.



Kevin P. Bixby

KEVIN P. BIXBY
R.L.S. 2343

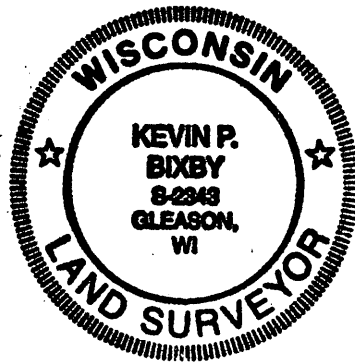

LEGEND

-  FOUND ONEIDA COUNTY MONUMENT
-  SET AND STAMPED ONEIDA COUNTY MONUMENT

NO SCALE

REGISTER OF DEEDS OFFICE
ONEIDA COUNTY, WIS.

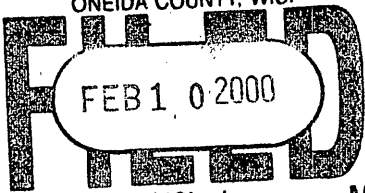

At _____ O'Clock _____ M
THOMAS H. LEIGHTON
REGISTER OF DEEDS