

U.S. PUBLIC LAND SURVEY MONUMENT RECORD

Note: This form is intended and designed to fulfill all requirements of Wisconsin Administrative Code, Chapter A-E 5.02, U.S. Public Land Survey Monument Record (3) (a) (b) (c) (d) (e) (f) (g) (h) (i). An additional sheet may be added if necessary to conform with said requirements.

(a) Corner location: Township 36 North

Range 9 East ~~10~~

Town/City/Village Pelican

County Oneida

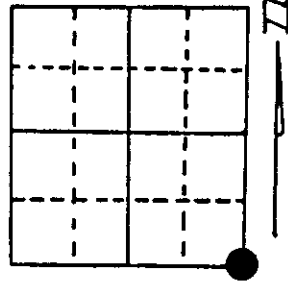

Section 29

(b) (f) (g) (h) Description of monument found at this corner and if it was accepted, state all evidence (material, testimonial, occupational, plats, records, other monuments) used as a basis for accepting. If not accepted or if nothing was found, state evidence used as basis for establishing location. If reestablished through lost corner proportionate methods, indicate all monuments, distances and directions used to establish.

- 1863 W. E. Dougherty set corner Maple 10" N 63 W 75 lks, Birch 12 S 39 E 37 lks.
- 1894 Dorr at SW corner Post made new B.T.'s Hemlock 12" S 53 W 35 1/3 lks, Birch 16" N 62 W 42 2/3 lks.
- 1900 Vaughan set 1/8 Post between S 1/4 of SE corner Section 29. Halfway 20.59 1/4 chains large rock in center of road with + cut on it with stone hammer.
- 1988 W. E. Badow used Vaughan's distance between S 1/4 and SE corner Section 29 from 1900 prolonged section line E from S 1/4 a distance of 41.18 chains. Set Oneida County monument in center of Woods Road. Referenced as shown below. Set survey marker Post N 10' ±.

(c) (d) (e) Plan view of corner with ties to at least 4 witness monuments. If in disagreement with previously established corner, show the distances between the two corners and also indicate the ties to the disputed corner.

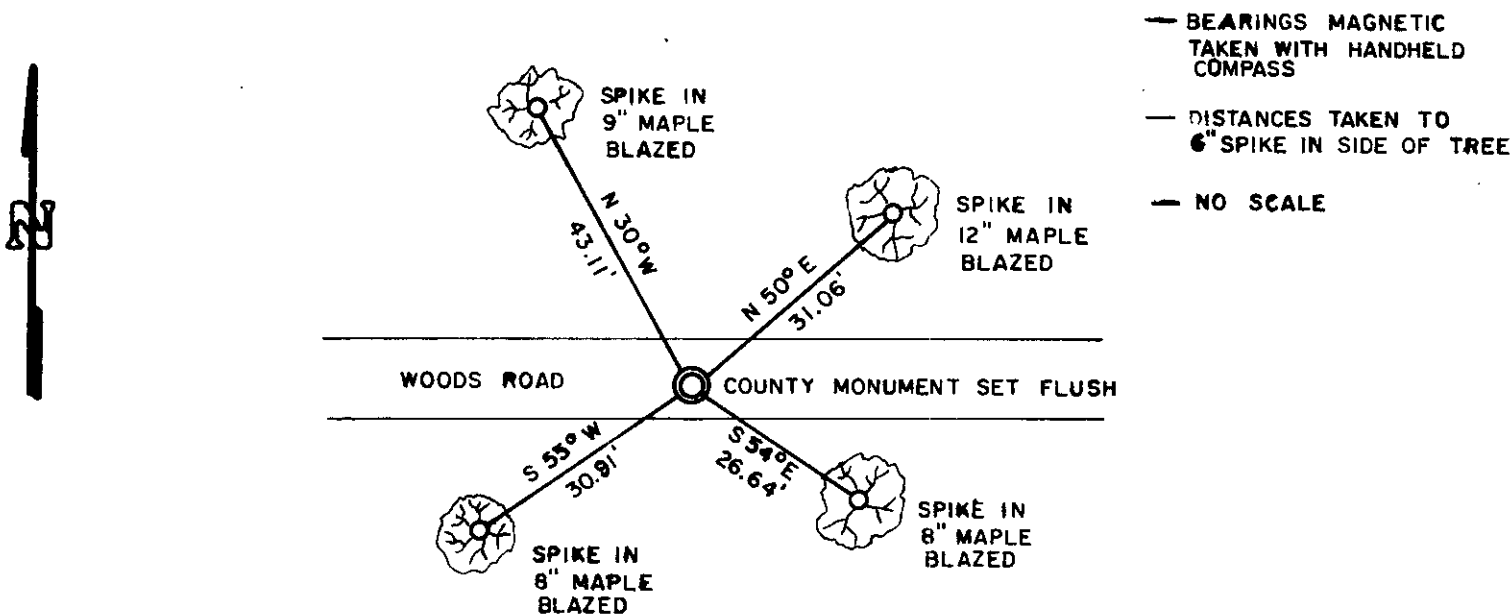

(i) I, William E. Badow

(type or print name) certify that the corner location on this record was determined by me or under my direction and control and that this U.S. Public Land Survey Monument Record is correct and complete to the best of my knowledge and belief.

William E. Badow 11-2-88
Signature Date



Index No. V-9

3609290000