

CERTIFIED LAND CORNER RESTORATION

Index No. X-22

State of Wisconsin

County of Oneida } ss.

I Phillip T. Hansen, do hereby certify that on the 21st day of August, 1979, I found evidence of the WC 1/16 corner of Section 36 Township 36, North, Range 9 East, Fourth Principal Meridian, as described hereon; and that from this evidence I established a new monument and accessories as described hereon to perpetuate the original location of this corner.

Resident witnesses:
Glen Barker
Jim Claflin
Herb Wagoner

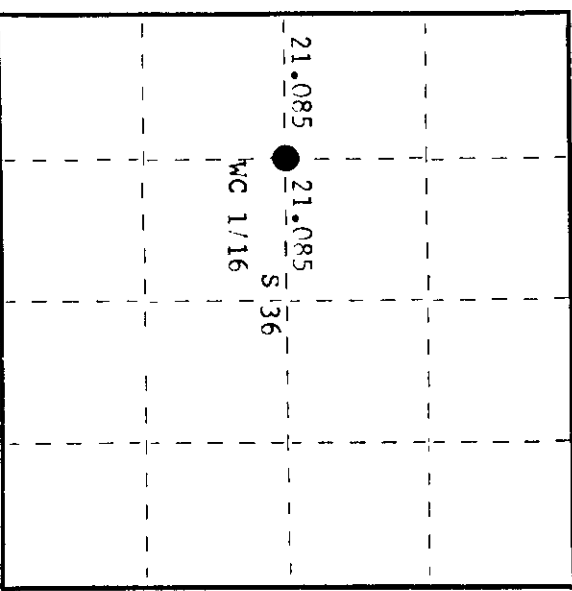
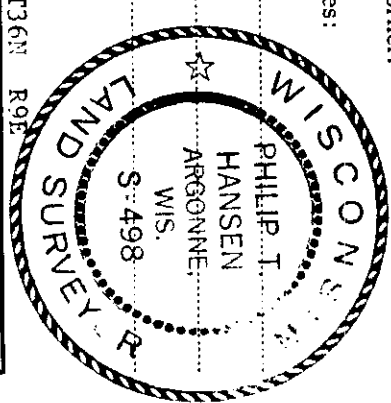

○ = Corner monument restored.

History of original corner establishment:

Corner established by Goddard and crew, Ripco surveyors in 1959. Ran N-S and E-W 1/4 lines to establish the C 1/4 corner. Distance between C 1/4 and W 1/4 corner established at 42.17 chains. Set WC 1/16 at 21.085 chains intermediate.

Marked NBT's
 Maple 4" N90°E 12-1/2 links
 Maple 6" N42°W 34 links

Description of corner evidence found:

Recovered Ripco's 1" iron pipe with 2" square brass cap, projecting 24" above ground.
 Cap stamped:
 Monument recovered in good condition.
 Recovered CBT's - Maple 4" (6") East 12.5 links
 scribbing grown over.
 Maple 6" (8") N42°W 34 links
 scribbing grown over.

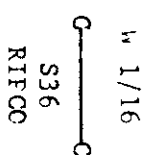

Description of monument and accessories I established to perpetuate the original location of this corner:

Monument left in place as recovered.
 No additional accessories established.

Dated at Rhineland, Wis., this 27th day of August, 1979.

Signature Phillip T. Hansen Title Registered Land Surveyor Registration No. S-498
County Surveyor, Registered Land Surveyor, or other duly authorized official

Office of Register of Deeds, County of Oneida
 Instrument was filed in this office for record on the 17th day of September, 1979 at 105 o'clock P. M. I hereby certify that the within

Doree Verage Kuehn
(Register of Deeds)

By Doree Verage Kuehn Deputy 3609362030