

CERTIFIED LAND CORNER RESTORATION

Index No. W-22

State of Wisconsin

County of Oneida } ss.

I Phillip T. Hansen, do hereby certify that on the 21st day of August, 19 79, I found evidence of the NW 1/16 corner of Section 36 Township 36, North, Range 9 East, Fourth Principal Meridian, as described hereon; and that from this evidence I established a new monument and accessories as described hereon to perpetuate the original location of this corner.

Resident witnesses:

Glen Barker  
Jim Claflin  
Herb Wagoner

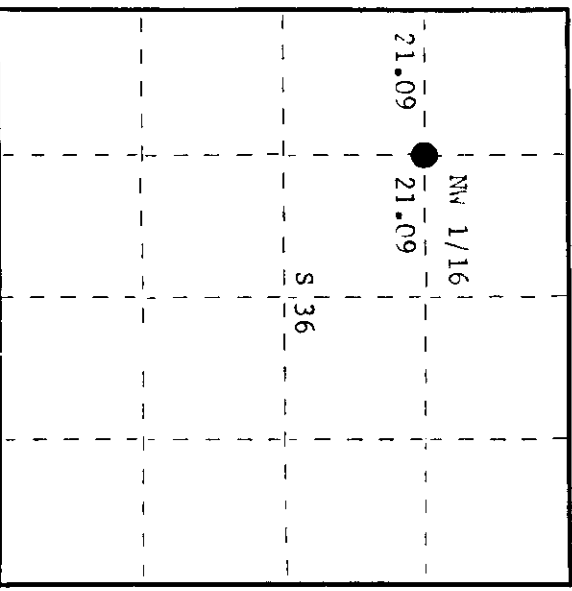
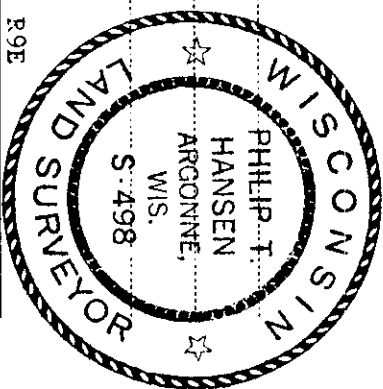

○ = Corner monument restored.

History of original corner establishment:

Corner established by Goddard and crew, Ripco surveyors, in 1959. Ran random line west, bearing 269° 57' magnetic from NC 1/16 corner to N 1/16 on west line, a distance of 42.18 chains. Corrected bearing N 89° 44' W. Set NW 1/16 corner at 21.09 chains. Marked NPT's - Maple 2" N38°E 12-3/4 links Maple 5" S17°W 9 links

Description of corner evidence found:

Recovered 1" iron pipe with brass cap, projecting 24" above ground, stamped: Recovered Maple 2" (5") N38°E 12.75 links, now a 10' stub. Maple 5" S17°W 9 links, now a cut off stump. Monument recovered in good condition. NW 1/16 S36 R10CO

Description of monument and accessories I established to perpetuate the original location of this corner.

Left monument in place as recovered. Painted it blue for easier identification. Marked NPT's - Maple 6" N19°W 36 links, scribed 1/16 FT. Maple 5" N28°E 24.4 links, scribed 1/16 FT.

Dated at Rhinelander, Wis., this 27th day of August, 19 79

Signature: Phillip T. Hansen Title: Registered Land Surveyor Registration No. S-498  
(County Surveyor, Registered Land Surveyor, or other duly authorized official)

Office of Register of Deeds, County of Oneida. I hereby certify that the within instrument was filed in this office for record on the 17th day of September, 19 79 at 10:5 o'clock P. M.

Dennis George Kuehn  
(Register of Deeds)

By: \_\_\_\_\_ Deputy

3609363030