

CERTIFIED LAND CORNER RESTORATION

Index No. **E-14**

State of Wisconsin } ss.

County of Oneida

I Philip T. Hansen do hereby certify that on the 15th day of August, 1975, I found evidence of the W-1/16 corner of Sections 3 and 10 Township 36 North, Range 10 East, Fourth Principal Meridian, as described hereon; and that from this evidence I established a new monument and accessories as described hereon to perpetuate the original location of this corner.

Resident witnesses:

Glen Barker  
Jim Cl. Flin

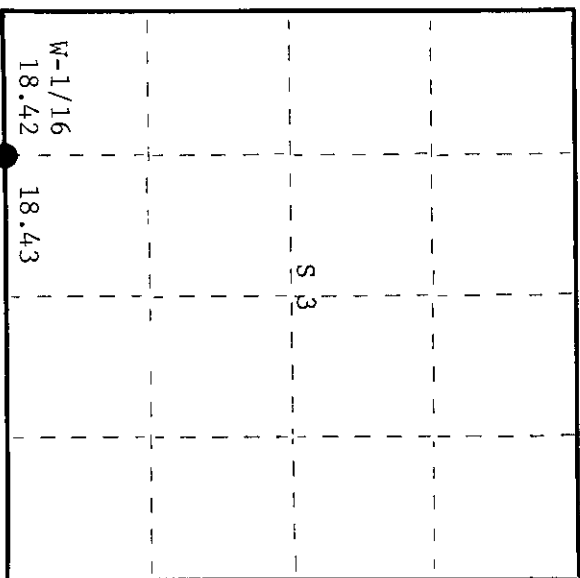
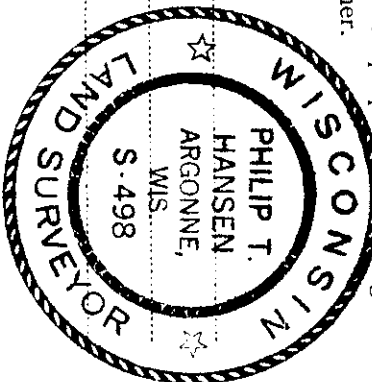

○ = Corner monument restored.

3610030030

History of original corner establishment:  
Corner established by D.H. Vaughan, County Surveyor, in 1906 from which he made BT's: Pine 11" N75-1/2°W, 20-1/2 links and pine 6" S52°W, 16 links. Corner recovered in 1946 by H.C. Lawrence, Registered Land Surveyor. He ran the section line east from 1/4 corner N73°W and at 18.43 he found remnants of Vaughan's W-1/16 corner. Checking for stumps of Vaughan's BT's, he found two pine stumps scribed and notched: Pine N64°E, 21 links and pine stump S34°E, 20 links. These did not agree with the calls for Vaughan's BT's. Lawrence's corner fell within 2 links of Vaughan's old point so he set his new post in Vaughan's post hole.  
Marked NBT: Spruce pine 7" N72°E 47-1/2 links

Description of corner evidence found:  
Recovered 1-1/2" iron pipe driven in ground beside old cedar point. No evidence of Lawrence's scribed post. Point checked measurement and bearing to Lawrence's BT.  
Recovered: Jack pine (spruce) 7"(8") N72°E 47.5 links-scribed S3 NBT  
Pine stump S34°E 20 links-scribe marks visible, fire scarred  
Pine stump N64°E 21 links-now a decayed stump

Description of monument and accessories I established to perpetuate the original location of this corner.  
Replaced old wood point and iron pipe with 1-1/2" OD iron pipe w/2" brass cap stamped -

S498  
T36N R10E

NBT: Jack pine 9" N23°W 27.2 links-scribed 1/16 BT

W-1/16 S 3  
W 10

CPT-1975

Dated at Rhineland, Wis., this 3rd day of September, 1975

Signature *Philip T. Hansen* Title Registered Land Surveyor Registration No. S-498  
(County Surveyor, Registered Land Surveyor, or other duly authorized official)

Office of Register of Deeds, County of Oneida  
instrument was filed in this office for record on the 14th day of October, 1975 at 2:00 o'clock P.M.

*Dennis George Fischer*  
(Register of Deeds)

By Deputy