

CERTIFIED LAND CORNER RESTORATION

Index No. **B-13**

State of Wisconsin

County of Oneida } ss.

I, Philip T. Hansen, do hereby certify that on the 18th day of August, 1975, I found evidence of the N-1/16 between Sections 3 and 4 corner of Township 36 North, Range 10 East, Fourth Principal Meridian, as described hereon; and that from this evidence I established a new monument and accessories as described hereon to perpetuate the original location of this corner.

Resident witnesses:

Glen Barker
Jim Claflin

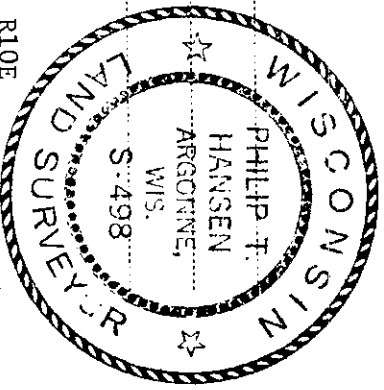

History of original corner establishment:
Corner established by D.H. Vaughan, County Surveyor, in 1906, from which yellow pine 10" bears N69°E, 146 1/2 links.
Corner recovered by H.C. Lawrence, Registered Land Surveyor, in 1946. Recovered rotted remains of Vaughan's old post and his BT and from distance from BT was able to recover the point of his old stake. Set new cedar post and marked new BT's - spruce pine (Jack) 8", S9°W, 159.5 links and spruce pine 10", S72°W, 163.5 links.

Description of corner evidence found:
Recovered H.C. Lawrence's 4" cedar post, squared and scribed N-1/16 S3; N-1/16 S4, in fair condition.
Recovered Jack pine 8" (10") S9°W 159.5 links scribed N-1/16 NBT
Jack pine 10" S72°W 163.5 links (161.5 links) scribed S4 N-1/16 NBT

Description of monument and accessories I established to perpetuate the original location of this corner.
Replaced 4" wooden stake with 1 1/2" OD iron pipe with 2" brass cap stamped -

NBT - Red pine 12" S57°E 99.7 links scribed 1/16 BT

S4 | S3
CPI-1975

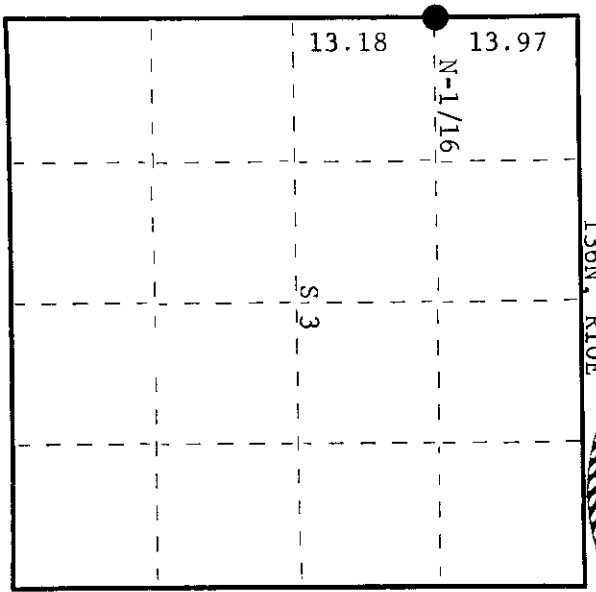

○ = Corner monument restored.

3610043000

Dated at Rhinelander, Wis., this 2nd day of September, 1975.

Signature *Philip T. Hansen* Title Registered Land Surveyor Registration No. S-498
County Surveyor, Registered Land Surveyor, or other duly authorized official

Office of Register of Deeds, County of Oneida
Instrument was filed in this office for record on the 14th day of October, 1975 at 2:02 o'clock P.M.

Doris George Fischer
Register of Deeds

By: Deputy