

CERTIFIED LAND CORNER RESTORATION

Index No. H-13

History of original corner establishment:

Corner established by D.H. Vaughan, County Surveyor.
H.C. Lawrence, Registered Land Surveyor, recovered old post at 21.97 chains south of 1/4 corner. Set new post and marked NBT's - Spruce Pine 12" S79°W, 44 1/2 links; Spruce Pine 12" S25°W, 55 links.

Description of corner evidence found:

Recovered Lawrence's 3" cedar post, squared and scribed S9, S 1/16 S10, standing, but in very poor condition. Also an old 4" squared cedar post laying beside it.
Recovered Spruce Pine 12" S25°W, 53 links (61.5 links), scribed S 1/16 BT, dead but standing. No evidence of Spruce Pine 12" S79°W, 44.5 links.

Description of monument and accessories I established to perpetuate the original location of this corner.

Replaced Lawrence's post with 1 1/2" iron pipe with 2" brass cap, stamped:
Monument projects 24" above ground.

Marked NBT's -

- Jack Pine 8", S44°E, 44.4 links S498
- Jack Pine 10" N14°E, 75.4 links, scribed 1/16 BT. T36N R10E
- S 1/16 9 + 10
- CPI-1978

State of Wisconsin

County of Oneida } ss.

I, Phillip T. Hansen, do hereby certify that on the 5th day of October, 1978, I found evidence of the S 1/16 corner of Sections 9 & 10 Township 36, North, Range 10 East, Fourth Principal Meridian, as described hereon; and that from this evidence I established a new monument and accessories as described hereon to perpetuate the original location of this corner.

Resident witnesses:

Glen Barker

Jim Clafflin

Herb Wagoner

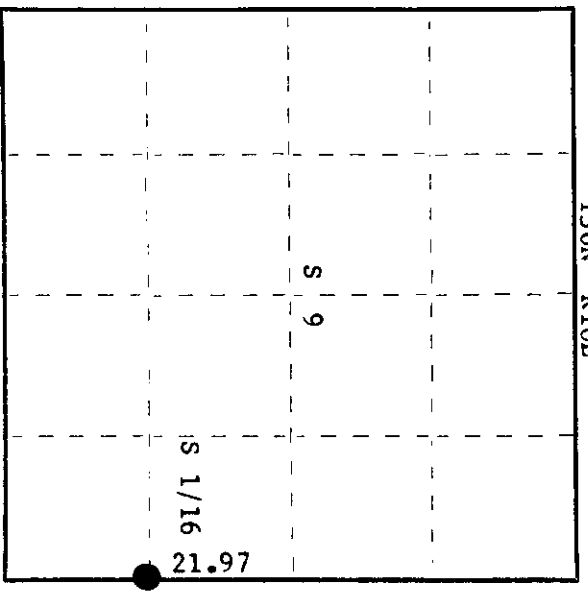
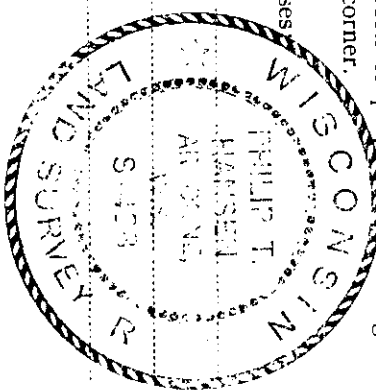

○ = Corner monument restored.

Dated at Rhinelander, Wis., this 9th day of October, 1978

Signature: Phillip T. Hansen Title: Registered Land Surveyor Registration No. S-498
(County Surveyor, Registered Land Surveyor, or other duly authorized official)

Office of Register of Deeds, County of Oneida 1874 day of October I hereby certify that the within instrument was filed in this office for record on the 15th day of October, 1978 at 1:50 o'clock P. M.

Doris Heritage Kuehn
(Register of Deeds)

By: _____ Deputy

3610091000