

CERTIFIED LAND CORNER RESTORATION

Index No. **J-21**

State of Wisconsin

County of Oneida } ss.

I Phillip T. Hansen, do hereby certify that on the 31st day of July, 1975, I found evidence of the Section corner of Sections 11, 12, 13, and 14 Township 36, North, Range 10 East, Fourth Principal Meridian, as described hereon; and that from this evidence I established a new monument and accessories as described hereon to perpetuate the original location of this corner.

Resident witnesses:
Glen Barker
Jim Clarlin

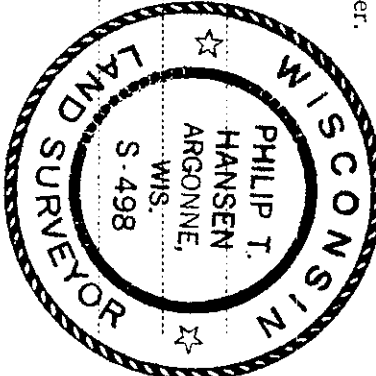

History of original corner establishment:
 Corner established by Wm. E. Dougherty, Government Deputy Surveyor, in 1859 from which aspen 10" bears S69°E, 28 links and birch 10" bears S87°W, 13 links. Corner recovered by D.H. Vaughan, County Surveyor. Set new post and marked BT. No record of BT's. Corner recovered by H.C. Lawrence, Registered Land Surveyor, in 1951. Set new post with rocks piled around base and marked NBT; Red pine 12" S86°W 300.5 links-scribed S14 BT.

Description of corner evidence found:
 Recovered 4" cedar post, squared and scribed S11, S12, S13, S14 in poor condition.

OBT: Red pine S86°W 300.5 links-scribed 1/4 BT

Description of monument and accessories I established to perpetuate the original location of this corner.
 Replaced 4" cedar post with 2-1/2" iron pipe w/brass cap stamped - S498
 T36N R10E

NBT: White spruce 14" S66°W 37.2 links-scribed SC BT
 S11 | S12
 S14 | S13
 CPT-1975

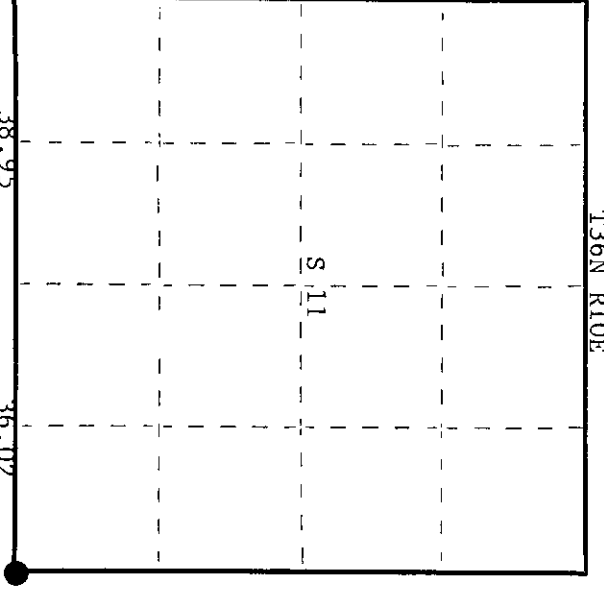

○ = Corner monument restored.

Dated at Rhineland, Wis., this 4th day of September, 1975.

Signature Phillip T. Hansen Title Registered Land Surveyor Registration No. S-498
 (County Surveyor, Registered Land Surveyor, or other duly authorized official)

Office of Register of Deeds, County of Oneida
 Instrument was filed in this office for record on the 14th day of October, 1975
 at 2:00 o'clock P. M.

Doris George Funder
 (Register of Deeds)

By _____ Deputy

3610110000