

CERTIFIED LAND CORNER RESTORATION

Index No. **F-25**

State of Wisconsin } ss.
County of Oneida

I Phillip T. Hansen, do hereby certify that on the 6th day of January, 1977, I found evidence of the N 1/16 corner of Section 7 & 12

Township 36, North, Range 10 & 11 East, Fourth Principal Meridian,

as described hereon; and that from this evidence I established a new monument and accessories as described hereon to perpetuate the original location of this corner.

Resident witnesses:

Glen Barker

Jim Garlin

Herb Wagoner

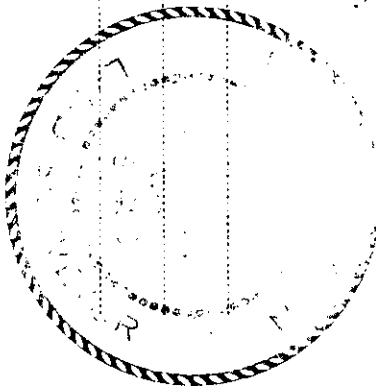

History of original corner establishment:
Original Corner established by D.H. Vaughan, County Surveyor, in 1910. Set 6" cedar post. Corner set at 20.60 chains equidistant. Notes claim he found an old 1/8 post 4 links north and 4 links east of his post. H.C. Lawrence, Registered Land Surveyor, recovered Vaughan's cedar post in 1951. Did not recover any old BTs. Also found the old post mentioned by Vaughan. Set 3" tamarack post. No mention of any NBTs.

Description of corner evidence found:
Recovered Lawrence's 3" tamarack post, squared and scribed N 1/16 S7, N 1/16 S12. Post in very poor condition. No BTs were recovered.

Description of monument and accessories I established to perpetuate the original location of this corner.
Replaced point of tamarack post with 1 1/2" OD iron pipe with 2" brass cap stamped: Monument projects 12" above ground. NBTs - Black Spruce 7" N 44° W 56 links, scribed 1/16 BT. Black Spruce 6" N 13° E 47.9 links, scribed 1/16 BT.

S498
T36N
R 10
E N 1/16
CPI - 1977
R 11
E

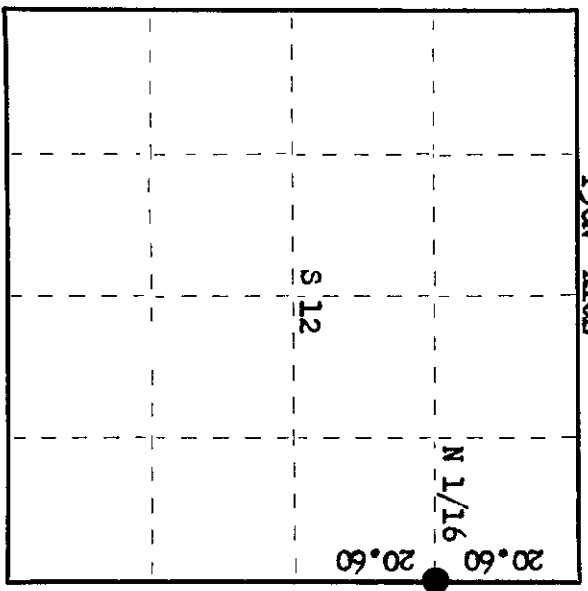

O = Corner monument restored.

Dated at Rhineland, Wis., this 20th day of January, 1977.

Signature Phillip T. Hansen Title Registered Land Surveyor Registration No. S-498
(County Surveyor, Registered Land Surveyor, or other duly authorized official)

Office of Register of Deeds, County of Oneida
at 1:20 o'clock P. M. 24th day of January, 1977.
I hereby certify that the within

Doris Veraga
(Register of Deeds)

By _____ Deputy

3610123000