

CERTIFIED LAND CORNER RESTORATION

Index No. **N-10**

State of Wisconsin } ss.
 County of Oneida }

I Philip T. Hansen do hereby certify that on the 20th day of July, 1976, I found evidence of the N 1/16 corner of Section 16 and 21 Township 36 North, Range 10 East, Fourth Principal Meridian, as described hereon; and that from this evidence I established a new monument and accessories as described hereon to perpetuate the original location of this corner.

Resident witnesses:

Jim Claflin
 Herb Wagoner

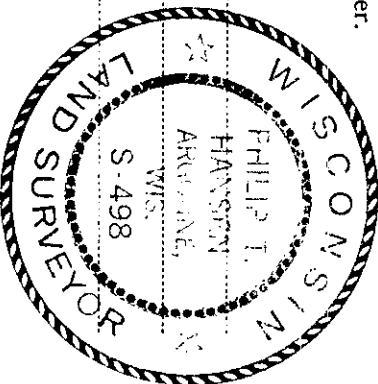

History of original corner establishment: Corner established by H. J. Lawrence, Registered Land Surveyor, in 1954. He recovered 1/4 corner in 1948, while crossing. Recovered both original BTs and established Corner from true. In 1954, he ran the random line N 87° 30' mag., 41.58 chains, closed out 50 lks north of 1/4 corner. set 1/16 corner at 25 lks south at 20.79 chains, equidistant. set 4" squared cedar post.

Description of corner evidence found:
 Recovered 4" squared and scribed cedar post in good condition. Scribed 1/16 S 16 - S 21. No BTs were recovered.

Description of monument and accessories I established to perpetuate the original location of this corner. Replaced 4" squared cedar post with 1 1/2" iron pipe with brass cap, stamped. monument projects 20" above ground.
 MBTs - N. Spruce 8" N 60° E 31.3 lks, scribed 1/16 BT.
 N. Spruce 8" S 56° E 30.4 lks, scribed 1/16 BT.
 Monument and BTs painted blue.

498
 T36N R10E
 N 1/16 S 16
 S 21
 CRI-1976

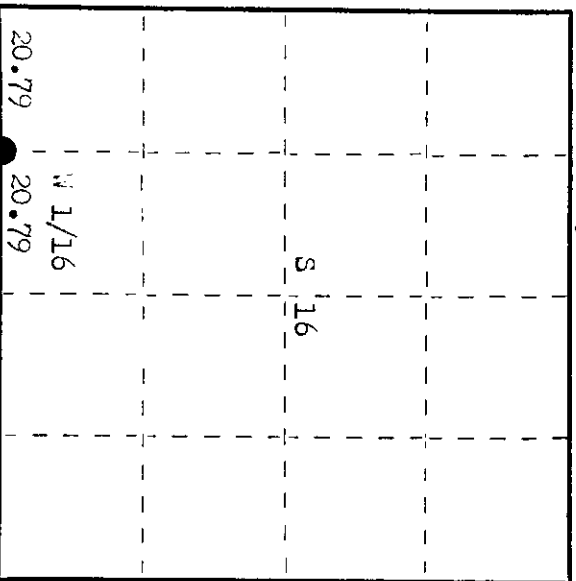

○ = Corner monument restored.

Dated at Rhineland, Wis., this 19th day of August, 1976.

Signature *Philip T. Hansen* Title Registered Land Surveyor Registration No. 498
 (County Surveyor, Registered Land Surveyor, or other duly authorized official)

Office of Register of Deeds, County of Oneida. I hereby certify that the within instrument was filed in this office for record on the 22nd day of September, 1976, at 1:00 o'clock P.M.

Thomas George Kuehn
 (Register of Deeds)

By Deputy

3610160030