

CERTIFIED LAND CORNER RESTORATION

Index No. N-6

State of Wisconsin }
 County of Oneida } ss.

I Phillip T. Hansen, do hereby certify that on the 1st day of December, 1975, I found evidence of the W-1/16 corner of Section 17 and 20 Township 36, North, Range 10 East, Fourth Principal Meridian, as described hereon; and that from this evidence I established a new monument and accessories as described hereon to perpetuate the original location of this corner.

Resident witnesses:

Glen Barker
Jim Clafflin

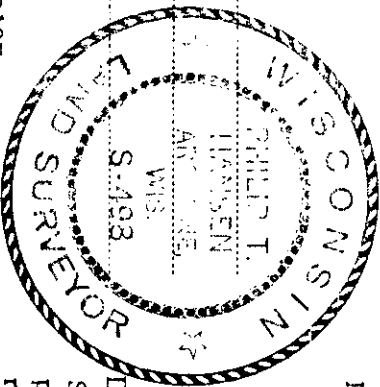

T36N R10E

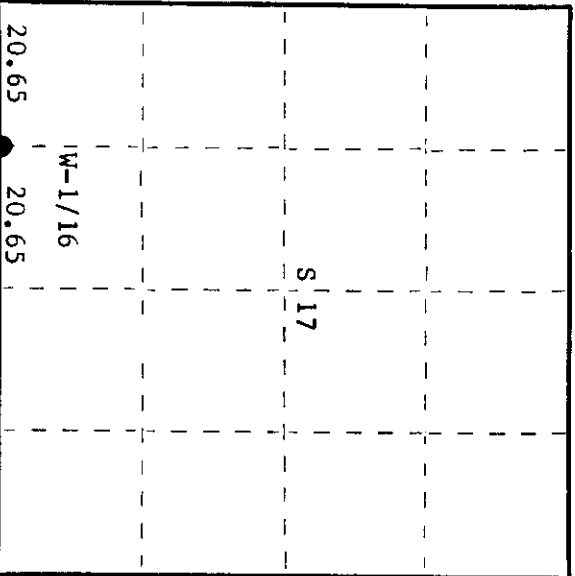

○ = Corner monument restored.

History of original corner establishment: Corner established by H.C. Lawrence, Registered Land Surveyor, in 1948. He ran a random line S88°E from the Section Corner 17-18, 19-20 which coincided with center line of old highway 8 for a distance of 14.00 chains. At 82.60 chains, he was 320 links north of white conservation post with location poster. Recovered white pine 16" with old scar facing post. Chopped into face to uncover scribe marks S20 BT. Growth rings to scribbling verified a date of 1938. Set 1/4 corner at 41.30 chains at S88°E as this position verified old fence line and cleared field. Set W-1/16 at 20.65 chains, 15 links north of center line.

Marked NBT's - White pine 16" S5°W 70-1/2 links.
 Description of corner evidence found:

Recovered Lawrence's point of witness post by measurements from his W. pine BT.
 Recovered OBT - W. pine 16" (18") S5°W 70.5 links scribed W-1/16 S20 BT.

Description of monument and accessories I established to perpetuate the original location of this corner.

Set a 1" x 18" iron pipe in roadbed of old Highway 8, 15 links south of west corner point as recovered. Set a 1" O.D. iron pipe for witness corner 50 links north of true corner. Projects 18" above ground and stamped -

NBT - Jack pine 11" S61°W 107.5 links scribed 1/16 BT. S498
 W. pine 18" S10°W 56.2 links scribed 1/16 BT. T36N R10E
 S 17
 W-1/16
 S 20 W.C.

Distances and bearings measured from true corner.
 Witness corner and NBT's painted blue.

S50 links
 1975

Dated at Rhineland, Wis., this 8th day of December, 1975.

Signature Phillip T. Hansen Title Registered Land Surveyor Registration No. S-498
 (County Surveyor, Registered Land Surveyor, or other duly authorized official)

Office of Register of Deeds, County of Oneida
 Instrument was filed in this office for record on the 4th day of December, 1975 at 1:00 o'clock P. M. I hereby certify that the within

Steven George Fricklin
 (Register of Deeds)

By _____ Deputy

3610170030

State of Wisconsin

County of Oneida } ss.

I, Philip T. Hansen, do hereby certify that on the 27th day

re-established the W 1/16 ~~corner~~ of sections 17 and 20

corner of Sections 17 and 20 Township 36 North, Range 10 East, Fourth Principal Meridian,

as described hereon; and that from this evidence I established a new monument and accessories as described hereon to perpetuate the original location of this corner.

Resident witnesses

Glen Barker

Jim Claflin

Herb Wagoner

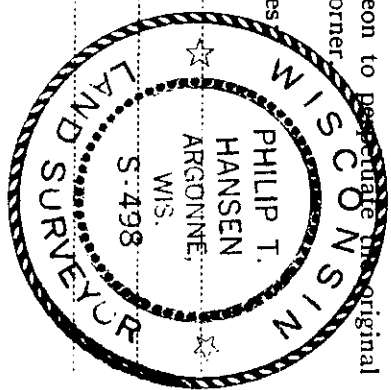

T36N R10E

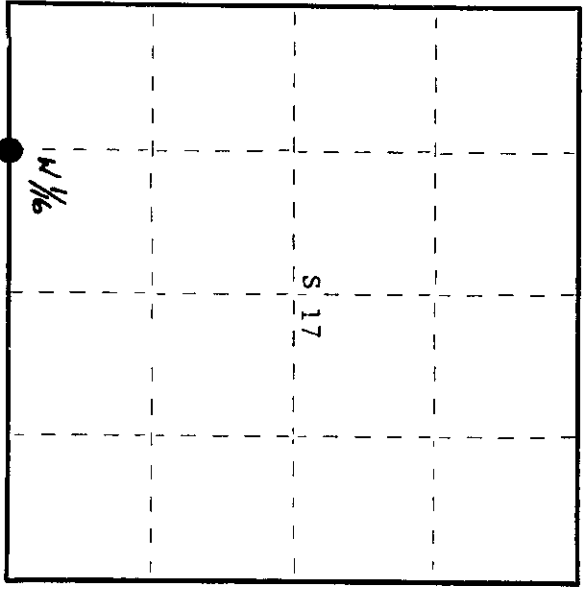

O = Corner monument restored.

CERTIFIED LAND CORNER RESTORATION

Supplement to N-6

Index No. N-6

History of original corner establishment:

Corner established by H.C. Lawrence, Registered Land Surveyor, in 1948. Corner remonumented by myself in 1975, resetting corner using his distance and bearing to old RT.

Description of corner evidence found:

Corner re-established by traverse and computation. Ran traverse from section corner 17, 18, 19 and 20 to 1/4 corner between sections 17 and 20. Computed distance is 2739.98 feet at bearing S 86° 33' 58" E, reset corner at 1369.99 feet intermediate, which point is 3' north of the centerline of old highway 8. Corrected position of computed corner is 3' north of Lawrence's old corner.

Description of monument and accessories I established to perpetuate the original location of this corner.

Drove a 1-1/2" x 18" iron pipe 3 foot north of the centerline of old highway 8, 4" below the surface for true corner. Reset old witness corner 50 links north, projecting 18" above surface. Cap is stamped:

New ties to old RT -
W. Pine 18" S4°E 58.3 links
B. Spruce 18" S43°W 78.7 links

S498
T36N R10E
W 1/16 S+17
S 50 lks.

Dated at Rhinelander, Wis., this 31st day of July, 1979

Signature: *Philip T. Hansen* Title: Registered Land Surveyor Registration No. S-498
(County Surveyor, Registered Land Surveyor, or other duly authorized official)

Office of Register of Deeds, County of Oneida, I hereby certify that the within instrument was filed in this office for record on the 27th day of August, 1979 at 10:00 o'clock M.

Signature: *Debra Inge Kurland*
(Register of Deeds)

By: Deputy

3610170030