

CERTIFIED LAND CORNER RESTORATION

Index No. R-6

State of Wisconsin

County of Oneida } ss.

I, Phillip T. Hansen, do hereby certify that on the 4th day of May, 1979, I ~~found~~ recovered the W 1/16 corner of Sections 20 & 29 Township 36, North, Range 10 East, Fourth Principal Meridian, as described hereon; and that from this evidence I established a new monument and accessories as described hereon to perpetuate the original location of this corner.

Resident witnesses:
Glen Barker
Jim Claflin
Herb Wagoner

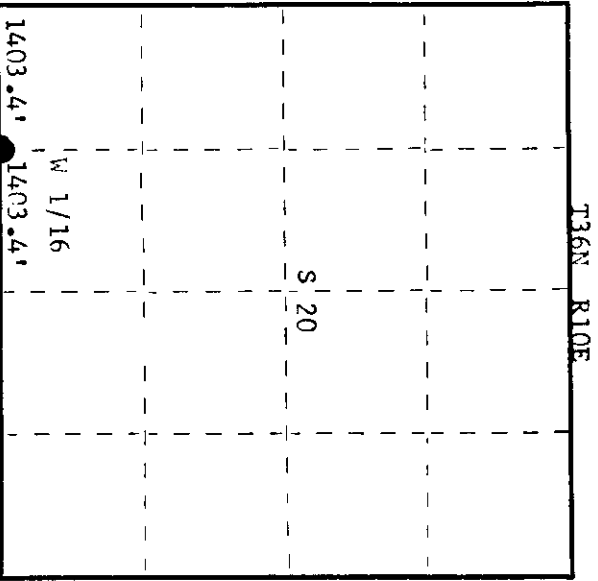
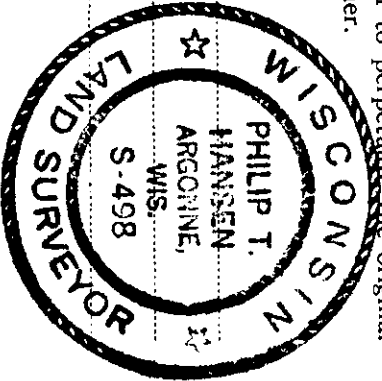

○ = Corner monument restored.

History of original corner establishment: This corner was established by H.C. Lawrence, Registered Land Surveyor, in 1946. He ran the W 1/2 of line between sections 20 and 29 and set the W 1/16 at 20.79 chains intermediate. On September 8, 1975, I recovered his post and his OBT, Maple 14" N4°E 30 links and replaced his post with a 1-1/2" iron pipe with 2" brass cap. On traversing around section 20 to compute the subdivision, discovered that H.C. Lawrence had dropped a chain in his measurements and the location of his corner was in error. We, therefore, removed this iron pipe and moved it to it's correct location.

Description of corner evidence found:

Corner established by traverse and computation. Computed distance from 1/4 corner to section corners 19, 20, 29 and 30 is 2806.80 at bearing N 89° 10' 13" E. Set W 1/16 at 1403.4' intermediate. H.C. Lawrence's corner bears N 82° E 34.05 feet from our position.

Description of monument and accessories I established to perpetuate the original location of this corner.

Removed the iron pipe set in 1975 to the correct position. Monument projects 18" above ground. Cap stamped.

Marked NBT's -

White Spruce N46°W 24.94 feet, scribed 1/16 BT.

Power Pole 36-10 - S88°E 108.72' (nail on south side).

S498 T36N R10E
 W 1/16 S 20
 CPI-1975

Dated at Rhinelander, Wis. this 14th day of May, 1979

Signature Phillip T. Hansen Title Registered Land Surveyor Registration No. S-498
 (County Surveyor, Registered Land Surveyor, or other duly authorized official)

Office of Register of Deeds, County of Oneida I hereby certify that the within instrument was filed in this office for record on the 18th day of June, 1979 at 2:00 o'clock P.M.

Dona George Kuehn
 (Register of Deeds)

By: _____ Deputy

3610200030

CERTIFIED LAND CORNER RESTORATION

Index No. **R 6**

State of Wisconsin

County of Oneida } ss.

I Philip T. Hansen do hereby certify that on the 8th day of September 19 75, I found evidence of the W-1/16 corner of Sections 20 and 29 Township 36 North, Range 10 East, Fourth Principal Meridian, as described hereon; and that from this evidence I established a new monument and accessories as described hereon to perpetuate the original location of this corner.

Resident witnesses:
Glen Barker
Jim Clafin

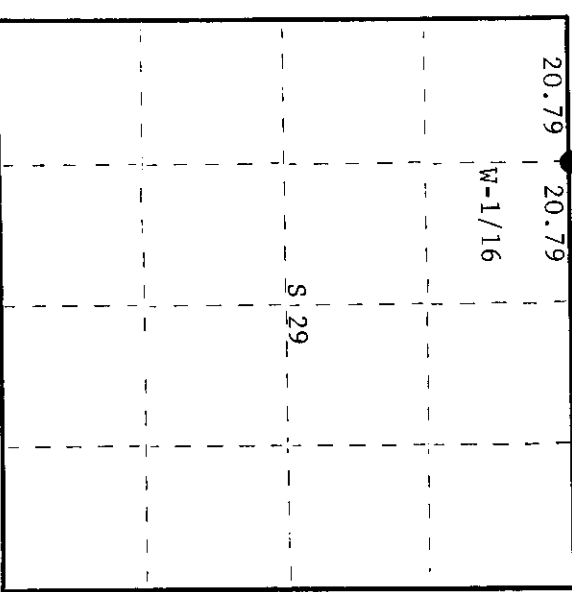
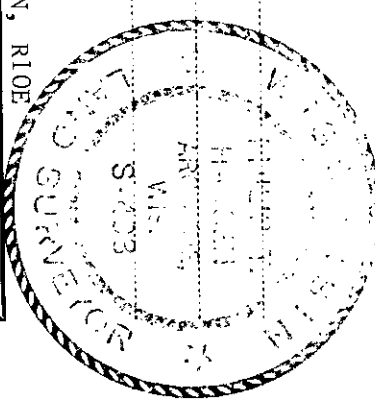

O = Corner monument restored.

History of original corner establishment:
Corner established by H.C. Lawrence, Registered Land Surveyor, in 1946. Set a 4" tamarack post at 62.37 chains West of section corners 20, 21, 28, and 29 equidistant between 1/4 corner and section corners 19, 20, 29, and 30 from which maple 14" bears N4°E, 30 links.

Description of corner evidence found:
Recovered 4" tamarack post, squared and scribed W-1/16 S20, W-1/16 S29, in poor condition with a rock cairn around the base.
Recovered ORT maple 14", N4°E, 30 links, scribed W-1/16 S20, BT.

Description of monument and accessories I established to perpetuate the original location of this corner.
Replaced 4" tamarack with 1 1/2" OD iron pipe with 2" brass cap stamped - S498
NBT jack pine 10", N79°W, 108 links, scribed 1/4 BT. T36N, R10E
Highline pole 3610-20L10, S82°E, 113 links. W-1/16 S | 20 S | 29
CPI-1975

Dated at Rhinelander, Wis., this 19th day of September, 1975

Signature: *Philip T. Hansen* Title: Registered Land Surveyor Registration No. S-498
(County Surveyor, Registered Land Surveyor, or other duly authorized official)

Office of Register of Deeds, County of Oneida
Instrument was filed in this office for record on the 17th day of September 1975
at 10:30 o'clock A.M.

Donna Savage
(Register of Deeds)

By: Deputy

3610200030