

CERTIFIED LAND CORNER RESTORATION

Index No. Q-8

State of Wisconsin

County of Oneida } ss.

I Phillip T. Hansen do hereby certify that on the 2nd day of April, 1979, I ~~found~~ ~~restored~~ the SE 1/16 corner of Section 20 Township 36 North, Range 10 East, Fourth Principal Meridian, as described hereon; and that from this evidence I established a new monument and accessories as described hereon to perpetuate the original location of this corner.

Resident witnesses:
Glen Barker
Jim Claffin
Herb Wagoner

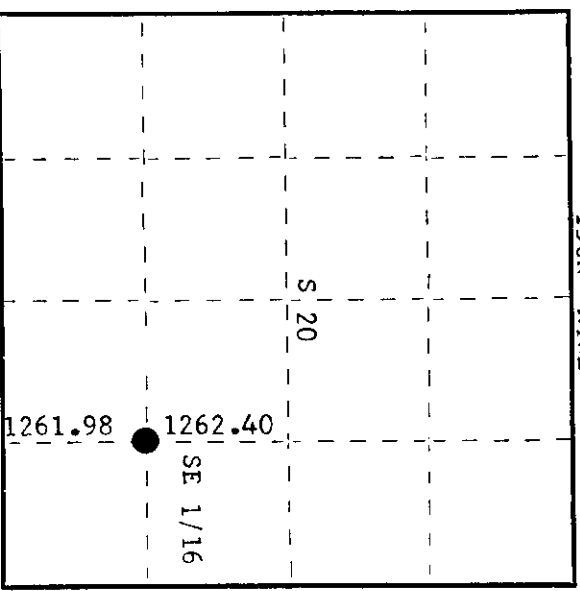
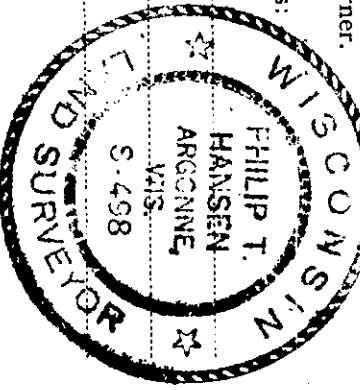

○ = Corner monument restored.

History of original corner establishment:
No records of any previous survey.

Description of corner evidence found:
No evidence of any corner recovered. Corner established by traverse and computation. Computed distance from E 1/16, Section 20 and 29, to EC 1/16 Section 20 is 2524.38 feet at N 1° 01' 21" W. Computed location of SE 1/16 at 1261.98' N 1° 01' 21" W of E 1/16 and 1262.40' S 1° 01' 21" E of SC 1/16.

Description of monument and accessories I established to perpetuate the original location of this corner.
Set a 1-1/2" iron pipe with 2" brass cap, projecting 18" above ground, stamped:
Marked NBT's -
Jack Pine 8" N24°W 24.09 feet, scribed 1/16 BT. S498
Jack Pine 10" N82°E 12.55 feet, scribed 1/16 BT. T36N R10E
SE 1/16 S+20

Dated at Rhineland, Wis., this 14th day of May, 1979

Signature: Phillip T. Hansen Title: Registered Land Surveyor Registration No. S-498
(County Surveyor, Registered Land Surveyor, or other duly authorized official)
Office of Register of Deeds, County of Oneida, 21st day of May, 1979
I hereby certify that the within instrument was filed in this office for record on the 20th day of May, 1979 at 2:05 o'clock P.M.

Deputy Register of Deeds: Dennis George Fischer

By: Deputy

3610201010