

CERTIFIED LAND CORNER RESTORATION

Index No. Q-7

State of Wisconsin

County of Oneida } ss.

I Phillip T. Hansen, do hereby certify that on the 3rd day established March, 1979, I ~~found~~ found ~~restored~~ the SC 1/16 corner of Section 20 Township 36, North, Range 10 East, Fourth Principal Meridian, as described hereon; and that from this evidence I established a new monument and accessories as described hereon to perpetuate the original location of this corner.

Resident witnesses:
Glen Barker
Jim Claffin
Herb Wagoner

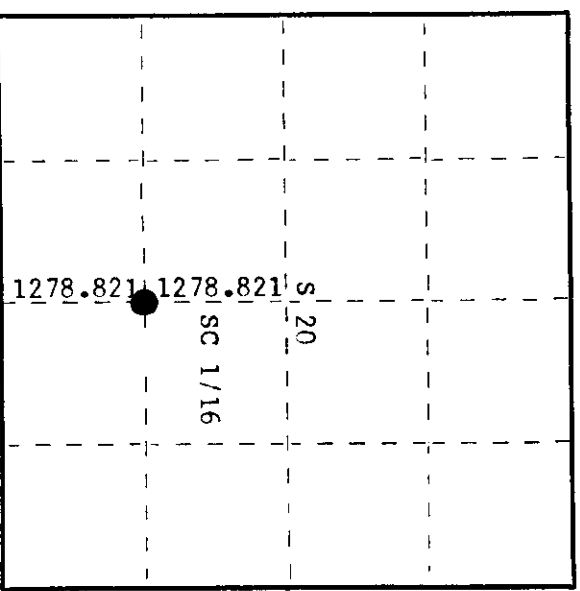
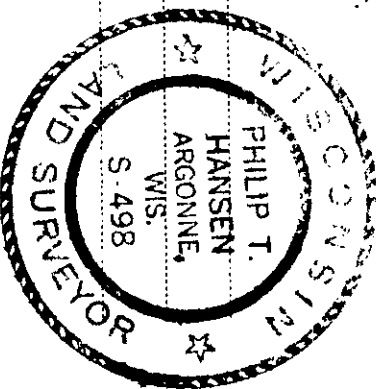

O = Corner monument restored.

History of original corner establishment:
No records of any previous survey.

Description of corner evidence found:
No evidence of any corner recovered. Corner established by traverse and computation. C 1/4 established at 2557.642' N 0° 24' 39" E of S 1/4 corner. SC 1/16 established at 1278.921 feet N 0° 21' 39" E of S 1/4 corner intermediate.

Description of monument and accessories I established to perpetuate the original location of this corner.
Set 1-1/2" iron pipe with 2" brass cap, stamped:
Monument projects 18" above ground.
Marked NBT's -
Sugar 6" S69°E 35.30 feet, scribed 1/16 BT.
HI line pole #319 S50°W 94.58 feet (nail on east side).
S498
T36N R10E
SC 1/16 S 20
CPI-1979

Dated at Rhinelander, Wis., this 8th day of May, 1979.
Signature: Phillip T. Hansen Title: Registered Land Surveyor Registration No. S-498
(County Surveyor, Registered Land Surveyor, or other duly authorized official)

Office of Register of Deeds, County of Oneida.
Instrument was filed in this office for record on the 14th day of May, 1979 at 3:30 o'clock P.M.
Doris Lange Kuhn
(Register of Deeds)

By Doris Lange Kuhn Deputy

3610201020