

CERTIFIED LAND CORNER RESTORATION

Index No. **P-9**

State of Wisconsin

County of Oneida } ss.

I Phillip T. Hansen, do hereby certify that on the 1st day of December, 1975, I found evidence of the Quarter corner of Section 20 and 21 Township 36, North, Range 10 East, Fourth Principal Meridian, as described hereon; and that from this evidence I established a new monument and accessories as described hereon to perpetuate the original location of this corner.

Resident witnesses:

Glen Barker

Jim Claflin

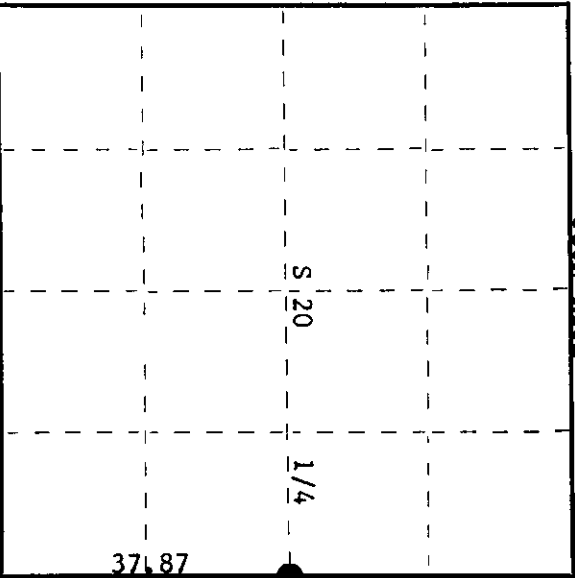
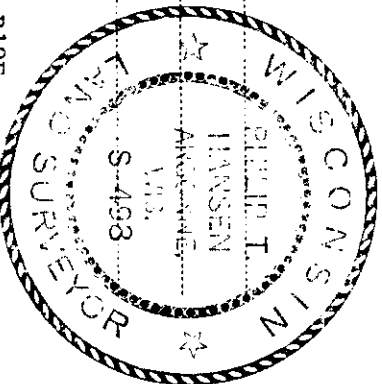

○ = Corner monument restored.

History of original corner establishment: Original corner established by William E. Dougherty, Deputy Surveyor, in 1863 from which white pine 10" bears N75°W, 25 links and white pine 12" bears N44°E, 26 links. Corner recovered by B.F. Dorr, County Surveyor. Corner recovered by H.C. Lawrence, Registered Land Surveyor, in 1948. Found the remains of old burnt stump with scribe marks, due South 36 links. Through searching uncovered an old casing from tire pump and a point of an old squared stake buried in the ground.

Set new tamarack post and marked NBT's - White pine 9" East 45 links
White pine 9" N27°W 29-1/2 links

Description of corner evidence found: Recovered 5" tamarack post, squared and scribed 1/4S S20, 1/4S S21, in very poor condition.

Recovered OBT - White pine 9" (17") East 45 links scribing grown over.
White pine 9" (12") N27°W 29.5 links scribed 1/4S S20, BT

Description of monument and accessories I established to perpetuate the original location of this corner.

Replaced 5" tamarack post with 2-1/2" iron pipe with brass cap stamped - S498
Pipe projects 24" above ground. T36N R10E

NBT - Jack pine 9" S29°E 30.3 links scribed 1/4 BT 1/4 S20S21

Pipe and BT's painted blue.

CPI-1975

Dated at Rhinelander, Wis., this 8th day of December, 1975.

Signature Phillip T. Hansen Title Registered Land Surveyor Registration No. S-498
(County Surveyor, Registered Land Surveyor, or other duly authorized official)

Office of Register of Deeds, County of Oneida. I hereby certify that the within instrument was filed in this office for record on the 4th day of December, 1976 at 1:00 o'clock P.M.

Marie Emma Kuehn
(Register of Deeds)

By _____ Deputy

3610202000