

CERTIFIED LAND CORNER RESTORATION

Index No. 0-9

State of Wisconsin

County of Oneida } ss.

I, Philip T. Hansen, do hereby certify that on the 19th day of June, 1979, I found

established the N 1/16 corner of Sections 20 - 21

Township 36, North, Range 10 East, Fourth Principal Meridian,

as described hereon; and that from this evidence I established a new monument and accessories as described hereon to perpetuate the original location of this corner.

Resident witnesses:

Glen Barker

Jim Claffin

Herb Wagoner

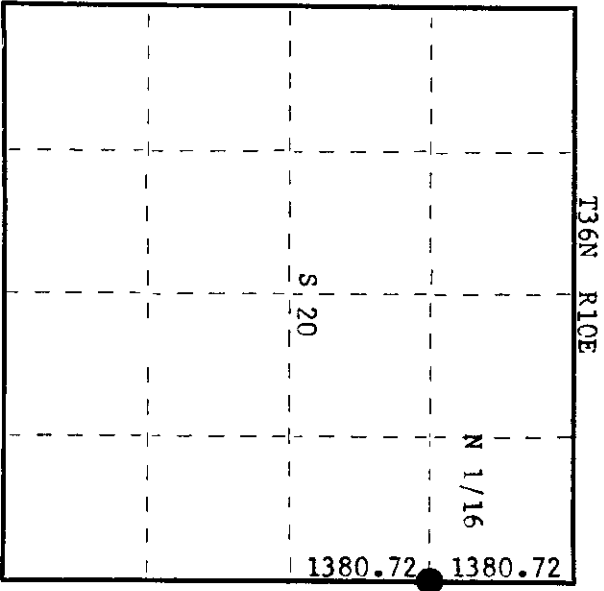
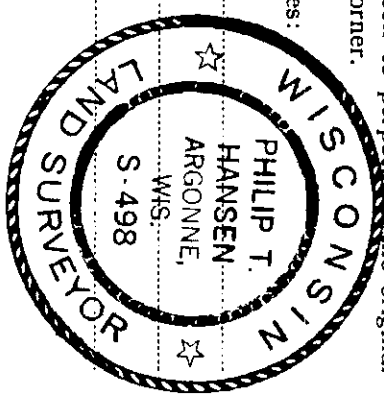

○ = Corner monument restored.

History of original corner establishment:

H. C. Lawrence, Registered Land Surveyor, set a corner here in 1948. Ran a random line north from 1/4 corner and at 41.95 intersected his corrected line 4.02 chains west of section corner. He set his N 1/16 at 20.87-1/2 chains 201 links east. Marked Spruce Pine 9" N33°E 96 links.

Description of corner evidence found:

In order to subdivide section 20 and establish the NE 1/16 we traversed the NE 1/4. Computed distance from section corner 16, 17, 20 and 21 to 1/4 corner is 2761.444 feet at bearing S 2° 49' 43" W. Set the N 1/16 at 1380.72 feet intermediate. True corner falls on a large boulder on the north edge of Haymeadow Creek.

Description of monument and accessories I established to perpetuate the original location of this corner.

Set a 1-1/2" iron pipe with 2" brass cap for witness corner 2' north.

Monument projects 2-1/2' - cap stamped:

Marked NPI's - to true corner:

Jack Pine N28°W 68.5 feet, scribed 1/16 BT.

Jack Pine 9" N35°E 69.90 feet, scribed 1/16 BT.

H.C. Lawrence's N 1/16 post bears N14°E 17.89 feet from our corner. S 2 ft. CPI-1979

Dated at Rhineland, Wis., this 26th day of June, 1979.

Signature Philip T. Hansen Title Registered Land Surveyor Registration No. S-498
(County Surveyor, Registered Land Surveyor, or other duly authorized official)

Office of Register of Deeds, County of Oneida, I hereby certify that the within instrument was filed in this office for record on the 7th day of August, 1979 at 1:00 o'clock P. M.

Signature Donna Lawrence
(Register of Deeds)

By Donna Lawrence Deputy

3610203000