

CERTIFIED LAND CORNER RESTORATION

Index No. 0-6

State of Wisconsin

County of Oneida } ss.

History of original corner establishment:  
No records of any survey.

I Phillip T. Hansen, do hereby certify that on the 26th day of July, 1979, I found ~~records~~ established the NW 1/16 corner of Section 20, Township 36, North, Range 10 East, Fourth Principal Meridian, as described hereon; and that from this evidence I established a new monument and accessories as described hereon to perpetuate the original location of this corner.

Resident witnesses:  
Glen Barker  
Jim Claflin  
Herb Wagoner

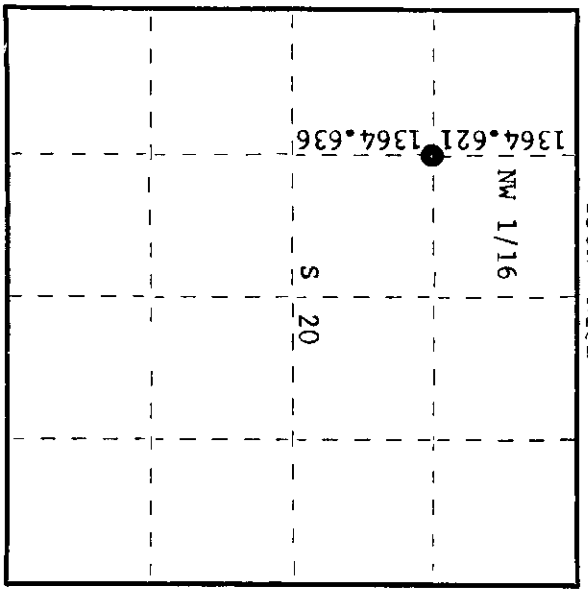
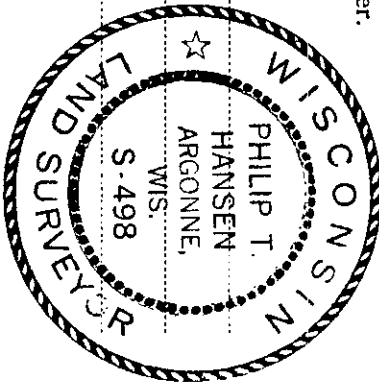

○ = Corner monument restored.

Description of corner evidence found:  
No evidence of any corner recovered. Corner established by traverse and computation. Computed distance from the W 1/16 between sections 17 and 20 to the WC 1/16 is 2729.257 feet at bearing S 1° 08' 12" W. Computed location of NW 1/16 is 1364.681 feet from W 1/16 and 1364.636 feet from WC 1/16.

Description of monument and accessories I established to perpetuate the original location of this corner.  
Set 1-1/2" iron pipe with 2" brass cap, projecting 24" - stamped:  
Marked NBT's -  
Jack Pine 6" N32°E 14.50 feet  
Jack Pine 6" S76°E 35.65 feet  
both scribed 1/16 BT.  
S498  
T36N R10E  
NW 1/16 S 20  
CPI-1979

Dated at Rhinelander, Wis., this 7th day of August, 1979.

Signature Phillip T. Hansen Title Registered Land Surveyor Registration No. S-498  
(County Surveyor, Registered Land Surveyor, or other duly authorized official)

Office of Register of Deeds, County of Oneida.  
I hereby certify that the within instrument was filed in this office for record on the 27th day of August, 1979 at 10:00 o'clock P. M.

Signature Dana Frank Kurlin  
(Register of Deeds)

By: \_\_\_\_\_ Deputy

3610203030