

CERTIFIED LAND CORNER RESTORATION

Index No. R-12

State of Wisconsin }
County of Oneida } ss.

History of original corner establishment:
No records of any previous survey.

I Philip T. Hansen, do hereby certify that on the 7th day of May, 1979, I found established ~~restored~~ the E 1/16 corner of Section 21 & 28 Township 36N, North, Range 10 E, Fourth Principal Meridian, as described hereon; and that from this evidence I established a new monument and accessories as described hereon to perpetuate the original location of this corner.

Description of corner evidence found:

No evidence of any corner recovered.
Corner established by traverse and computation. Ran traverse from section corner 21, 22, 27 and 28 to section corner 20, 21, 28 and 29. Computed distance 5470.295 feet at bearing S 89° 55' 13" W. Set 1/4 corner at 2735.147 feet intermediate. Established E 1/16 at 1367.573 intermediate between 1/4 corner and section corner 21, 22, 27 and 28.

Resident witnesses:
Glen Barker
Jim Claffin
Herb Wagoner

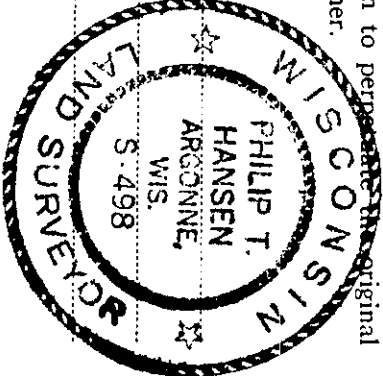

Description of monument and accessories I established to perpetuate the original location of this corner.

Set 1-1/2" iron pipe with 2" brass cap projecting 24" - cap stamped:
Marked NBT's -
Black Spruce 10" N66°W 30.32' scribed 1/16 BT. S498
Black Ash N36°E 29.93 feet, scribed 1/16 BT. E 1/16 S+21
CPI - 1979

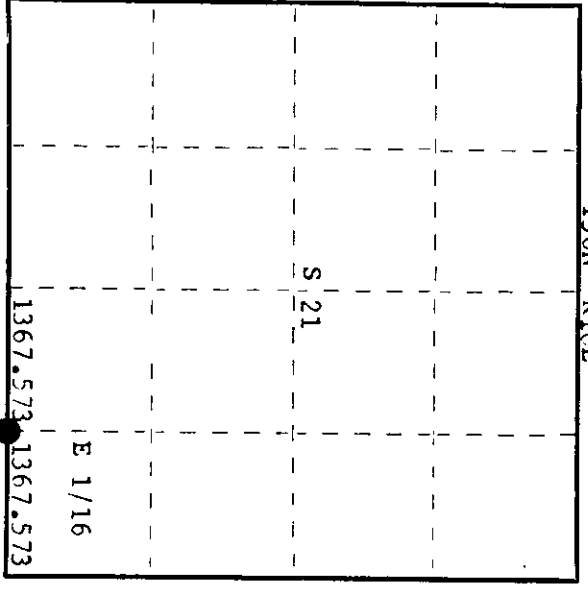

○ = Corner monument restored.

Dated at Rhineland, Wis., this 14th day of May, 19 79.

Signature Philip T. Hansen Title Registered Land Surveyor Registration No. S-498
(County Surveyor, Registered Land Surveyor, or other duly authorized official)

Office of Register of Deeds, County of Oneida. I hereby certify that the within instrument was filed in this office for record on the 21st day of May, 19 79 at 2:00 o'clock P. M.

Terrie Leauge Tucker
(Register of Deeds)

By Terrie Leauge Tucker Deputy

3610210010