

CERTIFIED LAND CORNER RESTORATION

Index No. 0-23

State of Wisconsin

County of Oneida

} ss.

I Phillip T. Hansen

certify that on the 31st day

of December, 1976, I found

evidence of the NC 1/16

corner of Section 24

Township 36, North, Range

10 East, Fourth Principal Meridian,

as described hereon; and that from this evidence I established a new monument and accessories as described hereon to perpetuate the original location of this corner.

Resident witnesses:

Glen Barker

Jim Clarlin

Herb Wagoner

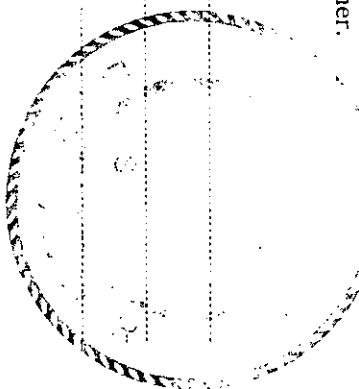

T36N R10E

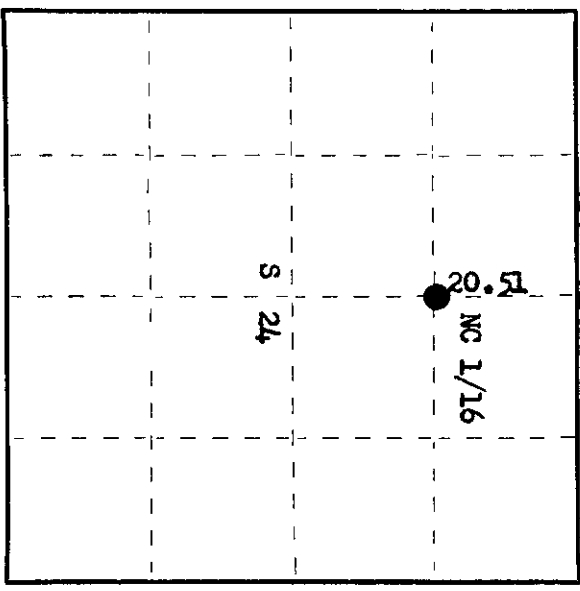

History of original corner establishment:

Corner established by D.H. Vaughan, County Surveyor, in 1910. Set post and marked BTs - White Pine 20" N 45° W 20 1/2 links and White Pine 18" S 26° E 14 links.

Corner recovered by H.C. Lawrence, Registered Land Surveyor, in 1947. Recovered Vaughan's BT. Set new post.

Description of corner evidence found:

Recovered Lawrence's 6" cedar post, squared and scribed ON 1/16 S24 in poor condition.

Recovered OBTS - Vaughan's White Pine 18" S 26° E 14 links, now a decaying stump, scribing visible.

Description of monument and accessories I established to perpetuate the original location of this corner.

Replaced 6" cedar post with 1 1/2" OD iron pipe with 2" brass cap, stamped:

Monument projects 24" above ground.

NBTs - Maple 5" S 66° W 11.3 links, scribed 1/16 BT.

Maple 7" N 62° W 56.8 links, scribed 1/16 BT.

S498

T36N R10E

NC 1/16 S 1/24

CP1-1976

Dated at Rhineland, Wis., this 19th day of January, 1977

Signature Phillip T. Hansen Title Registered Land Surveyor Registration No. S498
(County Surveyor, Registered Land Surveyor, or other duly authorized official)

Office of Register of Deeds, County of Oneida
Instrument was filed in this office for record on the 24th day of February, 1977
at 100 o'clock P. M.

Dorcas Virginia Tucker
(Register of Deeds)

By Dorcas Virginia Tucker Deputy

3610243020