

CERTIFIED LAND CORNER RESTORATION

Index No. **S-21**

State of Wisconsin } ss.
 County of Oneida }

I Phillip T. Hansen, do hereby certify that on the 20th day of July, 1976, I found evidence of the N 1/16 corner of Section 25 and 26 Township 36 North, Range 10 East, Fourth Principal Meridian, as described hereon; and that from this evidence I established a new monument and accessories as described hereon to perpetuate the original location of this corner.

Resident witnesses:

Jim Clafflin
 Herb Argoner

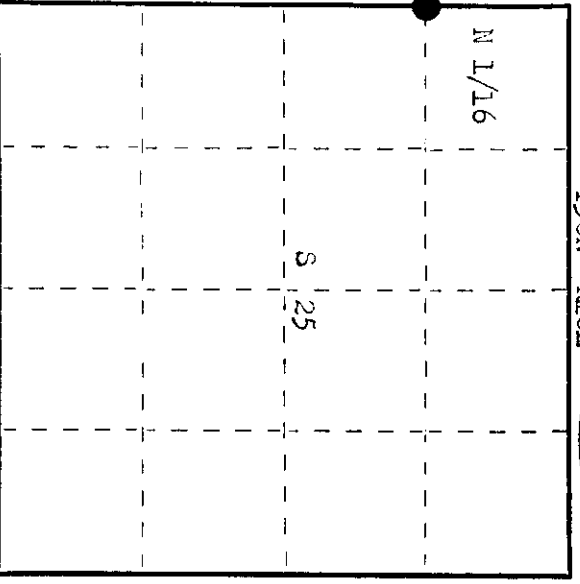
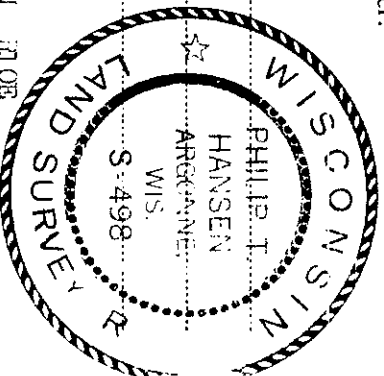

○ = Corner monument restored.

History of original corner establishment: Corner established by J.H. Vaughan, County Surveyor, in 1905. Made Tarrack 10" scribed for corner and marked Tarrack 12" S 40° W 16 for BT.

Corner recovered by H.C. Lawrence, Registered Land Surveyor, in 1950. Recovered 10" Tarrack, now a stub and Tarrack 12" S 40° W 16 lks.

Set new post beside Tarrack 12" and marked BT - Cedar 10" N 70° W 154 lks.

Description of corner evidence found:

Recovered 5" squared cedar post, scribed N 1/16 S 25 N 1/16 S 26 in fair condition.

Recovered BT - Cedar 10" N 70° W 154.0 lks, scribed N 1/16 S 27, MBT. Tarrack stub, 12" S 40° W 16 lks, badly decayed.

Description of monument and accessories I established to perpetuate the original location of this corner.

Replaced 5" cedar post with 1 1/2" iron pipe with brass cap stamped.

Monument projects 20" above ground. BT - Cedar 10" S 27° W 85.6 lks, scribed 1/16 BT. N 1/16 26 25 T36N R10E

GPI-1976

Dated at Rhineland, Wis., this 19th day of August, 1976

Signature *Phillip T. Hansen* Title Registered Land Surveyor Registration No. S-498
 County Surveyor, Registered Land Surveyor, or other duly authorized official

Office of Register of Deeds, County of Oneida
 Instrument was filed in this office for record on the 22nd day of September, 1976 at 1:00 o'clock P.M.

James W. Berger
 (Register of Deeds)

By _____ Deputy

3610263000