

CERTIFIED LAND CORNER RESTORATION

Index No. T-17

State of Wisconsin }  
 County of Oneida } ss.

I Philip T. Hansen, do hereby certify that on the 18th day of November, 1975, I found evidence of the Quarter corner of Sections 26 and 27 Township 36, North, Range 10 East, Fourth Principal Meridian, as described hereon; and that from this evidence I established a new monument and accessories as described hereon to perpetuate the original location of this corner.

Resident witnesses:

Glen Barker

Jim Claflin

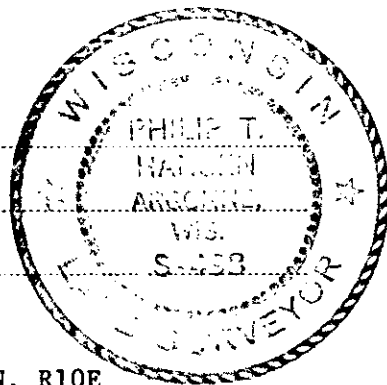

T36N, R10E

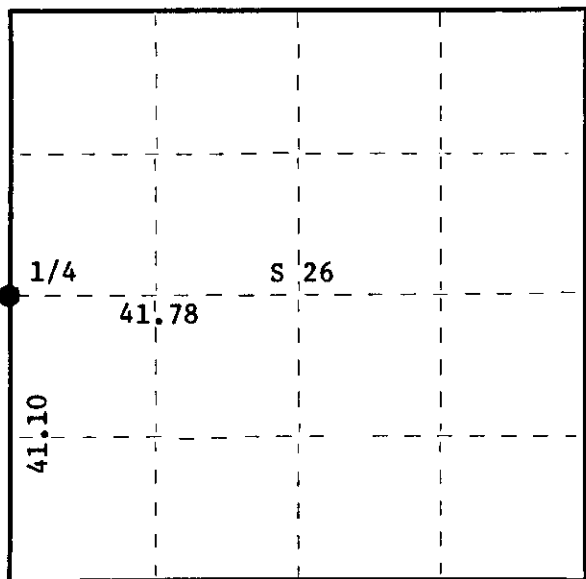

○ = Corner monument restored.

History of original corner establishment:

Corner established by Wm. E. Dougherty, Deputy Surveyor, in 1863, from which birch 10" bears S38°W, 19 lks. and hemlock 12" bears N45°E, 12 lks. Corner re-established by D.H. Vaughan, County Surveyor, in 1900. Corner searched for by H.C. Lawrence, Registered Land Surveyor, in 1947, was unable to locate corner or BT's.

Re-established corner. Ran random line from SW corner to NW corner, which had been re-covered by Vaughan, and were still intact. Set 1/4 corner at 41.10 chains North of SW corner and 41.78 chains West of Vaughan's C-1/4 corner. Set 4" cedar post. No record of NBT's set.

Description of corner evidence found:

Recovered 4" cedar post, squared and scribed 1/4S S26, 1/4S S27 in poor condition. Also a 1" iron pipe beside it painted red. No OBT's recovered.

Description of monument and accessories I established to perpetuate the original location of this corner.

Replaced 4" cedar post with 2-1/2" iron pipe with brass cap stamped -  
 Pipe projects 24" above ground.  
 NBT's - Maple 6" N28°E 28 lks. scribed 1/4 BT  
           Maple 6" S40°W 34.5 lks. scribed 1/4 BT  
 Pipe and NBT's painted blue.

S498  
 T36N, R10E

S27 | S26  
 1/4 |

CPI-1975

Dated at Rhineland, Wis., this 1st day of December, 1975

Signature Philip T. Hansen Title Registered Land Surveyor Registration No. S-498  
 (County Surveyor, Registered Land Surveyor, or other duly authorized official)

Office of Register of Deeds, County of Oneida, I hereby certify that the within instrument was filed in this office for record on the 4th day of June, 1976 at 10:00 o'clock P. M.

Doris Verage Kuehn  
 (Register of Deeds)

By.....Deputy

FORM 985 Wisconsin Planning Survey Co. Madison, Wisconsin

3610272000

# U.S. PUBLIC LAND SURVEY MONUMENT RECORD

Note: This form is intended and designed to fulfill all requirements of Wisconsin Administrative Code, Chapter A-E 7.08 U.S. Public Land Survey Monument Record (3)(a-i).

(a) CORNER LOCATION  
 1/4 Cor. of Secs. 26 & 27  
 Township 36 North  
 Range 10 East of the 4th P.M.  
 Town of Monico  
 County of Oneida

WISCRS - Oneida County  
 N: 143,584.88 USft  
 E: 313,738.38 USft  
 Datum: NAD 83(2011)  
 GNSS Method: RTN - Offset  
 GNSS Control: WISCORS VRS

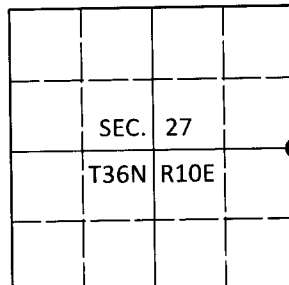

(b) HISTORY OF ORIGINAL CORNER ESTABLISHMENT

Original Surveyor:

Original Accessories:

Date of Survey    Commenced:  
    Completed:

See previous monument record(s)

(b)(f)(g)(h) Description of monument found at this corner and if it was accepted, state all evidence (material, testimonial, occupational, plats, records, other monuments) used as a basis for accepting. If not accepted or if nothing was found, state evidence used as basis for establishing location. If re-established through lost corner proportionate methods, indicate all monuments, distances and directions used to establish. Indicate type of monument and sign post found or set.

*This is a perpetuation of the following monument record(s) that comprise a complete history of the corner:*

*Dec. 1, 1975: Certified Land Corner Restoration No. 3610272000 by Philip T. Hansen, PLS*

*July 20, 2019: I found and accepted the record monument, a 2.4" diam. iron pipe with a 2.4" diam. brass cap projecting 24" above the ground surface. All of the record bearing trees are gone. I found or established accessories as shown below. I set a white vinyl sign post bearing Southeast, 0.7 ft.*

*The coordinate value shown has been verified by at least one of the following methods: 1) comparison to a previously GPS determined published value; 2) the value is the average of two or more GPS observations at a markedly different time; 3) one or more distances were measured back to the GPS observed corner from temporary GPS observed offset locations.*

(c)(d)(e) Plan view of corner with ties to at least 4 witness monuments. If in disagreement with previously established corner, show the distances between the two corners and also indicate the ties to the disputed.

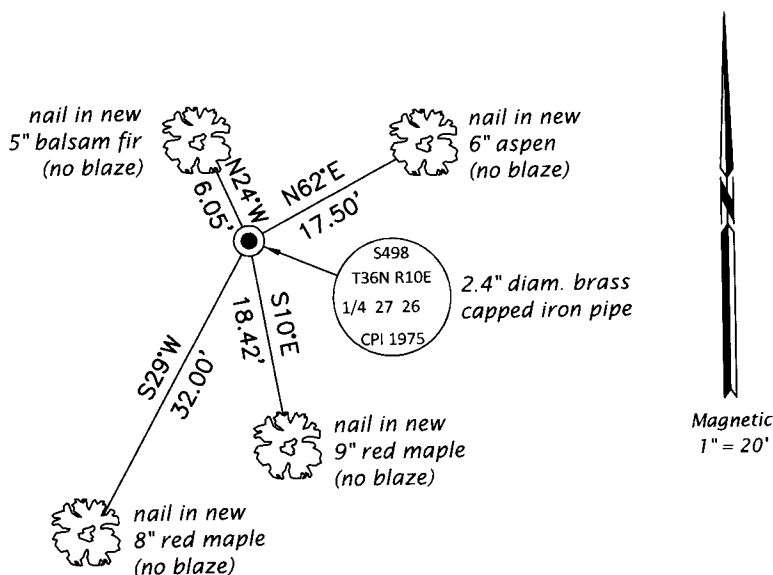

REGISTER OF DEEDS OFFICE  
 ONEIDA COUNTY  
 FILED

JAN 03 2020

KYLE J. FRANSON  
 REGISTER OF DEEDS

(i) I, Jeffrey W. Austin, Professional Land Surveyor No. S-1885, hereby certify that the corner location on this record was determined by me or under my direction and control and that this U.S. Public Land Survey Monument Record is correct and complete to the best of my knowledge and belief.

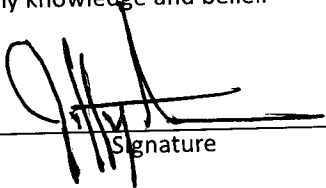
  
 Signature

DEC 23, 2019  
 Date