

CERTIFIED LAND CORNER RESTORATION

Index No. S-13

State of Wisconsin

County of Oneida } ss.

History of original corner establishment:
No records of this corner having been previously set.

I, Philip T. Hansen, do hereby certify that on the 27th day of July, 1979, I ~~restored~~ established the corner of Sections 27 and 28 Township 36 North, Range 10 East, Fourth Principal Meridian, as described hereon; and that from this evidence I established a new monument and accessories as described hereon to perpetuate the original location of this corner.

Resident witnesses:
Glen Barker
Jim Claflin
Herb Wagoner

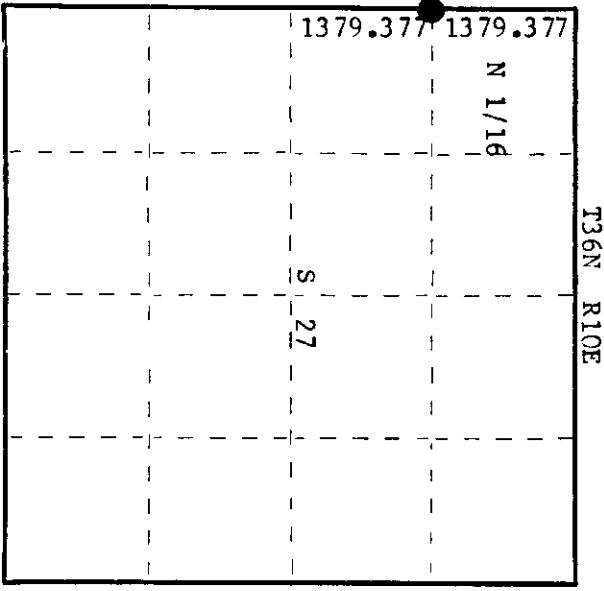
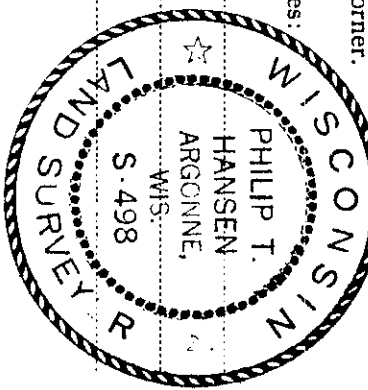

O = Corner monument restored.

Description of corner evidence found:

No evidence of any corner recovered.
Corner established by traverse and computation. Ran traverse south from previously recovered section corner 21, 22, 27 and 28 to 1/4 corner between sections 27 and 28. Computed distance is 2759.75 feet at bearing S 1° 52' 45" E.
Set N 1/16 at 1379.977 feet intermediate.

Description of monument and accessories I established to perpetuate the original location of this corner.

Set 1-1/2" iron pipe with 2" brass cap projecting 18" - stamped:
Marked NBT's -
Black Spruce 8" N87°W 22.45'
White Spruce 10" S62°E 41.80' scribed 1/16 RT.

S498
T36N R10E
N 1/16 S28 + S27
CPI-1979

Dated at Rhinelander Wis., this 31st day of July, 1979

Signature: *Philip T. Hansen* Title: Registered Land Surveyor Registration No. S-498.
(County Surveyor, Registered Land Surveyor, or other duly authorized official)

Office of Register of Deeds, County of Oneida
Instrument was filed in this office for record on the 7th day of August, 1979 at 1:00 o'clock P.M.

Debra K. Finkbeiner
(Register of Deeds)

By: Deputy

3610283000