

CERTIFIED LAND CORNER RESTORATION

Index No. **V-8**

State of Wisconsin

County of Oneida } ss.

I Phillip T. Hansen, do hereby certify that on the 30th day of July, 1976, I found evidence of the E 1/16 corner of Section 29 and 32 Township 36, North, Range 10 East, Fourth Principal Meridian, as described hereon; and that from this evidence I established a new monument and accessories as described hereon to perpetuate the original location of this corner.

Resident witnesses:

- Glen Barker
- Jim Clarlin
- Herb Wagoner

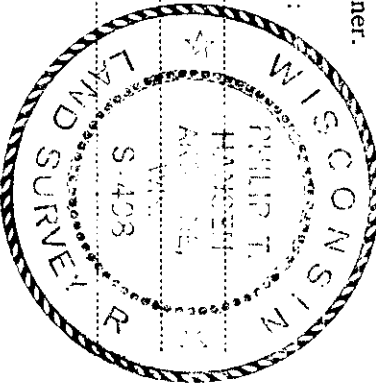

T36N R10E

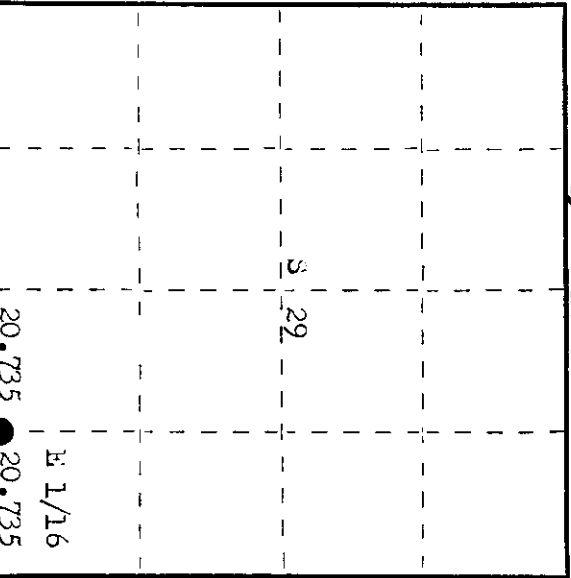

○ = Corner monument restored.

History of original corner establishment: Corner established by Hippo Surveyor, Drivas, in 1963. Ran random line west (S 88° 12' 58" W) from recovered section corner 28, 29, 32 and 33, closing out 375 chains North of H.C. Lawrence's quarter corner.

Set E 1/16, 18-3/4 lks south at 20.735 chains, equidistant.

Marked NBTs - Black Spruce 5" N 48° E 42 1/2 lks.  
Black Spruce 5" S 63° W 38 lks.

Description of corner evidence found:

Recovered 1" iron pipe with alloy cap, not scribed.  
Recovered OBTs - Black Spruce 5" (7") N 48° E (N 44° E) 42.5 lks, scribed E 1/16 BT.  
Black spruce 5" (7") S 63° W (S 68° W) 38 lks, scribed E 1/16 BT.

Description of monument and accessories I established to perpetuate the original location of this corner.  
Removed iron pipe from ground, installed cross bar and replaced it in same hole.  
Stamped monument which projects 18" above ground.  
No additional accessories established.

S498  
T36N R10E  
E 1/16 S 29  
S 32  
CPI-1976

Dated at Chineland, Wis., this 17th day of August, 1976.

Signature: Phillip T. Hansen Title: Registered Land Surveyor Registration No. 2498  
(County Surveyor, Registered Land Surveyor, or other duly authorized official)

Office of Register of Deeds, County of Oneida.  
Instrument was filed in this office for record on the 23rd day of September, 1976 at 1:00 o'clock P. M.

Debra Seeger Kuchan  
(Register of Deeds)

By: \_\_\_\_\_ Deputy

3610290010