

CERTIFIED LAND CORNER RESTORATION

Index No. **V 7**

State of Wisconsin

County of Oneida } ss.

I, Phillip T. Hansen, do hereby certify that on the 13th day of September, 1975, I found evidence of the Quarter corner of Sections 29 and 32 Township 36 North, Range 10E, Fourth Principal Meridian, as described hereon; and that from this evidence I established a new monument and accessories as described hereon to perpetuate the original location of this corner.

Resident witnesses:

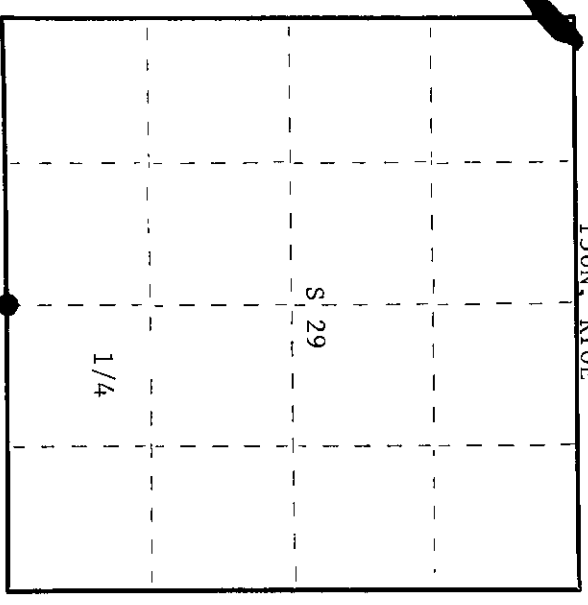
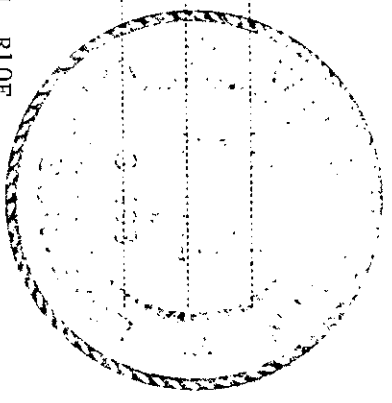

○ = Corner monument restored.

3610290020

History of original corner establishment:

Original corner established by Wm. E. Dougherty, Gov. Deputy Surveyor, in 1863 from which W. pine 10" bears S19°W 5 links and cedar 8" bears N49°E 19 links. Corner recovered by D.H. Vaughan, County Surveyor, in 1897. He established corner and found old point from original BT's. Corner recovered by H.C. Lawrence, Reg. Land Surveyor, in 1947. Recovered OBT's - stumps of original W. pine and cedar. Opened up and found old scribe marks on cedar. Found 1/4S and BT marks. Set new post from original BT's and made NBT's - Cedar 14" S-22-1/2°E 92-1/2 links and maple 14" S43°W 57 links.

Description of corner evidence found:

Recovered 2" iron pipe with brass plate scribed - Also found Lawrence's scribed post lying on the ground.

Recovered OBT. Original W. pine 10" stump S19°W 5 links. Lawrence had refaced and rescribed it.

Original cedar 8" N49°E 19 links. Now a decayed stump. Ripco

Maple 14" (15") S43°W (S48°W) 57 links scribed 1/4S NBT.

Cedar 14" S22-1/2°E (S20°E) 92.5 links scribed 1/4 S32 NBT.

Description of monument and accessories I established to perpetuate the original location of this corner. The Ripco iron pipe was straight and set firmly in the ground, so left it as is.

NBT Red maple 12" S63°E 62.2 links Scribed 1/4 BT

Dated at Rhinelander Wis., this 22nd day of September, 1975.

Signature *Phillip T. Hansen* Title, Registered Land Surveyor Registration No. S-498 (County Surveyor, Registered Land Surveyor, or other duly authorized official)

Office of Register of Deeds, County of Oneida I hereby certify that the within instrument was filed in this office for record on the 17th day of November 1975 at 10:00 o'clock A.M.

*Doris Verage Tucker* (Register of Deeds)

By: Deputy