

CERTIFIED LAND CORNER RESTORATION

Index No. W-4

State of Wisconsin

County of Oneida } ss.

History of original corner establishment:
No evidence of any previous corner.

I Glen Barker, do hereby certify that on the 14th day of June, 1984, I found ~~re-established~~ the SE 1/16 corner of Section 30, Township 36, North, Range 10 East, Fourth Principal Meridian, as described hereon; and that from this evidence I established a new monument and accessories as described hereon to perpetuate the original location of this corner.

Description of corner evidence found:
Corner established by subdivision of the SE 1/4.
Corner sets 1356.79' of EC 1/16 and 1257.56' of SC 1/16.

Resident witnesses:
N. Spiess
H. Wagoner

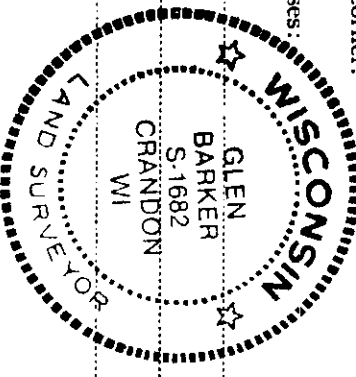

Description of monument and accessories I established to perpetuate the original location of this corner.
Set a 1" iron pipe with 2" diameter alloy cap, stamped:
Monument projects 18" above ground.

Marked NBTs:
White Pine 10" N88W 8.0 ft. S1682
White Birch 8" S57E 6.55 ft. T37N R10E
scribed 1/16 B.T. SE 1/16 S 1/30
CPI - 1984

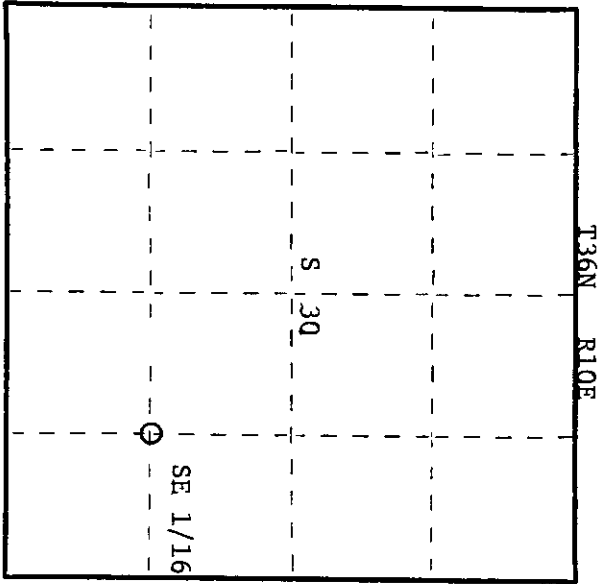

○ = Corner monument restored.

Dated at Rhineland, Wis., this 7th day of August, 1984.

Signature Glen Barker Title Registered Land Surveyor Registration No. S1682
(County Surveyor, Registered Land Surveyor or other duly authorized official)

Office of Register of Deeds, County of Oneida I hereby certify that the within instrument was filed in this office for record on the 10th day of December, 1984 at 1:30 o'clock P. M.

Doris George Kuehn
(Register of Deeds)

By: _____ Deputy

3610301010