

CERTIFIED LAND CORNER RESTORATION

Index No. 75

State of Wisconsin

County of Oneida } ss.

I Phillip T. Hansen, do hereby certify that on the 11th day of September, 1975, I found evidence of the Quarter corner of Section 29, Township 36 North, Range 10E, Fourth Principal Meridian, as described hereon; and that from this evidence I established a new monument and accessories as described hereon to perpetuate the original location of this corner.

Resident witnesses:

Glen Barker

Jim Claflin

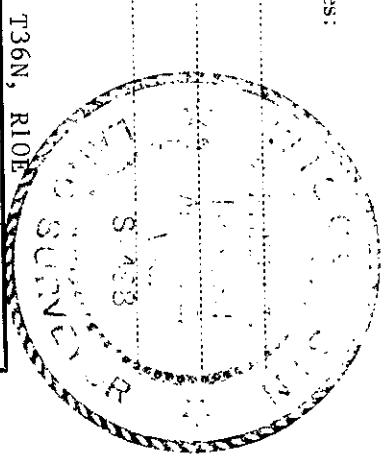

T36N, R10E

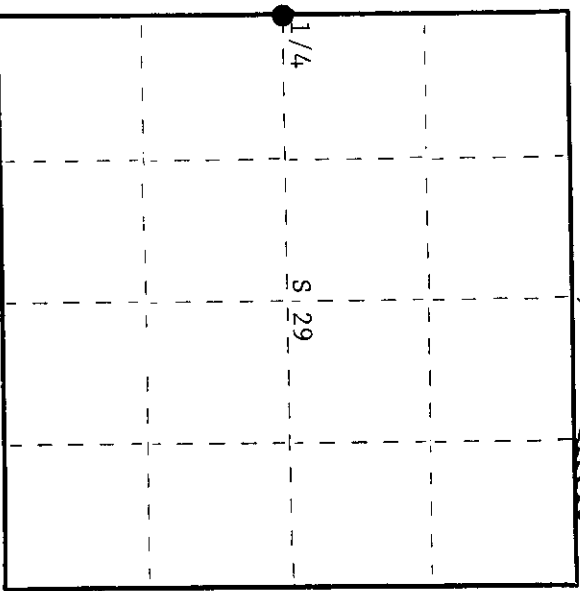

O = Corner monument restored.

History of original corner establishment:

Original corner established by Wm. E. Dougherty, Gov. Deputy Surveyor, in 1863 from which spruce 8" bears N58°E 17 links and tamarack 8" bears S9°W 7 links. Corner recovered and restored by H.C. Lawrence, Registered Land Surveyor, in 1947 during his retracement survey. Recovered original tamarack BT with marks okay and point of original post in the muck. Set new post in old post hole and marked NBT's: Cedar 12" N40°W 41-1/2 links and cedar 7" S53°W 30 links. Found an iron pipe and another old stake N9°E 11 links from tamarack BT which is in error.

Description of corner evidence found:

Recovered 6" cedar post, squared and scribed 1/4S S29, 1/4S S30 in fair condition. Also recovered an iron pipe N10°E 63 links - origin unknown. Recovered OBT. Original tamarack 8" S9W (S4W) 7 links. Now a decayed stump. Scribe marks no longer visible; however, the marks of old BT blaze were found. Recovered cedar 7" (8") S53°E 30 links. Scribed 1/4S NBT. Cedar 12" N40°W (N36°W) 41.5 links (42.5 links). This tree is now leaning which accounts for the difference in measurements.

Description of monument and accessories I established to perpetuate the original location of this corner.

Replaced Lawrence's 6" cedar post with 2-1/2" aluminum pipe with cast alloy cap stamped - NBT cedar 8" N2°E 28.6 links scribed 1/4 BT. Removed 2-1/2" iron pipe and old wood post which were not in the proper position.

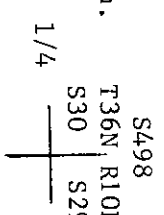

CPI-1975

Dated at Rhineland, Wis., this 22nd day of September, 1975.

Signature: Phillip T. Hansen, Title: Registered Land Surveyor, Registration No. S-498

Office of Register of Deeds, County of Oneida. Instrument was filed in this office for record on the 17th day of September, 1975 at 10:00 o'clock A.M.

Signature: George Buchheit, (Register of Deeds)

By: Deputy