

CERTIFIED LAND CORNER RESTORATION

Index No. **A-8**

State of Wisconsin } ss.
County of Oneida

I Phillip T. Hansen, do hereby certify that on the 27th day of June, 1977, I found evidence of the E 1/16 corner of Section 32 & 5 Township 36 - 35, North, Range 10 East, Fourth Principal Meridian, as described hereon; and that from this evidence I established a new monument and accessories as described hereon to perpetuate the original location of this corner.

Resident witnesses:
Glen Barker
Jim Clafin
Herb Wagoner

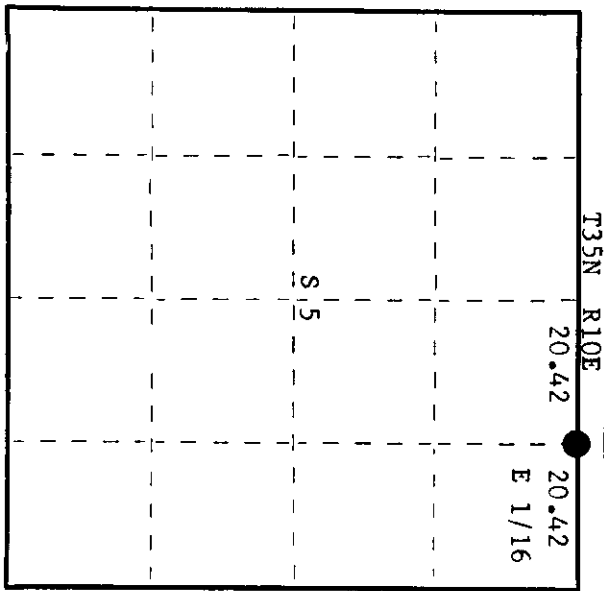
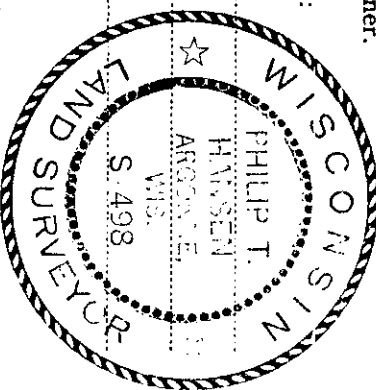

○ = Corner monument restored.

History of original corner establishment:
Corner established by N. Loftus, Ripco Surveyor, in 1956. Ran random line bearing S89° 30' E a distance of 40.84 chains to close out 39 links south of Section Corner 32, 33, 4 & 5. Corrected bearing and set E 1/16 at 20.42 chains intermediate.
Marked NBTs - White Spruce 9" N10°W, 31 links
Maple 8" N79°E, 19-3/4 links
Maple 8" S40°E, 13 1/2 links

Description of corner evidence found:
Recovered 1 1/2" iron pipe with 8" brass cap, stamped:
Monument projects 2 1/2 feet above ground.
Recovered OBTs - White Spruce 14" N10°W, 31 links. E 1/16 S132
Maple 10" N79°E, 19-3/4 links, scribed E 1/16 S32 BT. S15
Maple 10" S40°E, 13.5 links, scribing grown over. RIPCO
White Spruce 12" N74°W, 31.6 links.

Description of monument and accessories I established to perpetuate the original location of this corner.
Monument left in place as recovered.
No additional accessories established.

Dated at Rhineland, Wis., this 30th day of June, 1977.

Signature: *Phillip T. Hansen* Title: Registered Land Surveyor Registration No. S-498
(County Surveyor, Registered Land Surveyor, or other duly authorized official)
Office of Register of Deeds, County of Oneida, 8:00 day of July, 1977.
I hereby certify that the within instrument was filed in this office for record on the 1st day of July, 1977, at 1:30 o'clock P.M.

By: *David George Kuehn* (Register of Deeds)
Joseph M. Bremer Deputy

3610320010