

CERTIFIED LAND CORNER RESTORATION

Index No. W-14

State of Wisconsin } ss.
County of Oneida

I Phillip T. Hansen, do hereby
certify that on the 11th day
of July, 19 77, I found
evidence of the NW 1/16
corner of Section 34
Township 36, North, Range
10 East, Fourth Principal Meridian,

as described hereon; and that from this evidence
I established a new monument and accessories
as described hereon to perpetuate the original
location of this corner.

Resident witnesses.

Glen Barker

Jim Claffin

Herb Wagoner

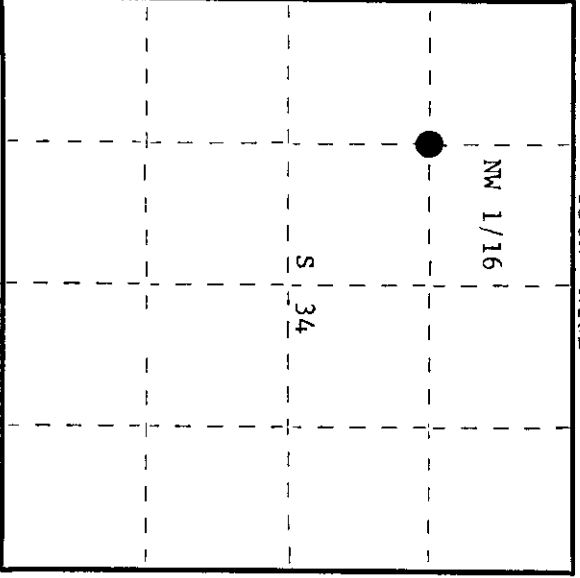
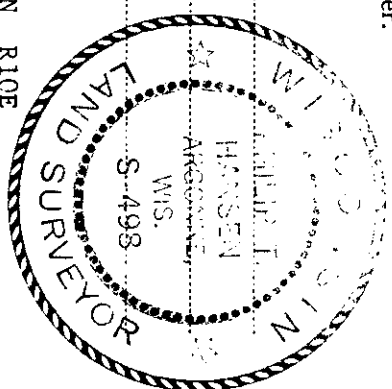

○ = Corner monument restored.

History of original corner establishment:

Corner established by D.H. Vaughan, County Surveyor, in 1905. Marked Hemlock 12" N83°E, 37 links, and Yellow Pine 24" S58°W, 29 links. Corner recovered by H.C. Lawrence, Registered Land Surveyor, in 1954. Recovered Vaughan's Hemlock BT, a rotted stump and Yellow Pine stump, S58°W, 29 links. Set new post and marked NBT - Hemlock 10" S6°E, 27 links.

Description of corner evidence found:

No evidence of Lawrence's post or Vaughan's OBTs.
Recovered Lawrence's OBT - Hemlock 10" (12") S6°E, 27 links, top blaze scribed NW 1/16, bottom blaze grown over.

Description of monument and accessories I established to perpetuate the original location of this corner.

Set 1 1/2" iron pipe with 2" brass cap, stamped:
Monument projects 18" above ground.
Marked NBT - Cedar 12" S89°E, 39.9 links, scribed 1/16 BT.

S498
T36N R10E
NW 1/16 S 34
CPI-1977

Dated at Rhinelander, Wis., this 12th day of July, 19 77.

Signature Phillip T. Hansen Title Registered Land Surveyor Registration No. S-498
(County Surveyor, Registered Land Surveyor, or other duly authorized official)

Office of Register of Deeds, County of Oneida
Instrument was filed in this office for record on the 5th day of August, 19 77
at 9:00 o'clock A. M.

Boris Terage Kuehn
(Register of Deeds)

By Boris Terage Kuehn Deputy

3610343030