

CERTIFIED LAND CORNER RESTORATION

Index No. W-21

State of Wisconsin }
 County of Oneida } ss.

I Phillip T. Hansen, do hereby certify that on the 11th day of November, 1975, I found evidence of the N-1/16 corner of Sections 35 and 36 Township 36 North, Range 10 East, Fourth Principal Meridian, as described hereon; and that from this evidence I established a new monument and accessories as described hereon to perpetuate the original location of this corner.

Resident witnesses:
 Glen Barker
 Jim Claflin

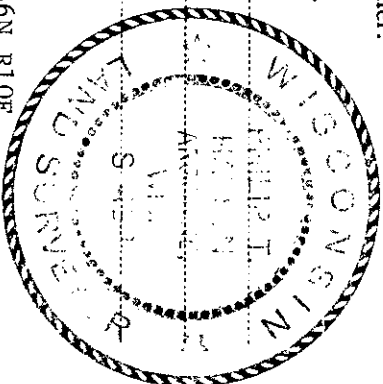

History of original corner establishment:
 Corner established by H.C. Lawrence, Registered Land Surveyor. He ran south from established Section Corners 25, 26, 36, and 35 along an old fence line and at 41.36 recovered D.H. Vaughan's 1/4 corner, set by him in 1905. Lawrence set his N-1/16 corner at 20.68 chains, intermediate. Marked N.P. 18", N70°E, 108 links. His corner post is 11 links north of the fence corner.

Description of corner evidence found:
 Recovered 4" cedar post, squared and scribed N-1/16 S35 N-1/16 S36, in poor condition. This sits in a fence line, 11 links north of fence corner, fence runs west.
 Recovered OBT - N. Pine 18"(22") N70°E 108 links (104 links) - scribed N-1/16 S36 BT.

Description of monument and accessories I established to perpetuate the original location of this corner.
 Replaced 4" cedar post with 1" OD iron pipe with 2" brass cap stamped - S498
 Pipe projects 18" above ground. T36N R10E
 NBT - Red Pine 8" N23°E 42 links - scribed 1/16 BT
 Pipe and BT's painted blue.

N-1/16 S35 | S36
 CPT - 1975

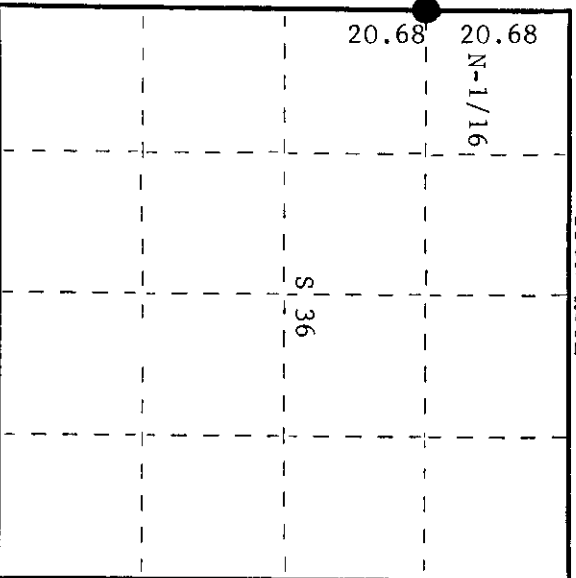

○ = Corner monument restored.

3610 35 3000

Dated at Rhinelander, Wis., this 18th day of November, 1975.

Signature: Phillip T. Hansen Title: Registered Land Surveyor Registration No. S-498
 (County Surveyor, Registered Land Surveyor, or other duly authorized official)

Office of Register of Deeds, County of Oneida
 Instrument was filed in this office for record on the 4th day of February, 1977, at 2:00 o'clock P.M.
 I hereby certify that the within

Terrie Virginia Kuehn
 (Register of Deeds)

By: _____ Deputy