

CERTIFIED LAND CORNER RESTORATION

Index No. **A-22**

State of Wisconsin

County of Oneida } ss.

I Phillip T. Hansen, do hereby certify that on the 13th day of May, 1976, I found evidence of the N 1/16 corner of section 1 and 36 Township 35 and 36, North, Range 10 East, Fourth Principal Meridian, as described hereon; and that from this evidence I established a new monument and accessories as described hereon to perpetuate the original location of this corner.

Resident witnesses:  
Glen Barker  
Jim Claflin  
Herb Wagoner

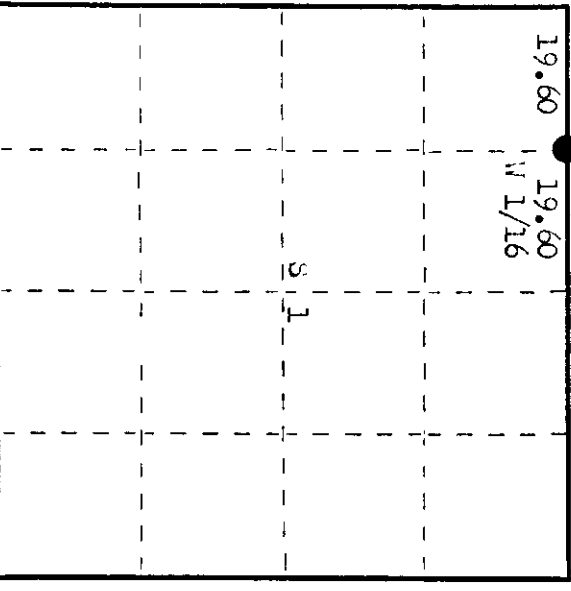
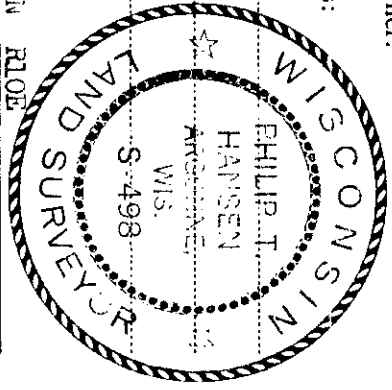

○ = Corner monument restored.

History of original corner establishment: Corner established by H.O. Lawrence, registered Land Surveyor, in 1949. He ran a random line east mag. a distance of 39.20 chains, to a point 38 lks south of an iron pipe. Recovered stump of original pine 10". set N 1/16 corner at 19.60 lks, equidistant 19 lks north. Marked NBT Cedar 10" S 50° W 13 1/2 lks.

Description of corner evidence found: Recovered 4" cedar post, squared and scribed N 1/16 SL, W 1/16 S36 in poor condition. Recovered cedar 10" (12") S 50° W (S 59° W) 13.5 lks, scribed SL, W 1/16 BT.

Description of monument and accessories I established to perpetuate the original location of this corner. Replaced 4" cedar post with 1 1/2" iron pipe with 2" brass cap stamped. Drove support stakes around base of pipe. NBTs - Cedar 6" N 33° W 52.7 lks, scribed 1/16 BT. Monument and BTs painted blue.

S 498  
T36N R10E  
N 1/16 S 1  
T35N R10E  
CPL-1976

Dated at Rhinelander, Wis., this 3rd day of August, 1976.

Signature *Phillip T. Hansen* Title Registered Land Surveyor Registration No. S-498  
(County Surveyor, Registered Land Surveyor, or other duly authorized official)

Office of Register of Deeds, County of Oneida. I hereby certify that the within instrument was filed in this office for record on the 23rd day of September, 1976, at 1:00 o'clock P.M.

*George F. Hansen*  
(Register of Deeds)

By \_\_\_\_\_ Deputy

3610360030