

CERTIFIED LAND CORNER RESTORATION

Index No. **E-22**

State of Wisconsin }
 County of Oneida } ss.

I Philip T. Hansen, do hereby certify that on the 20th day of December 1974, I found evidence of the W-1/16 corner of S1-S12 Township 36 North, Range 11 East, Fourth Principal Meridian, as described hereon; and that from this evidence I established a new monument and accessories as described hereon to perpetuate the original location of this corner.

Resident witnesses:

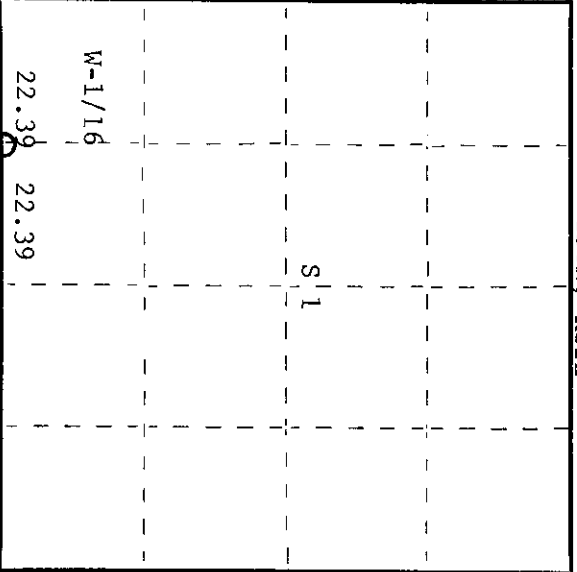
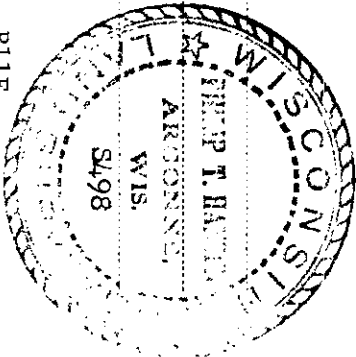

○ = Corner monument restored.

CERTIFIED LAND CORNER RESTORATION

History of original corner establishment:

Original corner set by B.F. Dorr in 1898. Retracement survey made by H.C. Lawrence in 1950. From his notes he started from Dorr's recovered corner, ran N85°E a distance of 44.78 chains at which point he intersects Dorr's 1/4 corner N50°W a distance of 132 lks. Correction to true line 1940' or N83°20'E bearing of true line. He set the W-1/16 Corner equidistant between corners on true line at 22.39 chains. Set new 4" cedar post at this point. No records of BT's recovered or set.

Description of corner evidence found:

Recovered Lawrence's 4" cedar post, squared and scribed S1 W-1/16 S12 W-1/16 in good condition.
 No evidence of BT's.

Description of monument and accessories I established to perpetuate the original location of this corner.

Set 1" x 5' galvanized iron pipe with 2" brass cap stamped as follows -
 New BT's Red maple 5" S690°E 8 lks. scribed 1/16 BT T36N, R11E
 Red maple 7" N84°0W 27½ lks. scribed 1/16 BT

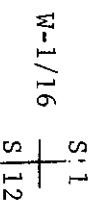

CPI-1974

Dated at Rhinelander, Wis., this 22nd day of January, 1975

Signature: *Philip T. Hansen* Title: Registered Land Surveyor Registration No. S-498
 (County Surveyor, Registered Land Surveyor, or other duly authorized official)

Office of Register of Deeds, County of Oneida, at 300 o'clock M. I hereby certify that the within instrument was filed in this office for record on the 1st day of October, 1975.

By: *Dorrie Verage Kuehn* (Register of Deeds) Deputy

361101880