

CERTIFIED LAND CORNER RESTORATION

Index No. **D-14**

State of Wisconsin

County of Oneida } ss.

I, Philip T. Hansen, do hereby certify that on the 20th day of January, 1975, I found evidence of the SW-1/16 corner of Section 3 Township 11 E, Range 36, North, Range 11 E, Fourth Principal Meridian, as described hereon; and that from this evidence I established a new monument and accessories as described hereon to perpetuate the original location of this corner.

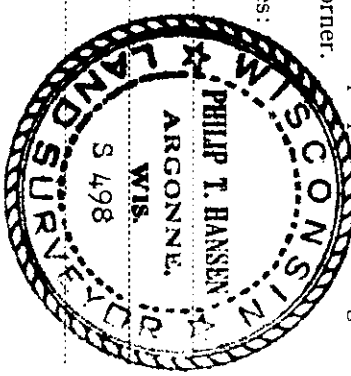

Resident witnesses:

History of original corner establishment:  
Corner established by H.C. Lawrence, Registered Land Surveyor, in 1952.

Set 5" cedar post, squared and scribed SW-1/16 S3, 19.62 chains south of WC-1/16 corner and 20.59 chains west of SC-1/16 corner.

BT's - White ash 7" N54°E 29 links  
Sugar maple 12" N26½W 36 links

Description of corner evidence found:

Recovered 5" cedar post, squared and scribed SW-1/16 S3, SW-1/16 S3 in poor condition. Post had fallen down. Post hole was visible.

Recovered old BT's - Sugar maple 12" N26½W 36 links green scribing grown over  
White ash 7" N54°E 29 links green scribing grown over

Description of monument and accessories I established to perpetuate the original location of this corner.  
Replaced wooden stake with 1-1/4"OD x 5' galvanized iron pipe stamped -

No new bearing trees established.

SW-1/16 S3  
T36N R11E  
CPT-1975

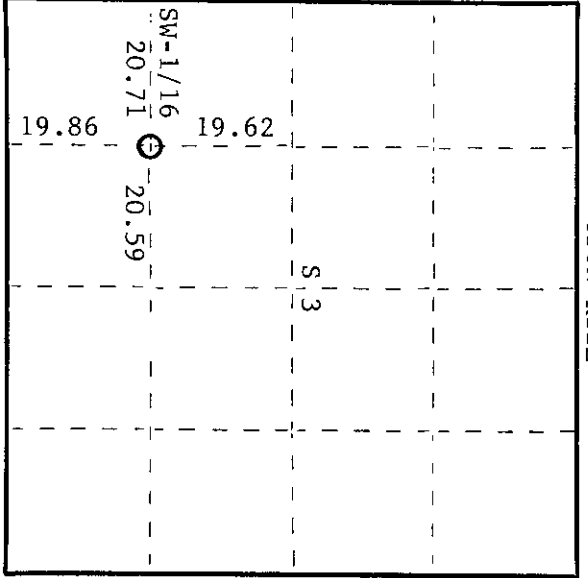

○ = Corner monument restored.

Dated at Rhinelander, Wis., this 10th day of June, 1975.

Signature *Philip T. Hansen* Title Registered Land Surveyor Registration No. S-498  
(County Surveyor, Registered Land Surveyor, or other duly authorized official)

Office of Register of Deeds, County of Oneida, at 300 o'clock M. I hereby certify that the within instrument was filed in this office for record on the 1st day of October, 1975.

*Doris Savage Tuelke*  
(Register of Deeds)

By Deputy

0301301198