

CERTIFIED LAND CORNER RESTORATION

Index No. C-14

State of Wisconsin

County of Oneida } ss.

I, Philip T. Hansen, do hereby certify that on the 28th day of January, 1975, I found evidence of the WC-1/16 corner of Section 3 Township 36 North, Range 11 E, Fourth Principal Meridian, as described hereon; and that from this evidence I established a new monument and accessories as described hereon to perpetuate the original location of this corner.

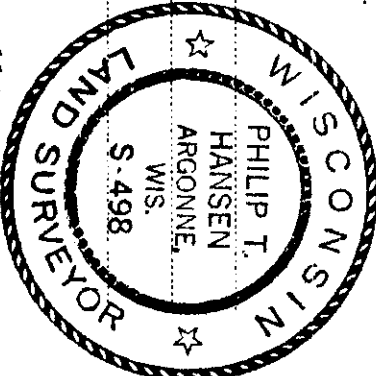

Resident witnesses:

History of original corner establishment:
 Corner established by H.C. Lawrence, Registered Land Surveyor, during his retracement and subdivision survey in 1952. Ran a random line from the 1/4 line between Sec. 3 and 4 east to intersect his N-S line between Sections 2 and 3, 30 links south of established 1/4 corner. Established C-1/4 corner 32.56 chains south of N-1/4 corner and 41.82 chains east of West 1/4 corner. Set 5" cedar post, equidistant between W-1/4 and C-1/4 corners of 20.91 chains and 7 links north of random line.

BT's - Twin maple 4" S55°E 33-1/2 links
 Cedar 10" S25°W 40-1/2 links

Recovered 5" cedar post, squared and scribed WC-1/16 S3 in very good condition.

Recovered, Red maple 4" (twin) S55°E 33-1/2 links scribed S3 BT
 Cedar 10" S25°W 40-1/2 links scribed WC-1/16 BT

Description of monument and accessories I established to perpetuate the original location of this corner.

Replaced wooden post with 1-1/4"OD x 5' galvanized iron pipe with 2" brass cap stamped - S498 T36N R11E

No new BT's.

WC-1/16 ~~S3~~
 CPI-1975

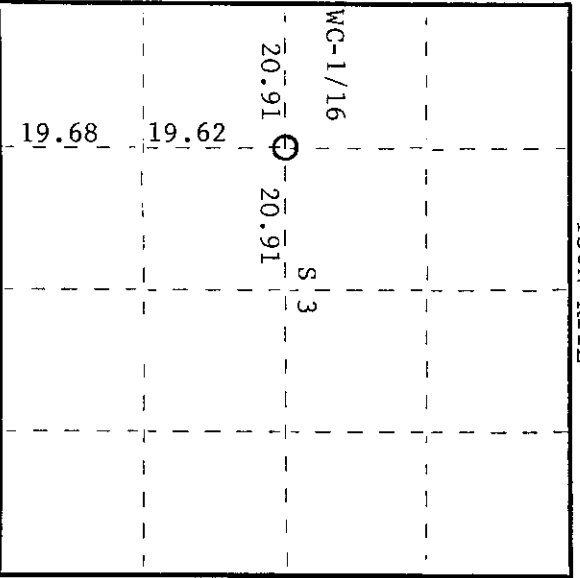

○ = Corner monument restored.

361103 2030

Dated at Rhineland, Wis., this 22 day of May, 1975

Signature *Philip T. Hansen* Title Registered Land Surveyor Registration No. S-498
 (County Surveyor, Registered Land Surveyor, or other duly authorized official)

Office of Register of Deeds, County of Oneida, On.aida, I hereby certify that the within instrument was filed in this office for record on the 1st day of October, 1975 at 3:00 o'clock P.M.

Lorne Verage Tuckner
 (Register of Deeds)

By: Deputy