

CERTIFIED LAND CORNER RESTORATION

Index No. C-6

State of Wisconsin

County of Oneida } ss.

I, Phillip T. Hansen, do hereby certify that on the 10th day of January, 19 79, I found evidence of the WC 1/16 corner of Section 5 Township 36, North, Range 11 East, Fourth Principal Meridian, as described hereon; and that from this evidence I established a new monument and accessories as described hereon to perpetuate the original location of this corner.

Resident witnesses:

Jim Claflin
Glen Barker
Herb Wagoner

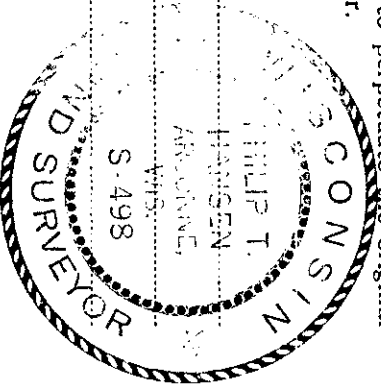

History of original corner establishment:
Corner established by N. Loftus, Ripco surveyor, in 1962. Ran random line east from previously recovered W 1/4 corner 84.4075 chains to close out 1.57 chains north of E 1/4. Set C 1/4 corner at 41.92 chains 79.95 chains south.
Set WC 1/16 at 20.96 chains intermediate.
Marked Aspen 4" N12°E 24 links and W. Spruce 2" N44°W 80 links.

Description of corner evidence found:
Unable to recover Ripco's corner.
Recovered OBT's -
Aspen 4" N12°E 24 links, now a dead snag, scribed 1/16 BT.
W. Spruce 2" (6") N44°W (N40°W) 80.0 links, scribing grown over.

Description of monument and accessories I established to perpetuate the original location of this corner.
From calls to recovered BT's, set a 1" iron pipe with 2" brass cap, stamped:
Monument projects 2 1/2' above ground.
Marked NBT - W. Spruce 7" N22°E 62.8 links, scribed 1/16 BT.

S-498
T36N R11E
WC 1/16 S 4-5
CPI-1979

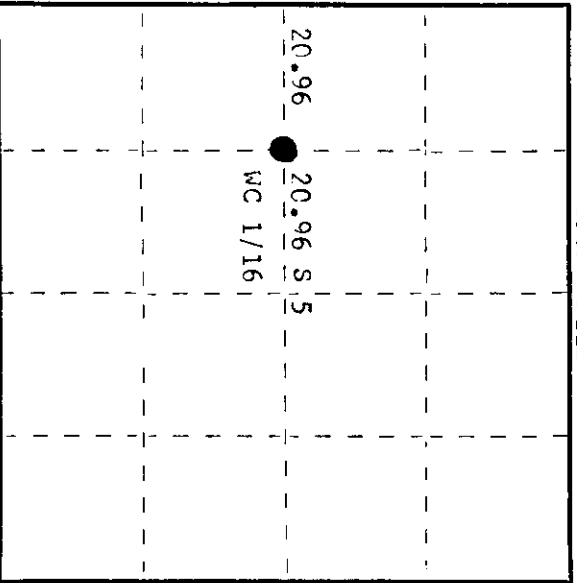

○ = Corner monument restored.

Dated at Rhinelander, Wis. this 18th day of January, 19 79

Signature Phillip T. Hansen Title Registered Land Surveyor Registration No. S-498
(County Surveyor, Registered Land Surveyor, or other duly authorized official)

Office of Register of Deeds, County of Oneida
Instrument was filed in this office for record on the 31st day of January, 19 79
at 2:30 o'clock P. M.

Debra Wagoner Keeler
(Register of Deeds)

By Phillip T. Hansen Deputy

3611052030