

CERTIFIED LAND CORNER RESTORATION

Index No. **J-7**

State of Wisconsin } ss.
 County of Oneida

I Philip T. Hansen, do hereby certify that on the 7th day of January, 1975, I found evidence of the corner of Section 1/4, Township 36 North, Range 11 East, Fourth Principal Meridian, as described hereon; and that from this evidence I established a new monument and accessories as described hereon to perpetuate the original location of this corner.

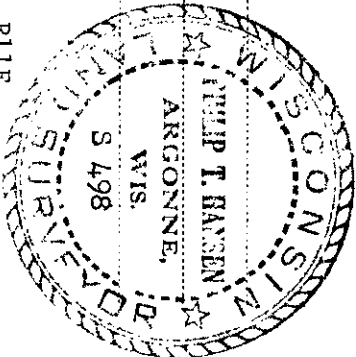

Resident witnesses:

History of original corner establishment:

Original corner established by Wm. E. Dougherty, Gov. Deputy Surveyor. BT's. Birch 8" N10°W 29 lks.; Maple 10" S36E 10 lks. Recovered by B.F. Dorr in 1888, County Surveyor. Recovered by D.H. Vaughan, County Surveyor, in 1905. Vaughan stated that he found B.F. Dorr's corner and BT's down. Set new post and made new BT's - cedar 8" N 17-1/2 W 28 lks. Vaughan's corner and his BT recovered by H.C. Lawrence, Reg. Land Surveyor, in 1950. Evidence of Dorr's BT's were also recovered. He set a new 5" cedar post in the old hole, surrounded it with rock carron at base and made new BT. Cedar 10" S56E 49 lks.

Description of corner evidence found:

Recovered a 4" cedar post, with rocks at base, squared and scribed S8-1/4S; S17 1/4S in poor condition.
 Recovered old BT hemlock 13" S10°W 56 lks. Scribbling grown over, not mentioned on any recovery notes.

Description of monument and accessories I established to perpetuate the original location of this corner.

Replaced old stake with new 2-1/2" x 5' galvanized iron pipe with brass cap stamped -
 New BT's. Sugar maple 7" S46°E 25 lks. Scribed 1/4 BT S498
 Sugar maple 8" N72W 25-1/2 lks. T36N, R11E

S 8
 1/4-
 S 17

CPI-1975

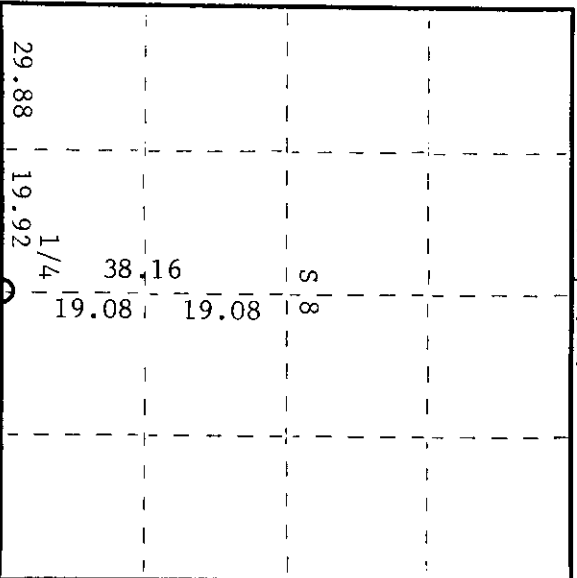

○ = Corner monument restored.

Dated at Rhineland, Wis., this 16th day of June, 1975

Signature *Philip T. Hansen* Title Registered Land Surveyor Registration No. S-498
 (County Surveyor, Registered Land Surveyor, or other duly authorized official)

Office of Register of Deeds, County of Oneida. I hereby certify that the within instrument was filed in this office for record on the 1st day of October, 1975 at 3:00 o'clock P.M.

Toni Savage Kuehn
 Register of Deeds

By: Deputy

3611080020